

529-543 Hennessy Road &
524-540 Lockhart Road

軒尼詩道529 - 543號 及 駱克道524-540號

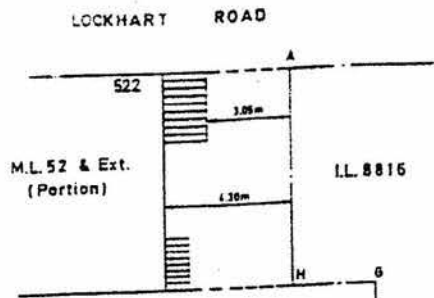

sd.
(Darwin CHEN)
Director of Buildings
and Lands

Diagram 'A' (NOT TO SCALE)

SIDE	DISTANCE IN METRES	BEARING	Pt.	CORNER MARKED BY
A B	41.62	87 43 10		
B C	19.66	177 44 10		
C D	0.66	87 39 00		
D E	16.78	177 35 30		
E F	39.62	267 38 10		
F G	19.82	357 35 30		
G H	2.65	287 39 00		
H A	16.67	357 44 10		

 Area at Ground Floor dedicated to the public for the purpose of passage (shown coloured pink cross-hatched black)

A. Hennessy Road 1.60m x 39.62m = 63.392m²

B. Lockhart Road 0.5m x 41.62m = 20.810m²

Total Dedicated Area = 84.202m²

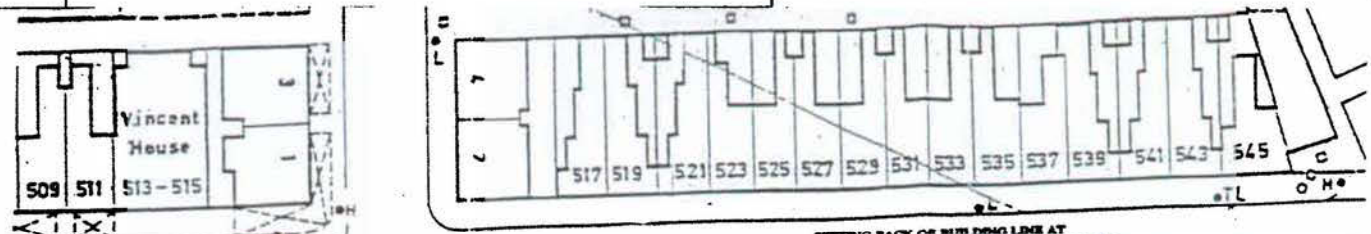

Lockhart Road
駱克道

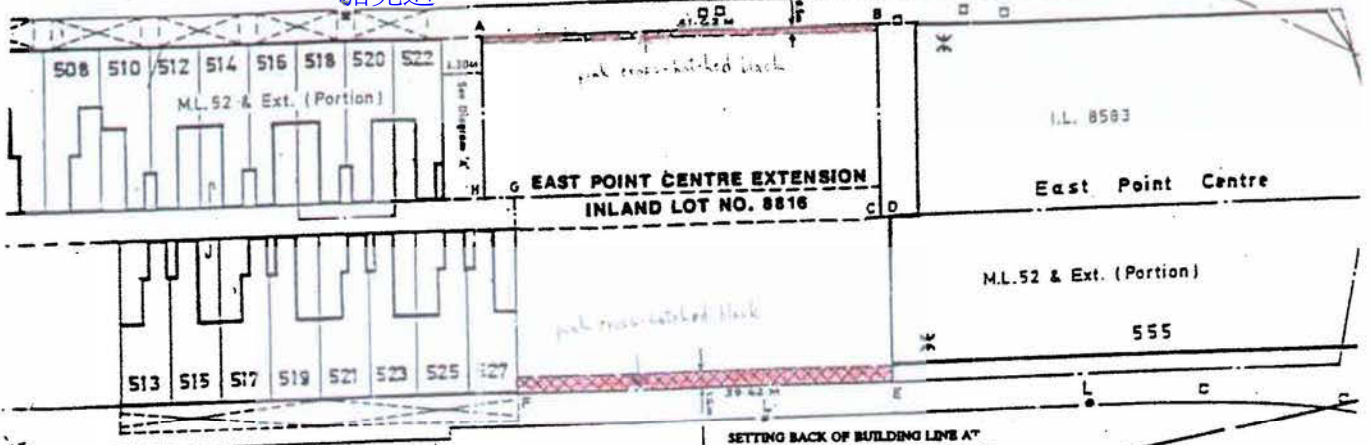

Hennessy Road
軒尼詩道

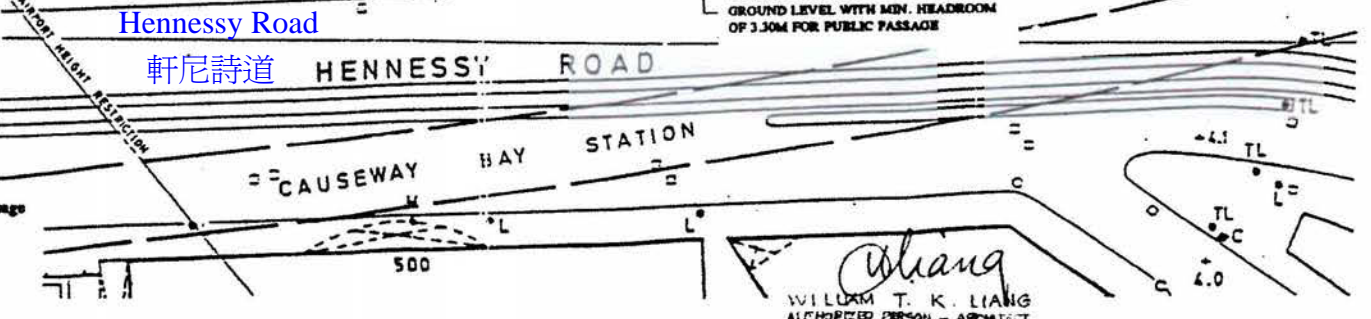

SCALE 1:500

Annexure to Memorial No. 5590950

William T. K. Liang
WILLIAM T. K. LIANG
AUTHORIZED PERSON - ARCHITECT
for and on behalf of
LIANG PEDDLE THORP
Architects & Planners Ltd.

**PLAN FOR DEED OF DEDICATION FOR PUBLIC PASSAGE
UNDER BUILDING (PLANNING) REGULATION 22 (1)
EAST POINT CENTRE EXTENSION
INLAND LOT NO. 8816**

SIGNED and SEALED for and on
behalf of Eastlord Development
Limited



UBM5590950 (1/1)

LIANG PEDDLE THORP
Architects and Planners Ltd
21st Floor Beverly House 93-107 Lockhart Road Wanchai Hong Kong
Fax 529 6499 Telephone 861 1728

梁柏濤
建築師