

14-22 Pedder Street & 18D Des Voeux Road Central, Hong Kong
 香港中環畢打街 14-22 號 及 德輔道中 18D 號
 Wheelock House 會德豐大廈

Tak Shing House 德成大廈

AREA DEDICATED TO PUBLIC FOR PASSAGE

$$\frac{1}{2} (150 + 1872) \times 28.67 = 48.338 \text{ m}^2$$

TOTAL = 48.338 m²

Pedder Building
 畢打行

PEDDER BUILDING

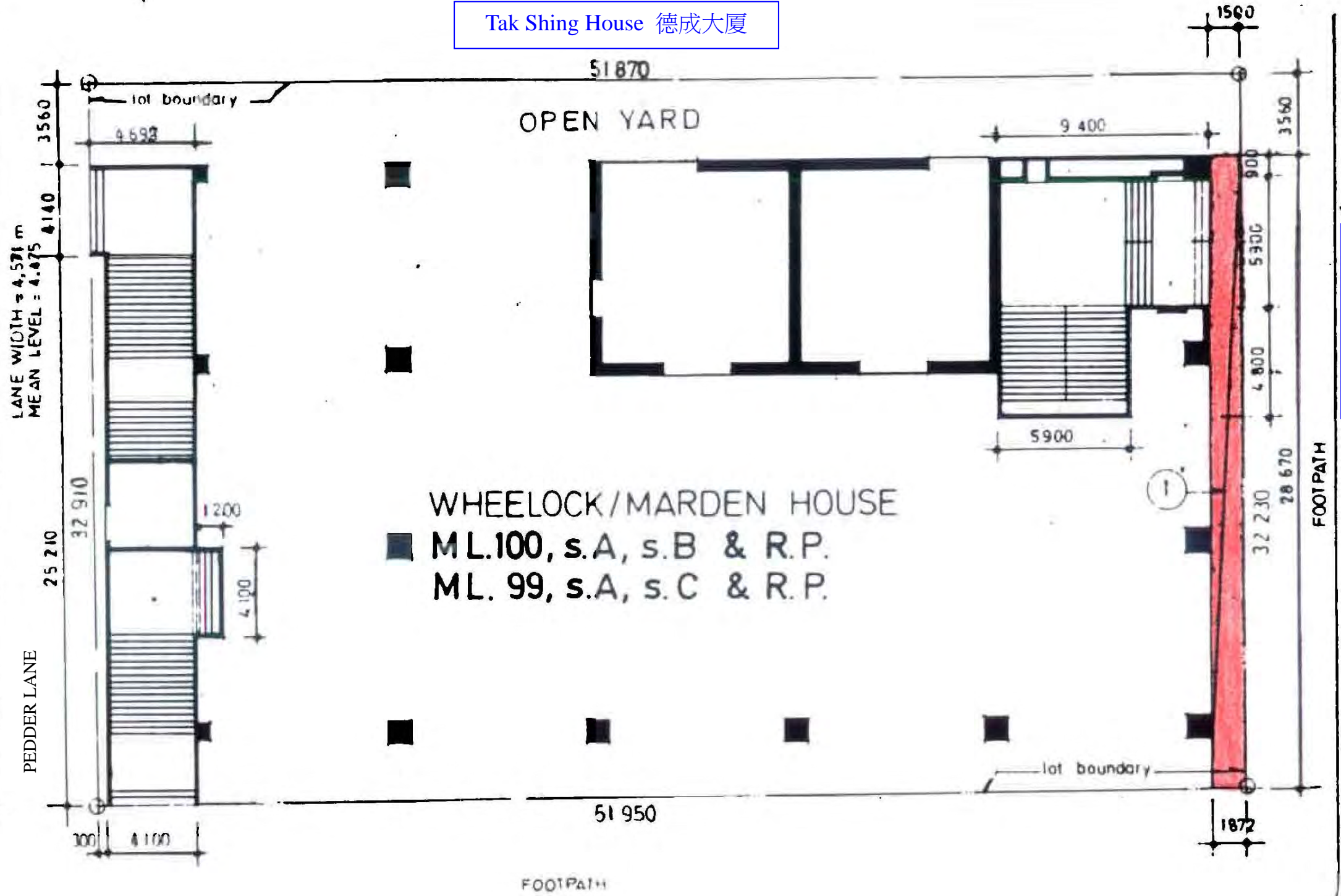

Pedder Street 畢打街

STREET WIDTH = 22.86 m
 MEAN LEVEL = 4.265

GROUND FLOOR PLAN

1:300

DRAWING NO.
 DD-3

msk
 16/7/84