

PROPOSED RESIDENTIAL & COMMERCIAL DEVELOPMENT
 AT 152-160 KWOK SHUI ROAD, TSUEN WAN, N.T. LOT NO. - TWTL 410

B.L.D. REF BD 2/9036/03
 F.S.D. REF FP B/4130 II
 REVISIONS
 NUMBER DESCRIPTION DATE

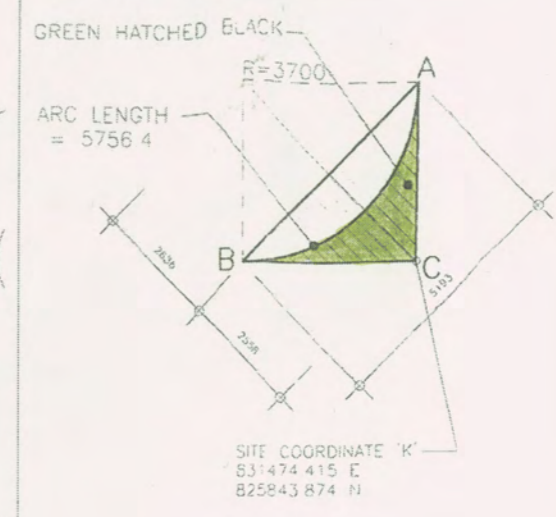

DEDICATED AREA CALCULATION:



LEGEND:

GREEN HATCHED BLACK (DEDICATED AREA)

AREA OF TRIANGLE ABC:
 $= 5.193 \times 2.558 \times 0.5$
 $= 6.642 \text{ m}^2$

AREA OF HATCHED CIRCULAR SEGMENT:
 $= (\text{LENGTH OF ARC} \times R \times 0.5)$
 $\quad - (\text{BASE} \times \text{H} \times 0.5)$
 $= (5.756 \times 3.7 \times 0.5)$
 $\quad - (5.193 \times 2.636 \times 0.5)$
 $= 10.649 - 6.844$
 $= 3.805 \text{ m}^2$

THUS, THE DEDICATED AREA:
 $= 6.642 - 3.805$
 $= 2.837 \text{ m}^2$

LOCATION PLAN SCALE: NTS

- (B) BLUE SITE OF PROPOSED RESIDENTIAL & COMMERCIAL DEVELOPMENT AT 152-160 KWOK SHUI ROAD, TSUEN WAN, N.T. SITE AREA = 7300 M²
- GREEN HATCHED BLACK (DEDICATED AREA)

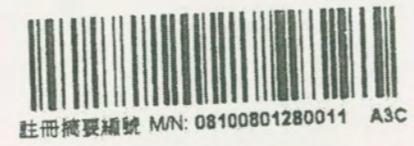

WONG & OUYANG (HK) LTD
 ARCHITECTS AND ENGINEERS HONG KONG
 I HEREBY CERTIFY THE ACCURACY OF THIS PLAN

ARTUR CK Au-Yeung
 BArch HKIA
 AP List 1
 Registered Architect

WONG & OUYANG (HK) LTD ARCHITECTS AND ENGINEERS HONG KONG		
PROJECT PROPOSED RESIDENTIAL & COMMERCIAL DEVELOPMENT AT 152-160 KWOK SHUI ROAD, TSUEN WAN, N.T. (TSUEN WAN TOWN LOT 410)		
DRAWING TITLE SITE LOCATION PLAN FOR DEDICATED AREA AND CALCULATION		
SIGNATURE FOR SUBMISSION/CONSTRUCTION ROBERT PH LAM BArch HKIA AP List 1 Registered Architect		
DRAWN BY	DATE	NOV 07
ENTERED BY	DATE	NOV 07
CHECKED BY	DATE	NOV 07
SCALE	AS SHOWN	PRINT DATE
JOB NUMBER	DRAWING NUMBER	REVISION
2074	DD01	-
DO NOT SCALE OFF DRAWING. THIS DRAWING IS NOT FOR CONSTRUCTION PURPOSES UNLESS EXPRESSLY STATED. ALL RIGHTS RESERVED AND REPRODUCTION IN ANY FORM MUST BE APPROVED BY WONG & OUYANG (HK) LTD.		