

SIDE	DISTANCE IN METRES
AB	8.85
BC	11.30
CD	8.58
DA	11.28

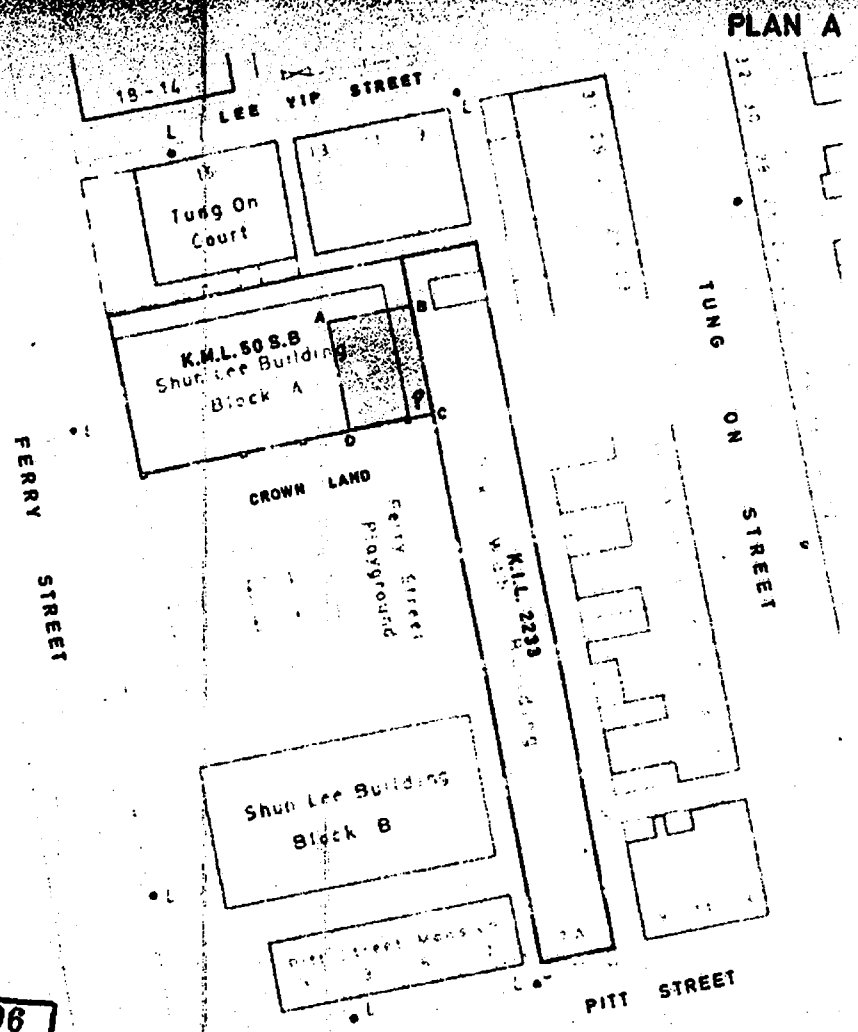

For and on behalf of
Henderson Development Limited
(Sd.) Fung Lee Woon King
(Sd.) Lee King Yee

For and on behalf of the
Government of Hong Kong
by the Director of Building
Development
(Sd.) Chau Chan Son

Annexure to Memorial No. 3331296

COLOURED PINK AREA 97.6 SQUARE METRES (ABOUT)

SCALE 1:500



DISTRICT LANDS OFFICE
KOWLOON WEST
LANDS DEPARTMENT



Ref	Colour
1	BROWN
2	GREEN
3	INDIGO
4	ORANGE
5	PINK
6	RED
7	VIOLET
8	YELLOW
9	GREY

* Prefixes light shades of above.

P-2

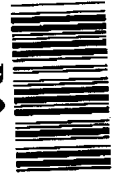

Survey Approved by *[Signature]*
District Land Surveyor
Kowloon District Survey Office
Lands Department

File Ref. No. (112) in LND 820/KLT/64
Survey Sheet No. 11-NW-19D
Layout Plan No. LK2/48
Engineering Drg. No. *[Number]*

THE DEDICATION OF PORTION OF SEC. B OF K.M.L. No. 50
(GROUND FLOOR ONLY)

Date _____



SIDE	DISTANCE IN METRES
AB	8.66
BC	11.38
CD	8.66
DA	11.38

For and on behalf of
Henderson Development Limited
(Sd.) Fung Lee Woon King
(Sd.) Lee King Yue

For and on behalf of the
Government of Hong Kong by
the Director of Building
Development
(Sd.) Chau Cham Son

Annexure to Memorial No. **3331296**

Survey Approved by

Chama

District Land Surveyor
Kowloon District Survey Office
Lands Department

218174

File Ref. No. (112) in LND 820/KLT/64

Survey Sheet No. 11-NW-19D

Layout Plan No. LK2/46

Engineering Drg. No.

PLAN No. K4685b-D2

THE DEDICATION OF PORTION OF K.M.L. No. 50 R.P.
(GROUND FLOOR ONLY)

COLOURED PINK AREA 98.6 SQUARE METRES (ABOUT)

SCALE 1:500

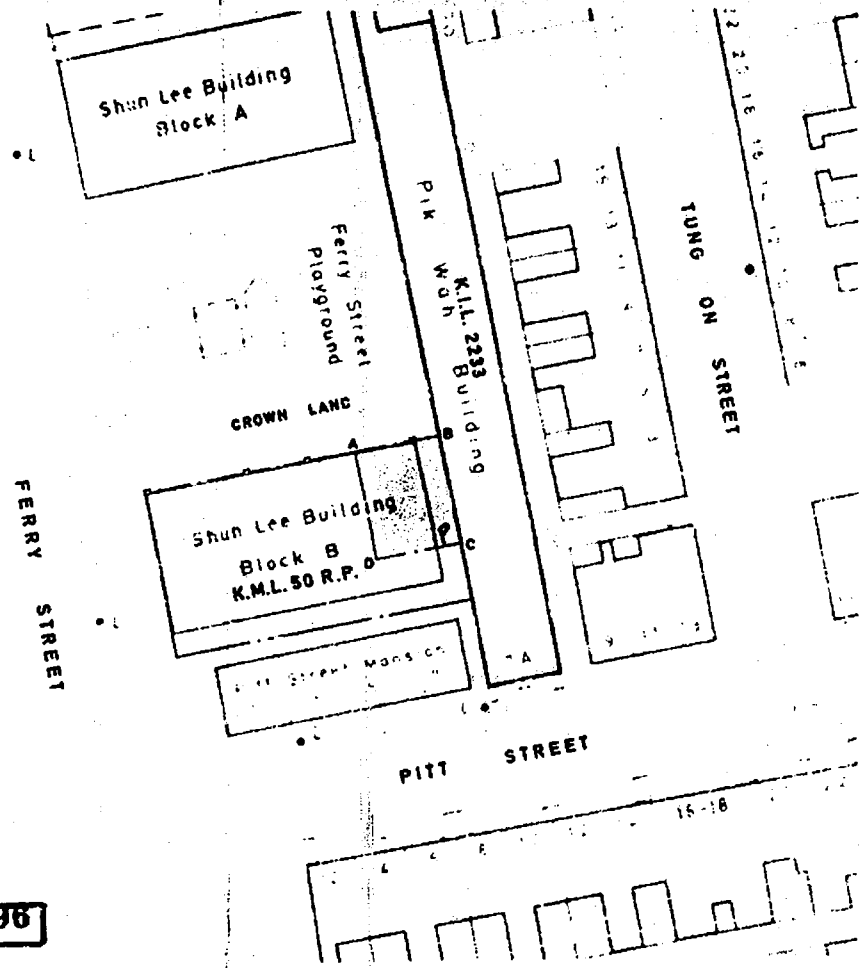
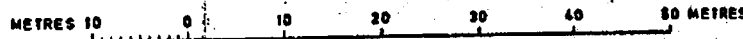

PLAN B

DISTRICT LANDS OFFICE
KOWLOON WEST
LANDS DEPARTMENT



Ref	Colour
1	BROWN
2	GREEN
3	ORANGE
4	PINK
5	RED
6	VIOLET
7	YELLOW
8	GREY

* Prefixes light shades of above



P-2

Date