

AREA COLOURED PINK HATCHED BLACK TO BE DEDICATED TO PUBLIC FOR THE PURPOSE OF PASSAGE WITH A CLEAR HEIGHT 3.5 M.

RECEIVED BY

APR 21 11 43 AM '97  
CANOPY ABOVE AT 1/F

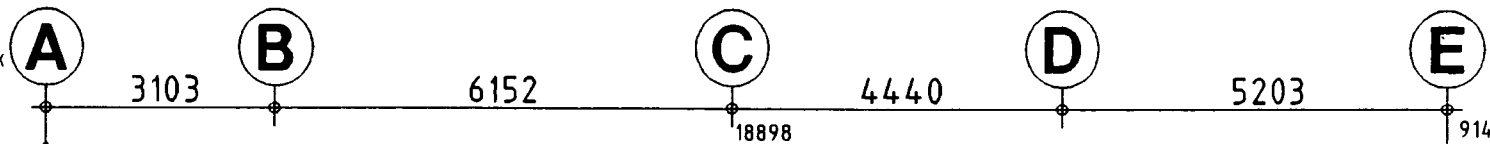

TAI NAN STREET (15m. wide)  
PAVEMENT (3.048m. wide)



R & D DESIGN BUILDINGS DEPARTMENT

B.L. = 19.812 m

YEN CHOW STREET (31m. wide)  
PAVEMENT (3.568m. wide)  
3600

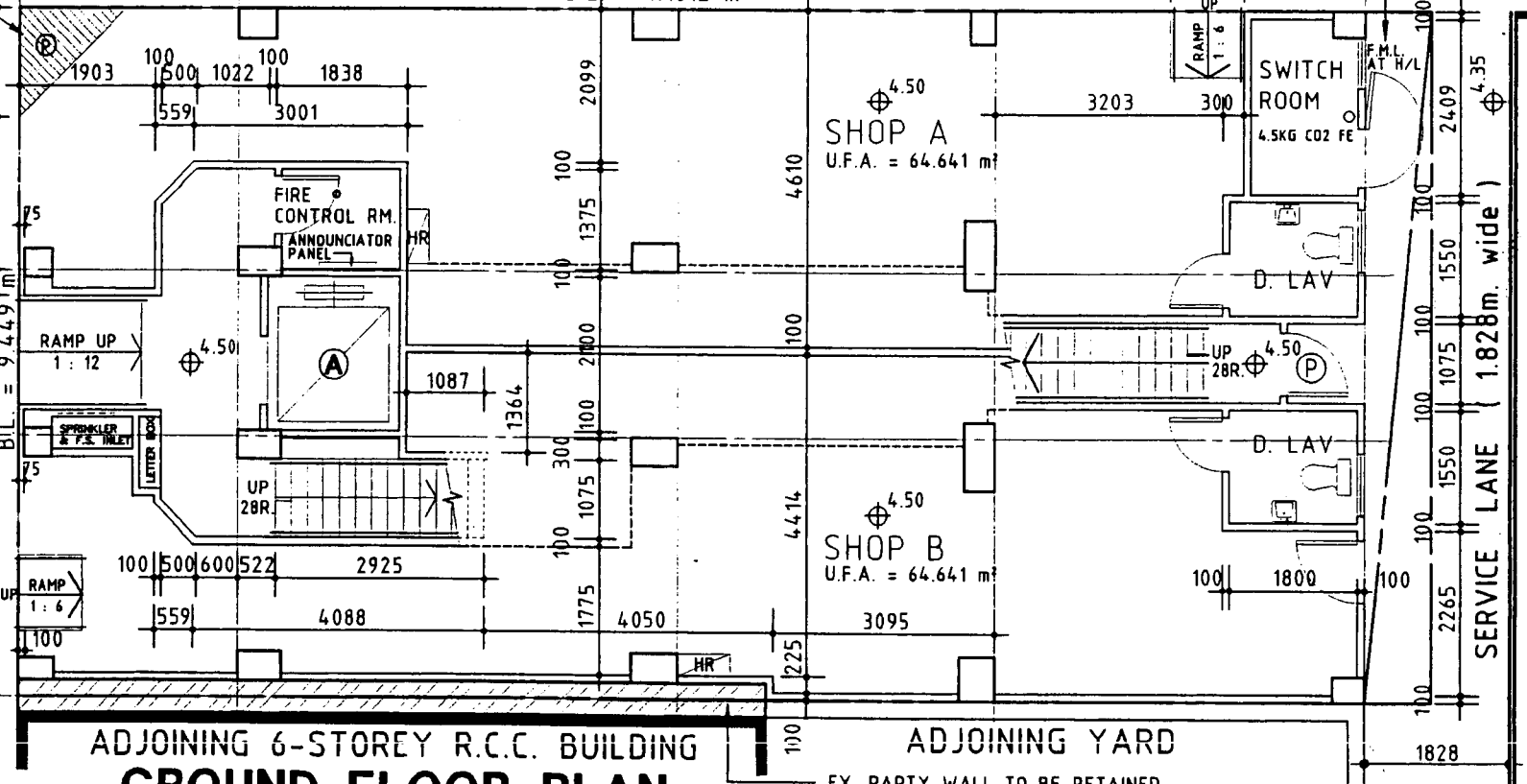

PRIVATE LANE

SERVICE LANE (1.828m. wide)

ADJOINING 6-STOREY R.C.C. BUILDING  
**GROUND FLOOR PLAN**

ADJOINING YARD  
EX. PARTY WALL TO BE RETAINED

21 APR 1997

PROPOSED PROPOSED COMPOSITE BUILDING AT N.K.I.L. 176 S.C R.P. & 176 S.C S.S.1 NO. 56-58 YEN CHOW STREET, SHAMSHUIPO, KOWLOON.	 <b>K.A. KHO &amp; ASSOCIATES</b> <b>ARCHITECTS &amp; CONSULTANTS LTD.</b> 許金安則師樓有限公司 1705 TAI YAU BUILDING, 181 JOHNSTON ROAD, HONG KONG. TEL: (852) 2833-8813 香港灣仔莊士敦道一八一號大有大廈一七〇五室 電話: (八五二) 二八三三六八一三	SCALE	DRAWN	DATE	REVISIONS
		PLAN	REF.	JOB NO.	DWG. NO.
		1 : 100			
		GENERAL		818	01