

PLAN OF
NEW KOWLOON INLAND LOT NO. 176 S.G. S.S. 4

(NO. 396 LAI CHI KOK ROAD)

M 879717

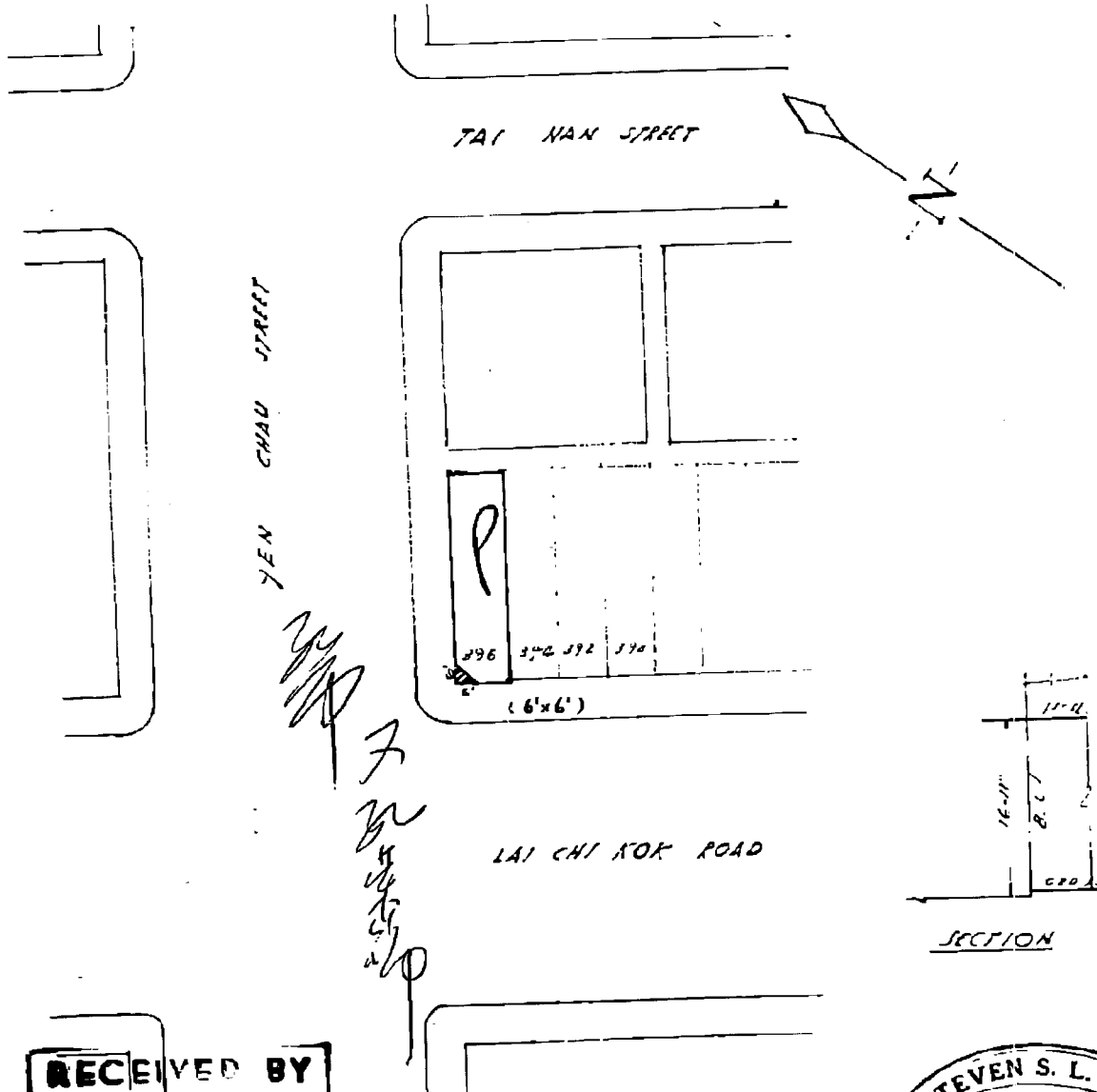

RECEIVED BY
20 OCT 1971
P. W.

STEVEN S. L. YUE
師 築 建 麟 緒 余
ARCHITECT & CIVIL ENGINEER

SCALE 50 FEET TO ONE INCH

FEET 50 100 150