



For and on behalf of the
Government of Hong Kong

Anthony Gordon Eason
the Director of Buildings
and Lands

DEDICATION
PLAN

TOTAL DEDICATED AREA:
= $2.618 \text{ m}^2 + 10.6085 \text{ m}^2$
= 13.2265 m^2

AGREED BY OWNER:

For and on behalf of
SAFER INVESTMENT LIMITED

Authorized Signature(s)

19.8276

23.3276

3.500

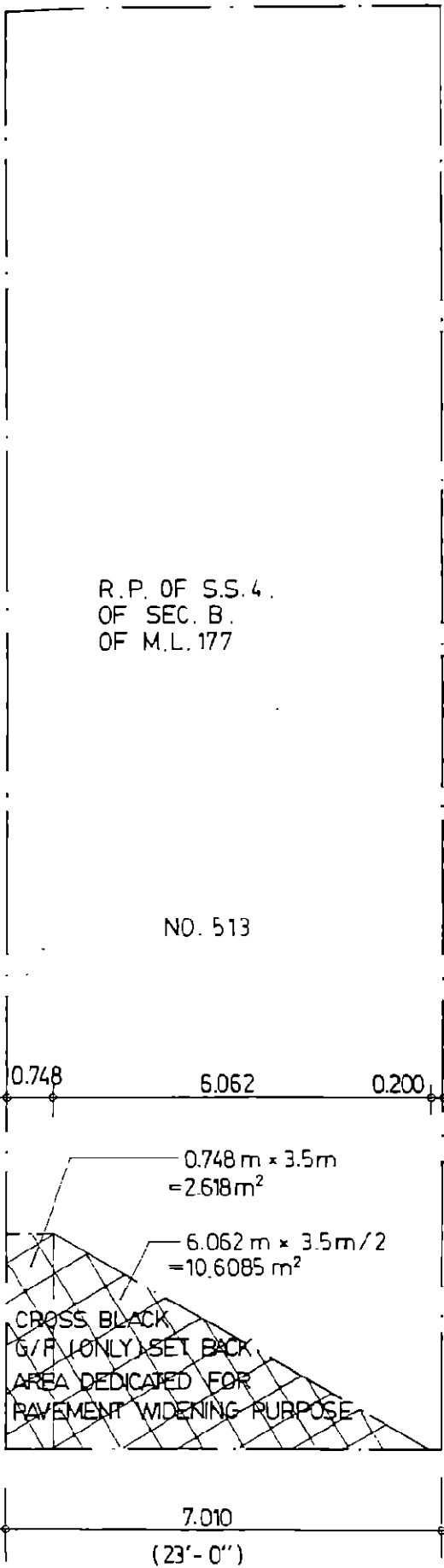

NO. 515

NO. 513

0.748

6.062

0.200

$0.748 \text{ m} \times 3.5 \text{ m}$
 $= 2.618 \text{ m}^2$

$6.062 \text{ m} \times 3.5 \text{ m} / 2$
 $= 10.6085 \text{ m}^2$

CROSS BLACK
G/F (ONLY) SET BACK
AREA DEDICATED FOR
PAVEMENT WIDENING PURPOSE

7.010

(23'-0")

QUEEN'S ROAD WEST NO. 513

Annexure to Memorial No. **5073591**

JOSHUA YUE-PONG CHEUNG
AUTHORISED PERSON (ARCHITECT)

Annexure to Memorial No. **5073591**



R.P. OF SEC. B
OF M.L. 177

For and on behalf of the
Government of Hong Kong

Anthony Gordon Eason
the Director of Buildings and Lands

**DEDICATION
PLAN**

19.8276

23.3276

NO. 517

NO. 515

NO. 513

TOTAL DEDICATED AREA :
= 24.535 m²

7.010
(23'-0")

AGREED BY OWNER :

For and on behalf of
SAFIR INVESTMENT LIMITED

Authorized Signatory(s)

CROSS BLACK
G/F (ONLY) SET BACK
AREA DEDICATED FOR
PAVEMENT WIDENING PURPOSE
3.5 m x 7.010 m = 24.535 m²

3.500

S.S. 6 OF SEC. B
OF M.L. 177

2.648

2.604

7.010

QUEEN'S ROAD WEST NO. 515

JOSHUA YUE-PONG CHEUNG
AUTHORISED PERSON (ARCHITECT) 2



For and on behalf of the
Government of Hong Kong

Anthony Gordon Eason
the Director of Buildings and
Lands

**DEDICATION
PLAN**

R.P. OF S.S.3
OF SEC. B
OF M.L.177

19.8276

23.3276

NO.519

NO.517

NO.515

TOTAL DEDICATED AREA :
= $15.8025 \text{ m}^2 + 6.9361 \text{ m}^2$
= 22.7386 m^2

$(2.06 \text{ m} + 3.5 \text{ m}) \times 2.495 / 2$
= 6.9361 m^2

2.060

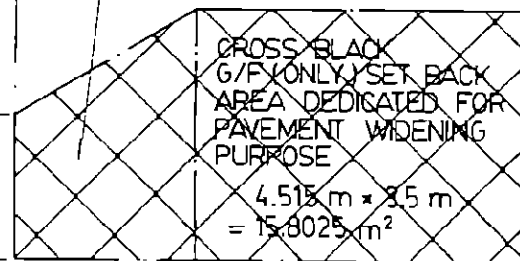

CROSS-BLACK
G/F (ONLY) SET BACK
AREA DEDICATED FOR
PAVEMENT WIDENING
PURPOSE

$4.515 \text{ m} \times 3.5 \text{ m}$
= 15.8025 m^2

3.500

2.495

4.515

7.010

(23'-0")

AGREED BY OWNER :

For and on behalf of
SAFER INVESTMENT

Authorized Signature(s)

QUEEN'S ROAD WEST NO. 517

Annexure to Memorial No. **5073591**

JOSHUA YUE-PONG CHEUNG
AUTHORISED PERSON (ARCHITECT)



For and on behalf of the
Government of Hong Kong

[Signature]
Anthony Gordon Eason
the Director of Buildings
and Lands

DEDICATION
PLAN

TOTAL DEDICATED AREA :
= 3.6722 m²

AGREED BY OWNER.

For and on behalf of
S.F.P.R. INVESTMENT

[Signature]
Authorized Signature(s)

[Signature]
JOSHUA YUE-PONG CHEUNG
AUTHORISED PERSON (ARCHITECT)

R.P. OF SEC. B
OF S.S.3 OF
OF SEC. B OF
M.L. 177

NO. 519

NO. 517

S.S.1 OF
SEC. B
OF S.S.3
OF SEC. B
OF M.L.
177

CROSS BLACK G/F (ONLY)
SET BACK AREA DEDICATED
FOR PAVEMENT WIDENING
PURPOSE

3.567 m x 2.059 m / 2
= 3.6722 m²

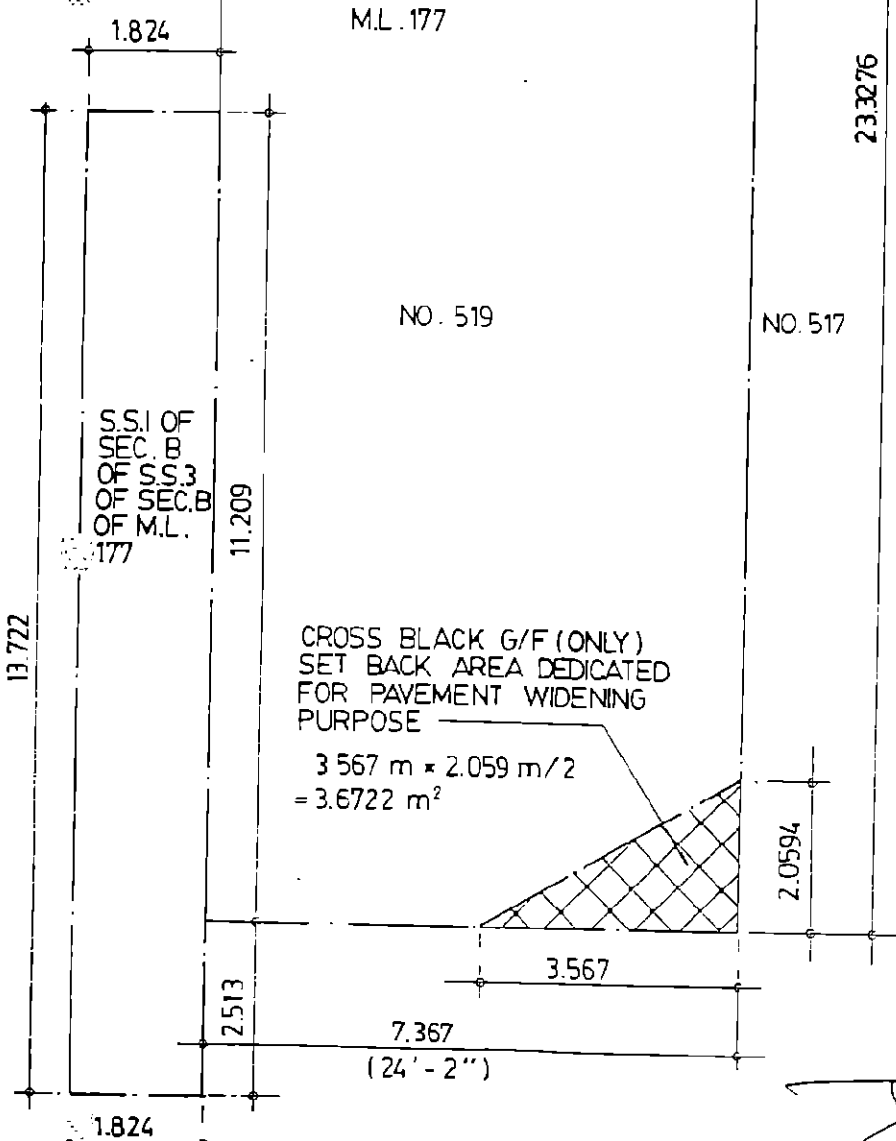

QUEEN'S ROAD WEST NO. 519

Annexure to Memorial No. **5073591**