

花園道 Garden Road

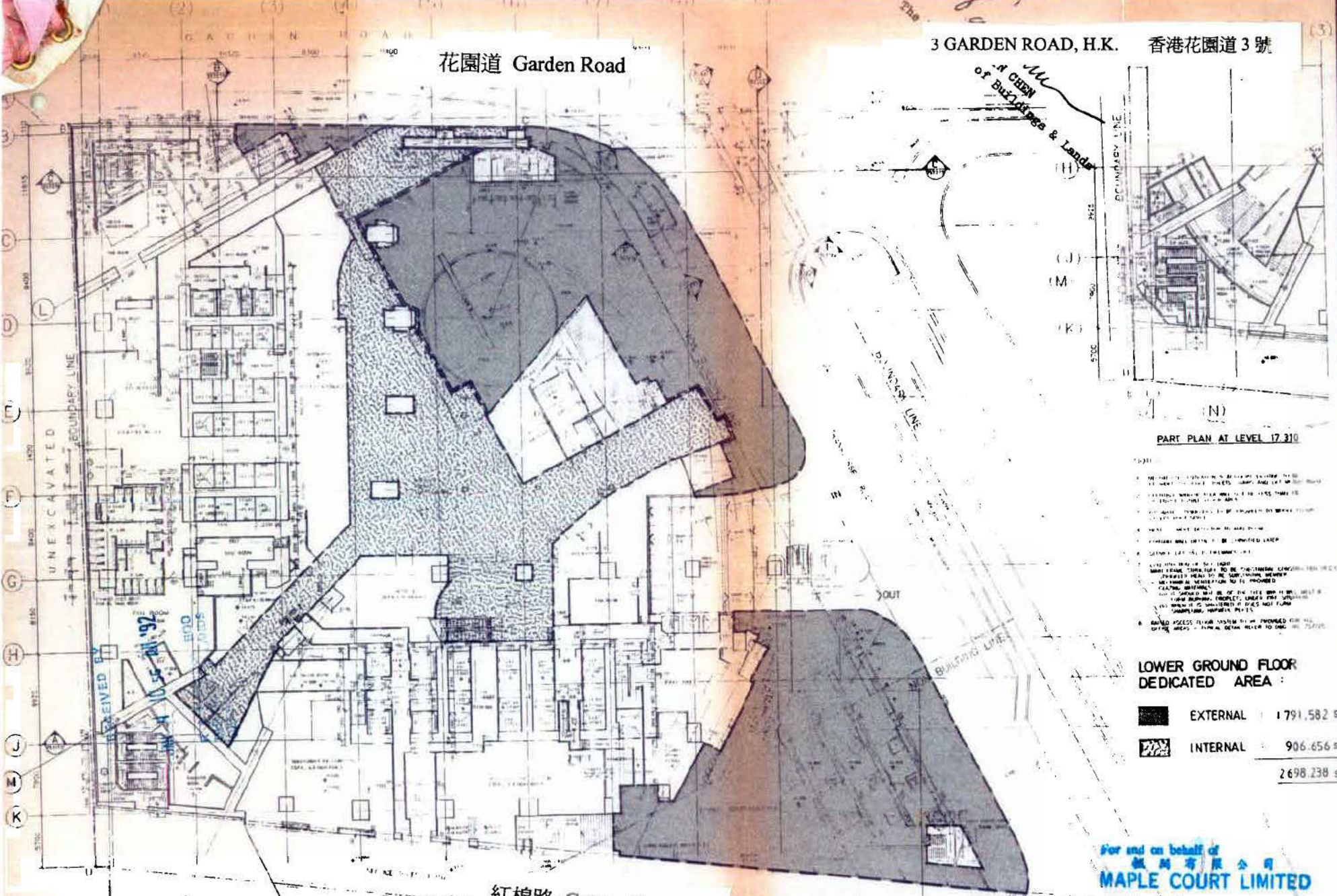

3 GARDEN ROAD, H.K. 香港花園道3號



PART PLAN AT LEVEL 17.310

1. THE PLAN IS FOR INFORMATION ONLY AND IS NOT TO BE USED FOR CONSTRUCTION PURPOSES.
2. THE PLAN IS FOR INFORMATION ONLY AND IS NOT TO BE USED FOR CONSTRUCTION PURPOSES.
3. THE PLAN IS FOR INFORMATION ONLY AND IS NOT TO BE USED FOR CONSTRUCTION PURPOSES.
4. THE PLAN IS FOR INFORMATION ONLY AND IS NOT TO BE USED FOR CONSTRUCTION PURPOSES.
5. THE PLAN IS FOR INFORMATION ONLY AND IS NOT TO BE USED FOR CONSTRUCTION PURPOSES.
6. THE PLAN IS FOR INFORMATION ONLY AND IS NOT TO BE USED FOR CONSTRUCTION PURPOSES.

LOWER GROUND FLOOR DEDICATED AREA :

	EXTERNAL	1791.582 sm
	INTERNAL	906.656 sm
		2698.238 sm

For and on behalf of 楓樹有限公司 MAPLE COURT LIMITED

Authorized Signature(s)

For and on behalf of 洋華發展有限公司 SHINE HILL DEVELOPMENT LIMITED

Authorized Signatories

For and on behalf of 洋華有限公司 SHINE DUTY LIMITED

Authorized Signature(s)

For and on behalf of 華信有限公司 SHINE BELT LIMITED

Authorized Signature(s)

For and on behalf of 華信有限公司 FAIR PAGE LIMITED

Authorized Signature(s)

For and on behalf of 華信有限公司 PANHY LIMITED

Authorized Signature(s)

CITICORP INTERNATIONAL LIMITED

Sylvia Wong (Mrs.) Assistant Vice President

For and on behalf of CITICORP INTERNATIONAL LIMITED

Charles Liu Associate Director

40

A 19.12.91 DEDICATED AREA REVIEW

SHINE HILL DEVELOPMENT LIMITED

PROPOSED COMMERCIAL DEVELOPMENT AT 11, 13, 15 GARDEN ROAD

LOWER GROUND FLOOR PLAN (DEDICATED AREA)

757 A 757 204

ROCCO DESIGN PARTNERS Architects & Engineers 許子顯建築工程師

(1a) (1) (2) (3) (4) (5) (6) (7) (8) (9)

花園道

*Darwin Chen*  
**DARWIN CHEN**  
 The Director of Buildings & Lands

1. THE BUILDING SHALL BE CONSTRUCTED IN ACCORDANCE WITH THE BUILDING REGULATIONS AND THE BUILDING CONTROL ORDINANCE.  
 2. THE BUILDING SHALL BE CONSTRUCTED TO THE FULL HEIGHT AND WIDTH OF THE SITE.  
 3. THE BUILDING SHALL BE CONSTRUCTED TO THE FULL DEPTH OF THE SITE.  
 4. THE BUILDING SHALL BE CONSTRUCTED TO THE FULL AREA OF THE SITE.  
 5. THE BUILDING SHALL BE CONSTRUCTED TO THE FULL HEIGHT AND WIDTH OF THE SITE.  
 6. THE BUILDING SHALL BE CONSTRUCTED TO THE FULL DEPTH OF THE SITE.  
 7. THE BUILDING SHALL BE CONSTRUCTED TO THE FULL AREA OF THE SITE.  
 8. THE BUILDING SHALL BE CONSTRUCTED TO THE FULL HEIGHT AND WIDTH OF THE SITE.  
 9. THE BUILDING SHALL BE CONSTRUCTED TO THE FULL DEPTH OF THE SITE.  
 10. THE BUILDING SHALL BE CONSTRUCTED TO THE FULL AREA OF THE SITE.

19.12.91 DEDICATED AREA REVISED

A  
B  
C  
D  
E  
F  
G  
H  
J  
K

11815  
9450  
9405  
9405  
9405  
8150  
9125  
7900

MURRAY  
FULDING  
LINK  
ROAD

RECEIVED BY  
JAN 4 10 55 AM '92

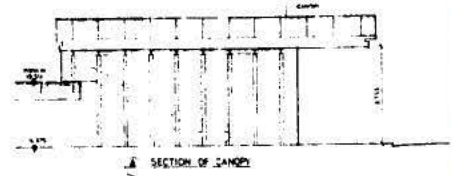
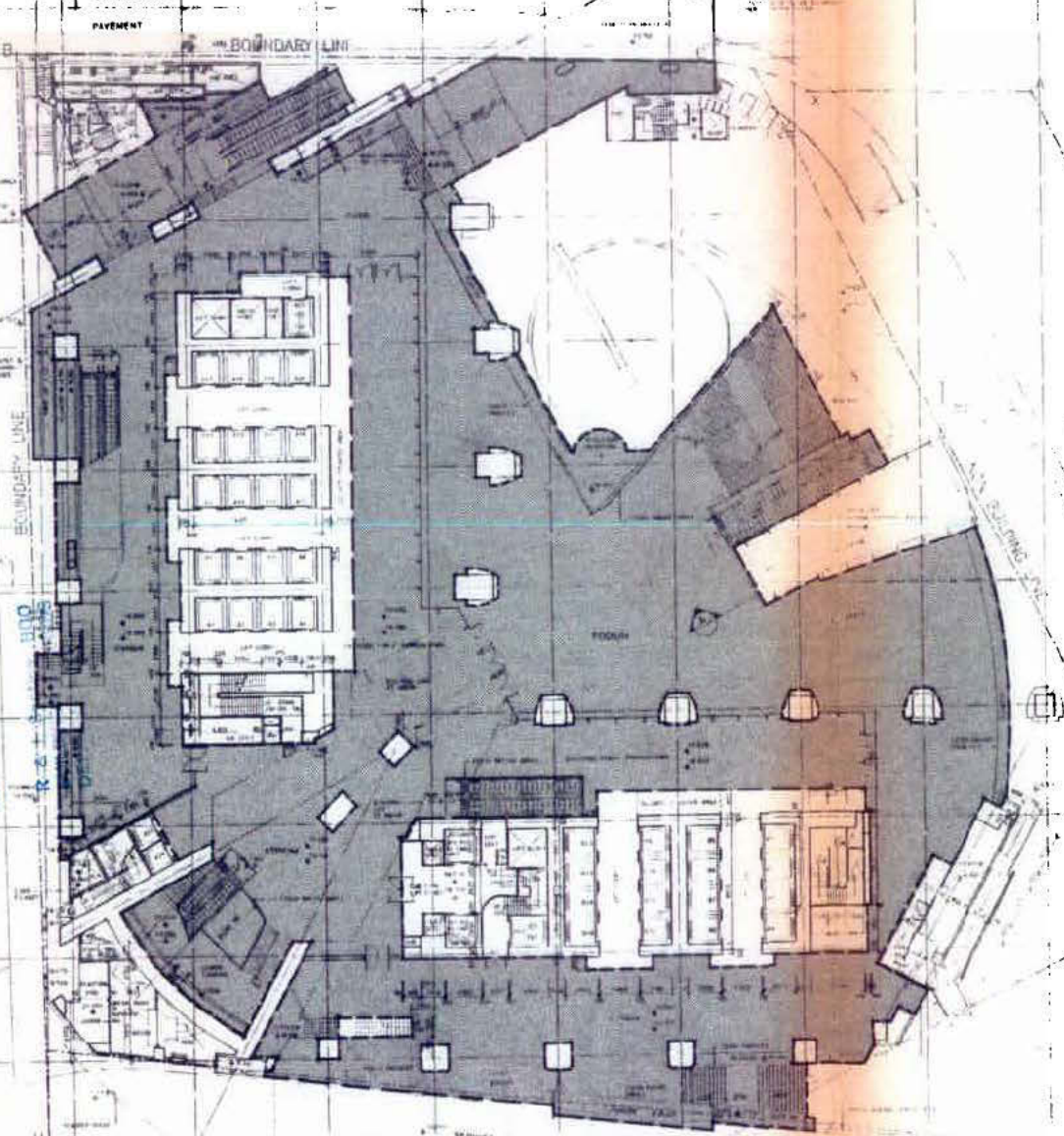

UPPER GROUND FLOOR DEDICATED AREA :  
 3334.169 s.m.

3 GARDEN ROAD, H.K. 香港花園道 3 號

For and on behalf of  
 楓樹有限公司  
**MAPLE COURT LIMITED**  
*[Signature]*  
 Authorized Signatory(s)

CITICORP INTERNATIONAL LIMITED  
*[Signature]*  
 Sylvia Wong (Mrs.)  
 Assistant Vice President

For and on behalf of  
 CITICORP INTERNATIONAL LIMITED  
*[Signature]*  
 Charles Liu  
 Associate Director

SHINE HILL DEVELOPMENT LIMITED  
 PROPOSED COMMERCIAL DEVELOPMENT AT 11.00 GARDEN ROAD  
 UPPER GROUND FLOOR PLAN (DEDICATED AREA)  
 757 A 757  
 1990 DESIGN PARTNERS  
 許李鐵建築工程師

For and on behalf of  
 洋華發展有限公司  
**SHINE HILL DEVELOPMENT LIMITED**  
*[Signature]*  
 Authorized Signatory(s)

For and on behalf of  
 紅棉路 Cotton Tree Drive  
 洋華發展有限公司  
**SHINE DUTY LIMITED**  
*[Signature]*  
 Authorized Signatory(s)

For and on behalf of  
 公平有限公司  
**FAIR PAGE LIMITED**  
*[Signature]*  
 Authorized Signatory(s)

For and on behalf of  
 中環有限公司  
**PANHY LIMITED**  
*[Signature]*  
 Authorized Signatory(s)

1a 1 2 4 5

A  
B  
C  
D  
E  
F  
G  
H  
I  
J  
K



RECEIVED BY

JAN 4 10 55 AM '92  
R. S. I Section B/D/O  
BUILDING DEPARTMENT

3 GARDEN ROAD, H.K. 香港花園道3號

*Jan Chan*  
The Director of Buildings & Lands  
DARWIN CHEN

1. THE PROPOSED DEVELOPMENT IS IN ACCORDANCE WITH THE PROVISIONS OF THE BUILDING (REGULATIONS) ACT, CAP. 123B AND THE BUILDING (REGULATIONS) (GENERAL) REGULATIONS, CAP. 123C.

2. THE PROPOSED DEVELOPMENT IS IN ACCORDANCE WITH THE PROVISIONS OF THE BUILDING (REGULATIONS) (FIRE) REGULATIONS, CAP. 123D.

3. THE PROPOSED DEVELOPMENT IS IN ACCORDANCE WITH THE PROVISIONS OF THE BUILDING (REGULATIONS) (ELECTRICAL) REGULATIONS, CAP. 123E.

4. THE PROPOSED DEVELOPMENT IS IN ACCORDANCE WITH THE PROVISIONS OF THE BUILDING (REGULATIONS) (MECHANICAL) REGULATIONS, CAP. 123F.

5. THE PROPOSED DEVELOPMENT IS IN ACCORDANCE WITH THE PROVISIONS OF THE BUILDING (REGULATIONS) (PLUMBING) REGULATIONS, CAP. 123G.

6. THE PROPOSED DEVELOPMENT IS IN ACCORDANCE WITH THE PROVISIONS OF THE BUILDING (REGULATIONS) (LIFT) REGULATIONS, CAP. 123H.

7. THE PROPOSED DEVELOPMENT IS IN ACCORDANCE WITH THE PROVISIONS OF THE BUILDING (REGULATIONS) (STAIRS) REGULATIONS, CAP. 123I.

8. THE PROPOSED DEVELOPMENT IS IN ACCORDANCE WITH THE PROVISIONS OF THE BUILDING (REGULATIONS) (ROOF) REGULATIONS, CAP. 123J.

9. THE PROPOSED DEVELOPMENT IS IN ACCORDANCE WITH THE PROVISIONS OF THE BUILDING (REGULATIONS) (WIND) REGULATIONS, CAP. 123K.

10. THE PROPOSED DEVELOPMENT IS IN ACCORDANCE WITH THE PROVISIONS OF THE BUILDING (REGULATIONS) (SOUND) REGULATIONS, CAP. 123L.

DEDICATED AREA INCLUDED IN DWG. NO. 757 206

For and on behalf of  
SHINE HILL DEVELOPMENT LIMITED  
*m*  
Authorized Signatory

For and on behalf of  
SHINE DUTY LIMITED  
*m*  
Authorized Signatory(s)

For and on behalf of  
SHINE BELT LIMITED  
*m*  
Authorized Signatory(s)

For and on behalf of  
FAIR PAGE LIMITED  
*m*  
Authorized Signatory(s)

For and on behalf of  
PANHY LIMITED  
*m*  
Authorized Signatory(s)

For and on behalf of  
MAPLE COURT LIMITED  
*m*  
Authorized Signatory(s)

NO. 757/206  
757 206

CITICORP INTERNATIONAL LIMITED  
*Sylvia Wong*  
Sylvia Wong (Mrs.)  
Assistant Vice President

For and on behalf of  
CITICORP INTERNATIONAL LIMITED  
*Charles Liu*  
Charles Liu  
Associate Director

SHINE HILL DEVELOPMENT LIMITED  
PROPOSED COMMERCIAL DEVELOPMENT AT 11.888 GARDEN ROAD  
UPPER PART OF UPPER GROUND FLOOR PLAN (DEDICATED AREA)  
757 7572

ROCOO DESIGN PARTNERS  
許李維建築工程師