

Annexure to Memorial No. **5167937**

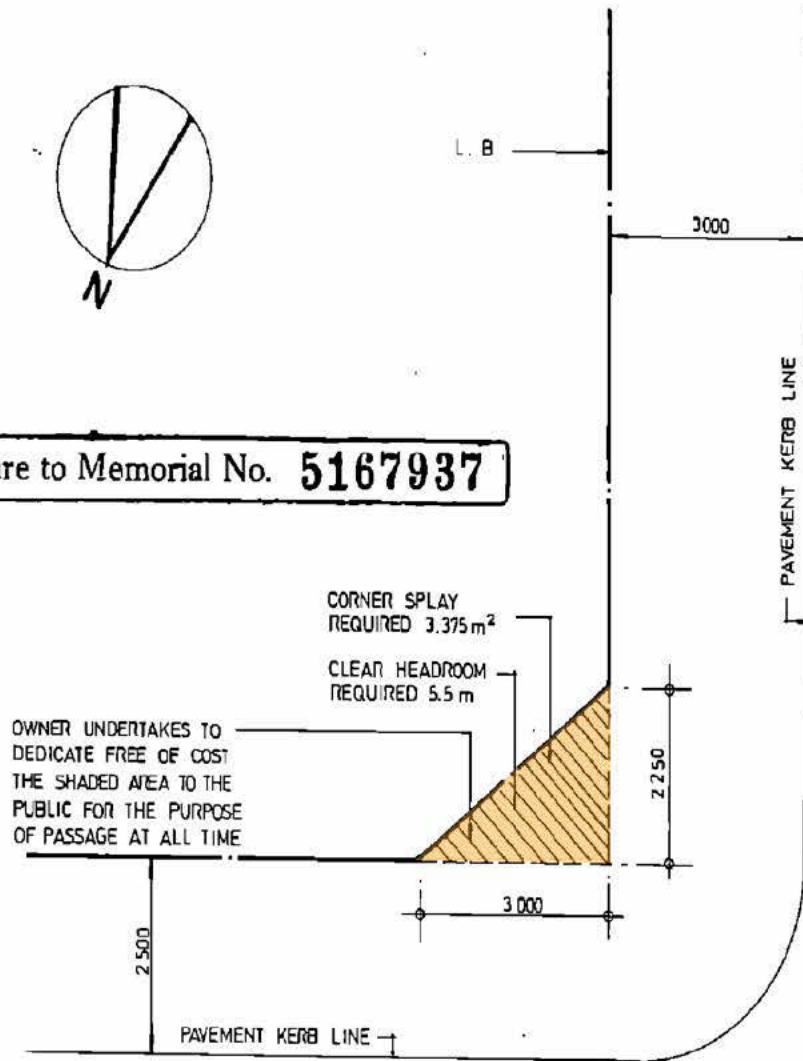

OWNER UNDERTAKES TO DEDICATE FREE OF COST THE SHADED AREA TO THE PUBLIC FOR THE PURPOSE OF PASSAGE AT ALL TIME

JAFFE ROAD 謝斐道

Signed

For and on behalf of
The Kwun Tung Provincial Bank.

Signed

(A. W. Samson)
P. Director of Buildings & Lands

CHINA CHARTER ESTATE COMPANY LTD.

香港杜老誌道6號

6 Tonnochy Road, HK

Permanent Managing Director

| | | |
|---|---|--------------------|
|  Thomas Ng and associates Architects, Surveyors, Valuers, Auctioneers, Property Development Consultants, Estate Agents, Arbitrators. | project: PART PLAN OF PROPOSED COMMERCIAL DEVELOPMENT ON M.L.440 S.E.R.P., S.H.R.P., S.I.R.P. & M.L.441 S.B.R.P. & S.C. | scale 1:100 |
| | title THE LAYOUT OF CORNER SPLAY REQUIRED BY THE HIGHWAY DEPARTMENT | date |
| | dwg. no. CS 101 | |