



UBM1626146 (2/1)

"B"

CHU KING DEVELOPMENT COMPANY LIMITED

[Handwritten signature]
Director

INLAND LOT NOS 3782 & 3783

SCALE = 1:600

香港菲林明道20號及謝斐道158號-172號

20 Fleming Road & 158-172 Jaffe Road, HK

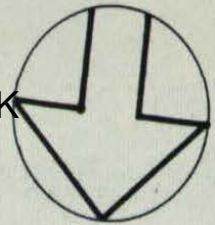

[Handwritten signature]
Chairman,
Board of Directors

[Handwritten signature]
Vice Chairman

[Handwritten signature]
D.W. McDonald

駱克道 LOCKHART ROAD

菲林明道

ROAD

RAMP

FLEMING

FLYOVER

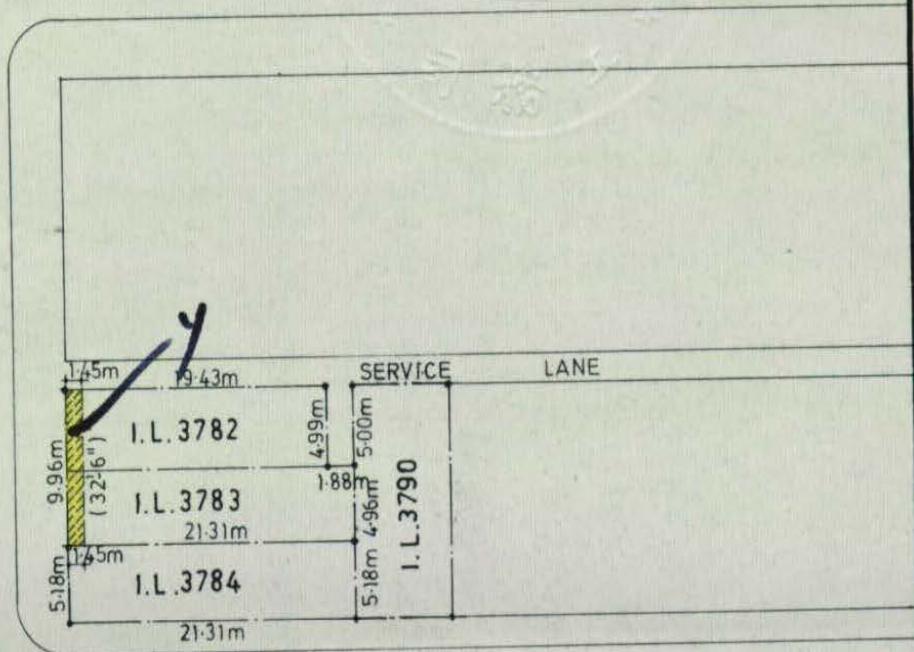

JAFFE ROAD 謝斐道

HATCHED AREA (1.45m X 9.96m) = 14.44m²
TO BE DEDICATED TO PUBLIC FOR THE PURPOSE OF PASSAGE

M.1626146

"A"



UBM1626146 (1/1)

CHIU KING DEVELOPMENT COMPANY LIMITED

[Handwritten signature]
Director

INLAND LOT No 3784

SCALE = 1:600

香港謝斐道158號-172號及菲林明道20號

158-172 Jaffe Road & 20 Fleming Road, HK

TUNG WAH GROUP OF HOSPITALS

[Handwritten signature]
Chairman,
Board of Directors

[Handwritten signature]
Vice Chairman

[Handwritten signature]
D.W. McDonald



駱克道 LOCKHART ROAD

菲林明道

ROAD

RAMP

FLEMING

FLYOVER

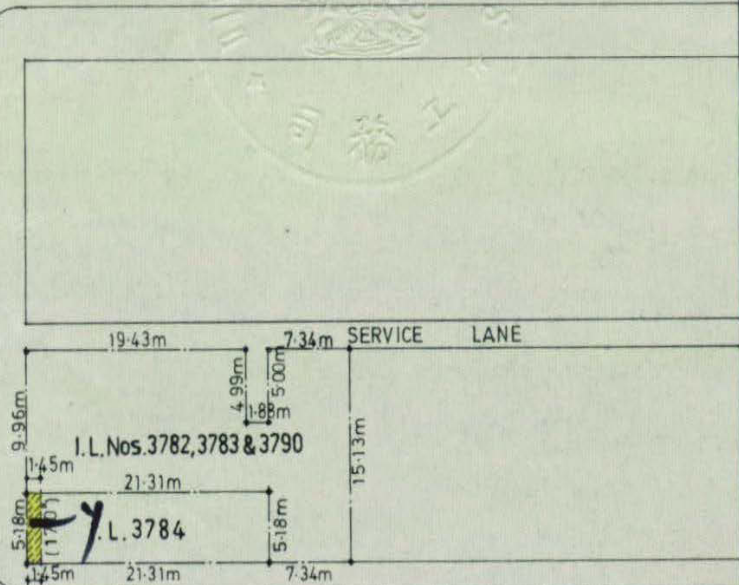

I.L. Nos. 3782, 3783 & 3790

L. 3784

JAFFE ROAD 謝斐道

HATCHED AREA (1.45m X 5.18m) = 7.51m²
TO BE DEDICATED TO PUBLIC FOR THE PURPOSE OF PASSAGE

M. 1626146