

THE CALCULATION OF GREENERY IS BASED ON THE PNAP APP-152 (REVISED IN JAN 2016)

SITE AREA (m ²)	MINIMUM SITE COVERAGE OF GREENERY			
	PRIMARY ZONE		OVERALL	
	REQUIRED (10%)	PROVIDED	REQUIRED (20%)	PROVIDED
1000 < 19400 < 20000	19400 x 10% =1940.000 m ²	2398.557 m ² / 19400 m ² =12.364% > 10%	19400 x 20% =3880.000 m ²	5805.634 m ² / 19400 m ² =29.926% > 20%

Pak Shek Kok Promenade

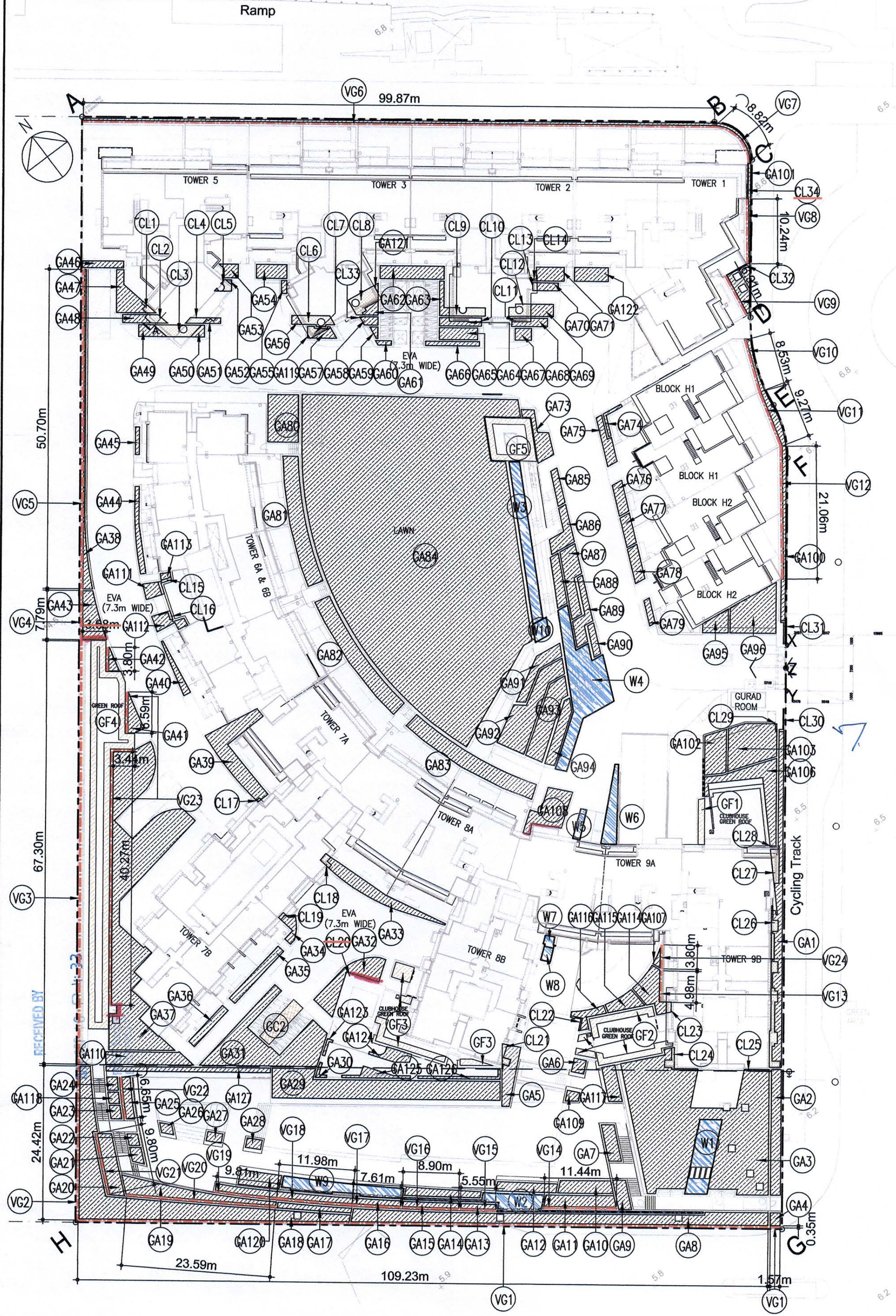

(a) CALCULATION FOR SITE COVERAGE OF PLANTER (m²)

GA1 = 48.739	GA65 = 11.283
GA2 = 31.066	GA66 = 5.950
GA3 = 333.111	GA67 = 4.861
GA4 = 3.179	GA68 = 5.833
GA5 = 17.902	GA69 = 6.978
GA6 = 4.282	GA70 = 4.139
GA7 = 11.712	GA71 = 9.667
GA8 = 108.946	GA73 = 15.143
GA9 = 9.394	GA74 = 2.729
GA10 = 16.802	GA75 = 10.092
GA11 = 19.943	GA76 = 8.124
GA12 = 13.879	GA77 = 7.818
GA13 = 4.225	GA78 = 8.992
GA14 = 13.742	GA79 = 3.890
GA15 = 7.102	GA80 = 36.013
GA16 = 27.568	GA81 = 50.311
GA17 = 9.121	GA82 = 51.796
GA18 = 153.626	GA83 = 55.508
GA19 = 34.322	GA84 = 1454.296
GA20 = 22.097	GA85 = 6.436
GA21 = 4.306	GA86 = 13.722
GA22 = 3.092	GA87 = 22.455
GA23 = 3.518	GA88 = 12.032
GA24 = 3.501	GA89 = 15.070
GA25 = 8.653	GA90 = 5.386
GA26 = 2.930	GA91 = 16.759
GA27 = 3.602	GA92 = 50.410
GA28 = 3.604	GA93 = 35.337
GA29 = 119.436	GA94 = 16.261
GA30 = 1.536	GA95 = 10.644
GA31 = 95.080	GA96 = 43.879
GA32 = 32.387	GA100 = 26.965
GA33 = 28.466	GA101 = 59.420
GA34 = 5.782	GA102 = 22.302
GA35 = 13.563	GA103 = 47.944
GA36 = 9.308	GA106 = 38.111
GA37 = 250.032	GA107 = 1.697
GA38 = 17.413	GA108 = 28.652
GA39 = 45.561	GA109 = 3.132
GA40 = 6.949	GA110 = 25.551
GA41 = 8.784	GA111 = 5.775
GA42 = 3.257	GA112 = 8.305
GA43 = 20.134	GA113 = 1.497
GA44 = 10.553	GA114 = 20.110
GA45 = 2.774	GA115 = 11.177
GA46 = 7.053	GA116 = 7.707
GA47 = 17.429	GA117 = 11.961
GA48 = 5.176	GA118 = 2.988
GA49 = 6.309	GA119 = 0.100
GA50 = 2.575	GA120 = 14.496
GA51 = 1.752	GA121 = 0.564
GA52 = 0.369	GA122 = 11.828
GA53 = 5.223	GA123 = 1.312
GA54 = 10.649	GA124 = 8.549
GA55 = 1.748	GA125 = 8.184
GA56 = 1.714	GA126 = 5.654
GA57 = 3.420	GA127 = 18.508
GA58 = 3.297	TOTAL = 4094.218
GA59 = 1.396	
GA60 = 1.638	
GA61 = 3.651	
GA62 = 20.798	
GA63 = 4.920	
GA64 = 5.819	

(b) CALCULATION FOR SITE COVERAGE OF WATER FEATURE (m²)

W1 = 36.780 x 50% = 18.390
W2 = 30.706 x 50% = 15.353
W3 = 42.222 x 50% = 21.111
W4 = 88.905 x 50% = 44.453
W5 = 5.077 x 50% = 2.539
W6 = 19.277 x 50% = 9.639
W7 = 2.736 x 50% = 1.368
W8 = 3.324 x 50% = 1.662
W9 = 33.450 x 50% = 16.725
W10 = 6.566 x 50% = 3.283
TOTAL = 134.522

(c) CALCULATION FOR SITE COVERAGE OF GREENERY AT GREEN ROOF (m²)

GF1 = 7.224 x 50% = 3.612
GF2 = 31.213 x 50% = 15.607
GF3 = 29.543 x 50% = 14.772
GF4 = 132.999 x 50% = 66.500
GF5 = 24.179 x 50% = 12.090
TOTAL = 112.579

(d) CALCULATION OF VERTICAL GREENING (m²)

VG1 = 110.80 x 2.80 = 310.240
VG2 = 24.42 x 2.80 = 68.376
VG3 = 67.30 x 2.80 = 188.440
VG4 = 7.79 x 2.80 = 21.812
VG5 = 50.70 x 2.80 = 141.960
VG6 = 99.87 x 1.80 = 179.766
VG7 = 8.82 x 1.80 = 15.876
VG8 = 10.24 x 1.80 = 18.432
VG9 = 6.91 x 1.80 = 12.438
VG10 = 8.53 x 1.80 = 15.354
VG11 = 9.27 x 1.80 = 16.686
VG12 = 21.06 x 1.80 = 37.908
VG13 = 4.98 x 2.4 = 11.952
VG14 = 11.44 x 1.60 = 18.304
VG15 = 5.55 x 0.75 = 4.163
VG16 = 8.90 x 1.60 = 14.240
VG17 = 7.61 x 1.95 = 14.840
VG18 = 11.98 x 1.95 = 23.361
VG19 = 9.81 x 1.10 = 10.791
VG20 = 23.59 x 1.60 = 37.744
VG21 = 9.80 x 1.60 = 15.680
VG22 = 6.65 x 1.60 = 10.640
VG23 = 209.252
VG24 = 3.80 x 2.4 = 9.120
TOTAL = 1407.374

(e) CALCULATION FOR SITE COVERAGE OF GRASS PAVING (m²)

GC2 = 15.862 x 50% = 7.931
TOTAL = 7.931

PERCENTAGE OF GREENING FEATURES :

(a) WATER FEATURE	(b) ROOF FEATURE	(c) VERTICAL GREENING	(d) GRASS PAVING	(e) COVERED GREENERY	(f) TOTAL
134.522	112.579	1407.374	7.931	49.0100	1711.416
GREEN FEATURE / TOTAL GREENERY AREA * 100					1711.416 / 5805.8085 * 100 = 29.478%

TOTAL GREENERY AREA :

(a) PLANTER	(b) WATER FEATURE	(c) ROOF FEATURE	(d) VERTICAL GREENING	(e) GRASS PAVING	(f) COVERED GREENERY	TOTAL
4094.218	134.522	112.579	1407.374	7.931	49.0100	5805.634 m ²
(29.92%)						

THE SUMMATION OF THE ABOVE GREENING FEATURES ARE NOT MORE THAN 30% OF THE TOTAL GREENERY AREAS.

NOTE : IRRIGATION TO BE PROVIDED AT GREENERY AREAS

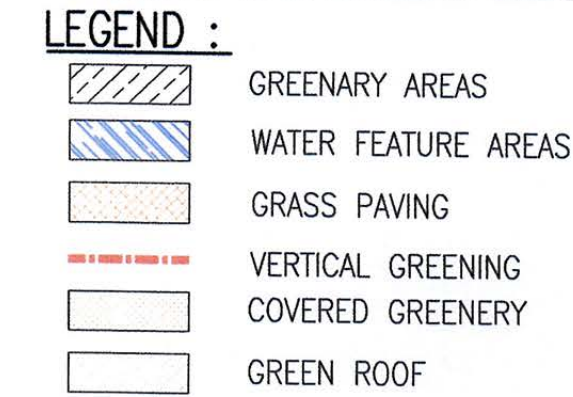

CALCULATION FOR SITE COVERAGE OF GREENERY AT PRIMARY ZONE (m²)

GA1 = 48.739	GA69 = 6.978
GA2 = 31.066	GA70 = 4.139
GA3 = 333.111	GA71 = 9.667
GA4 = 47.053	GA73 = 15.143
GA7 = 17.429	GA74 = 2.729
GA8 = 5.176	GA75 = 10.092
GA9 = 6.309	GA76 = 8.124
GA50 = 2.575	GA77 = 7.818
GA51 = 1.752	GA78 = 8.992
GA52 = 0.369	GA79 = 3.890
GA53 = 5.223	GA84 = 1454.960
GA54 = 10.649	GA85 = 6.436
GA55 = 1.748	GA86 = 13.722
GA56 = 1.714	GA87 = 22.455
GA57 = 3.420	GA88 = 15.070
GA58 = 3.297	GA89 = 5.386
GA59 = 1.396	GA90 = 16.759
GA60 = 1.638	GA91 = 50.410
GA61 = 3.651	GA92 = 35.330
GA62 = 20.798	GA94 = 16.261
GA63 = 4.920	GA100 = 26.965
GA64 = 5.819	GA101 = 59.420
GA65 = 11.283	GA102 = 22.302
GA66 = 5.950	GA103 = 47.944
GA67 = 4.861	GA106 = 38.111
GA68 = 5.833	GA107 = 1.697

(f) COVERED GREENERY (m²)

CL1 = 1.663 x 50% = 0.832	CL17 = 0.214 x 50% = 0.107
CL2 = 3.259 x 50% = 1.630	CL18 = 1.911 x 50% = 0.955
CL3 = 9.438 x 50% = 4.719	CL19 = 0.548 x 50% = 0.274
CL4 = 2.972 x 50% = 1.486	CL20 = 1.255 x 50% = 0.627
CL5 = 2.105 x 50% = 1.053	CL21 = 2.361 x 50% = 1.181
CL6 = 6.797 x 50% = 3.399	CL22 = 0.792 x 50% = 0.396
CL7 = 3.376 x 50% = 1.688	CL23 = 1.305 x 50% = 0.652
CL8 = 10.786 x 50% = 5.393	CL24 = 3.564 x 50% = 1.782
CL9 = 6.519 x 50% = 3.260	CL25 = 0.789 x 50% = 0.395
CL10 = 2.959 x 50% = 1.480	CL26 = 17.075 x 50% = 8.538
CL11 = 1.725 x 50% = 0.863	CL27 = 5.961 x 50% = 2.981
CL12 = 5.191 x 50% = 2.596	CL28 = 0.176 x 50% = 0.088
CL13 = 0.855 x 50% = 0.428	CL29 = 0.238 x 50% = 0.119
CL14 = 0.268 x 50% = 0.134	CL30 = 0.689 x 50% = 0.345
CL15 = 1.605 x 50% = 0.802	CL31 = 0.976 x 50% = 0.488
CL16 = 0.823 x 50% = 0.412	CL32 = 0.250 x 50% = 0.125
	CL33 = 0.059 x 50% = 0.030
	CL34 = 0.771 x 50% = 0.386
	TOTAL = 49.010

CALCULATION FOR VERTICAL GREENING

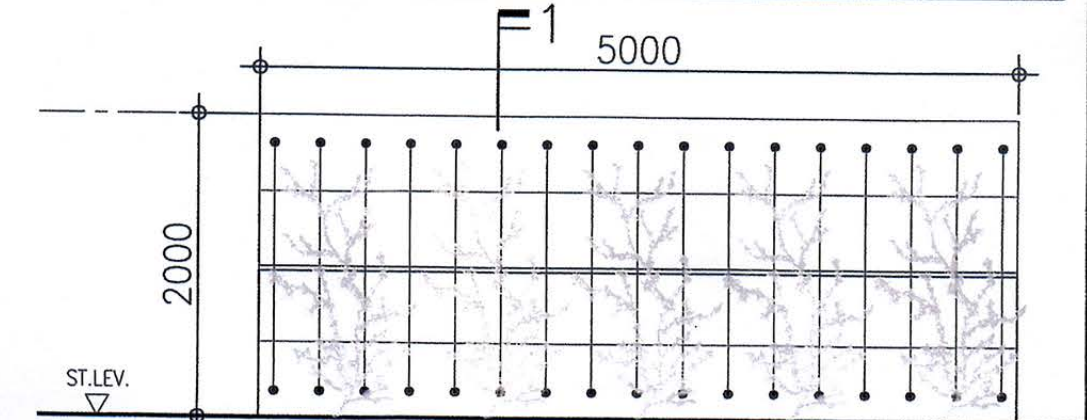

ELEVATION OF VERTICAL GREENING ON METAL FENCE WALL (VG6 TO VG12)

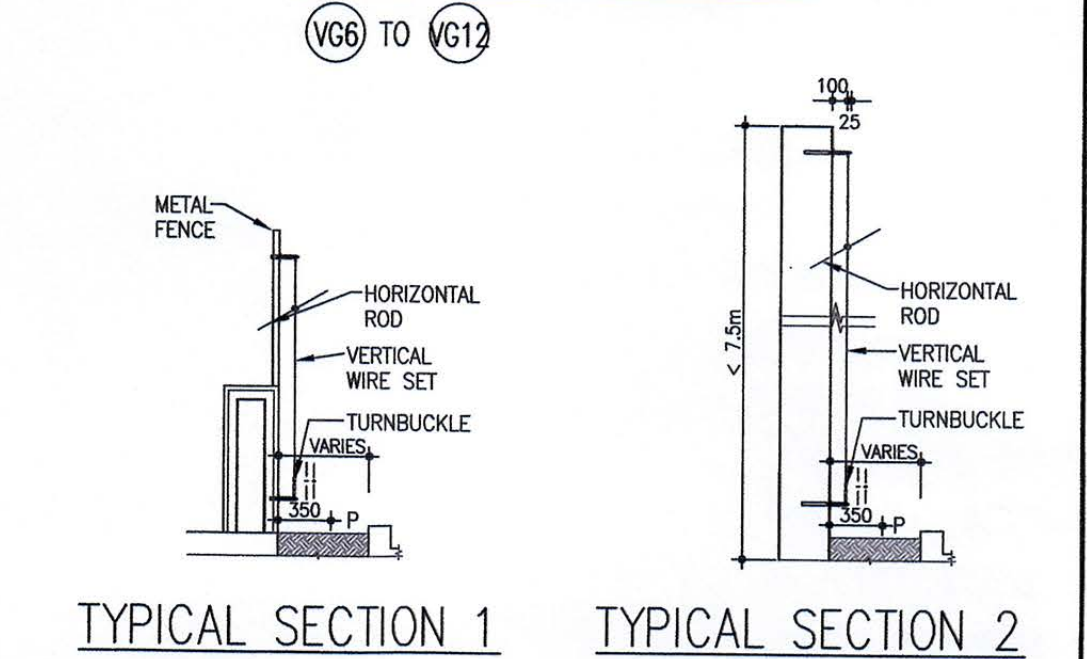

TYPICAL SECTION 1 TYPICAL SECTION 2

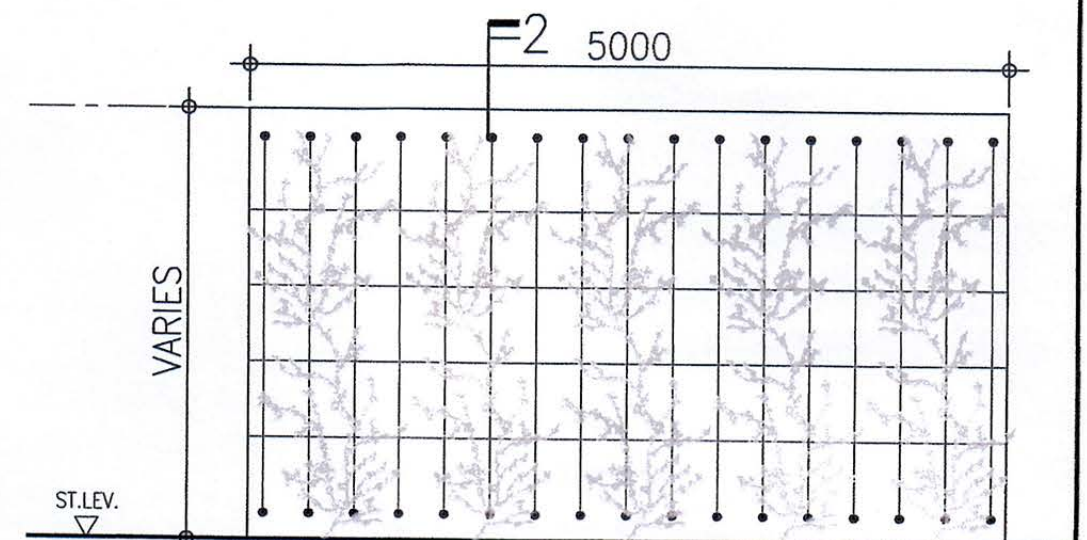

ELEVATION OF VERTICAL GREENING ON SOLID WALL (VG1 TO VG5 & VG13 TO VG24)

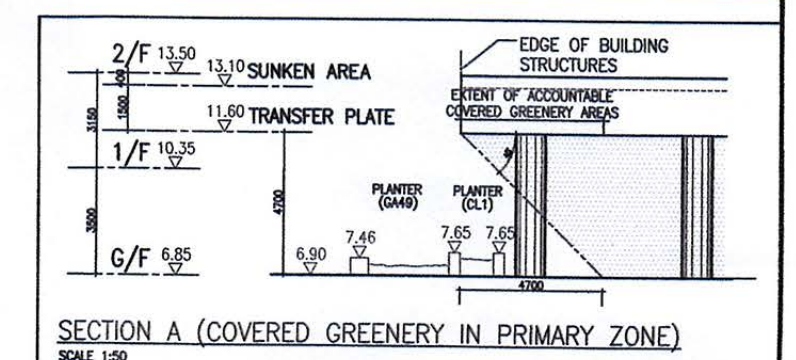

SECTION A (COVERED GREENERY IN PRIMARY ZONE) SCALE 1:50

Plan Approved
TSANG Po-king, Aileen
Senior Building Surveyor
for BUILDING AUTHORITY
16 OCT 2018

I hereby certify this drawing is a true copy of set 1.

KENNETH T.H. CHAU R.I.B.A. F.R.I.A.
AUTHORIZED PERSON-ARCHITECT
AP(A) 43/78, OCT 16, 2018

KENNETH T.H. CHAU R.I.B.A. F.R.I.A.
AUTHORIZED PERSON-ARCHITECT

B.D. SUBMISSION
AMENDMENT
18 SEP 2018

STATEMENT II: The Works shown on these plans are Type II works (Name of works: Building) in respect of which the Building Authority's comment is applied for. Note: First consent dated: August 24, 2017

C Y S Associates (H K) Ltd.
Architects & Urban Designers.
30TH FLOOR • HONG KONG PLAZA • 186 CONNAUGHT ROAD WEST • HONG KONG
TEL: 2858 0603 • FAX: 2858 0683 2858 9366 • E-MAIL: cys@cysarch.com.hk

PROJECT
PROPOSED RESIDENTIAL DEVELOPMENT
AT TAI PO TOWN LOT NO. 214,
FO YIN ROAD, PAK SHEK KOK, TAI PO, N.T.

DO NOT SCALE DRAWING. FIGURED DIMENSIONS ARE TO BE FOLLOWED. COPYRIGHT OF THIS DRAWING IS RESERVED BY ARCHITECT.

NO.	DATE	REVISION	APP.	NO.	DATE	REVISION	APP.	NO.	DATE	REVISION	APP.	NO.	DATE	REVISION	APP.
A	2015-07-21	B.D. SUBMISSION	THK	F	2017-02-15	B.D. SUBMISSION	THK	DESIGNED	PC		THK	DESIGNED	PC		THK
B	2015-10-18	B.D. SUBMISSION	THK	G	2017-09-14	B.D. SUBMISSION	THK	APPROVED	CT/HT		THK	CHECKED	CT/HT		THK
C	2016-03-18	B.D. SUBMISSION	THK	H	2018-02-28	B.D. SUBMISSION	THK	DATE	SCALE		THK	DATE	SCALE		THK
D	2016-04-29	B.D. SUBMISSION	THK	I	2018-06-22	B.D. SUBMISSION	THK	1:500			THK	2015-02			THK
E	2016-08-10	B.D. SUBMISSION	THK	J	2018-09-18	B.D. SUBMISSION	THK				THK				THK

DRAWING TITLE:
SUSTAINABLE BUILDING DESIGN
CALCULATION (SHEET 3)

PROJECT NO :
14-499
REV. :
J
DRAWING NO : A-101
CAD REF : 499-CAL-SBD

CYS

V:\CYS\CAD\14-499\BDA\2018-11\499-CAL-SBD.DWG