

B.D.  
F.S.D.

REVISIONS

g	NOV., 2017	GENERAL REVISION
f	MAY., 2017	GENERAL REVISION
e	JUN., 2016	GENERAL REVISION
d	FEB., 2016	GENERAL REVISION
c	JUN., 2015	GENERAL REVISION
b	OCT., 2014	GENERAL REVISION
a	MAR., 2014	RESUBMISSION

工程名稱 PROJECT  
PROPOSED RESIDENTIAL DEVELOPMENT AT SHA TIN TOWN LOT NO. 574

FOR B.D. APPROVAL

DANIEL LIN HSIEN WEN  
AUTHORIZED PERSON-ARCHITECT

FOR B.D. APPROVAL

DRAWING TITLE

TOWER 3 ELEVATION 3

DRAWN APPROVED

REVIEWED JOB NO.  
A 20131

ISSUED FOR DATE  
DEC., 2013

DRAWING NO. SCALE

227(g) 1 : 150

SITE COVERAGE OF GREENERY

APP-152 (18)  
SITE AREA 14,400 SQM  
GREENERY AREA WITH VISUAL PENETRABILITY AT PEDESTRIAN ZONE CALCULATION  
LEGEND: 10% GREENERY = 1,440 SQM  
TOTAL GREENERY AREA AT PEDESTRIAN ZONE 12.062% > 10% OF SITE AREA

OTHER GREENERY AREA CALCULATION  
LEGEND: 10% GREENERY = 1,440 SQM  
TOTAL UNCOVERED GREENERY AREA 42.877% > 20% OF SITE AREA

TOTAL UNCOVERED GREENERY AREA 42.877% > 20% OF SITE AREA

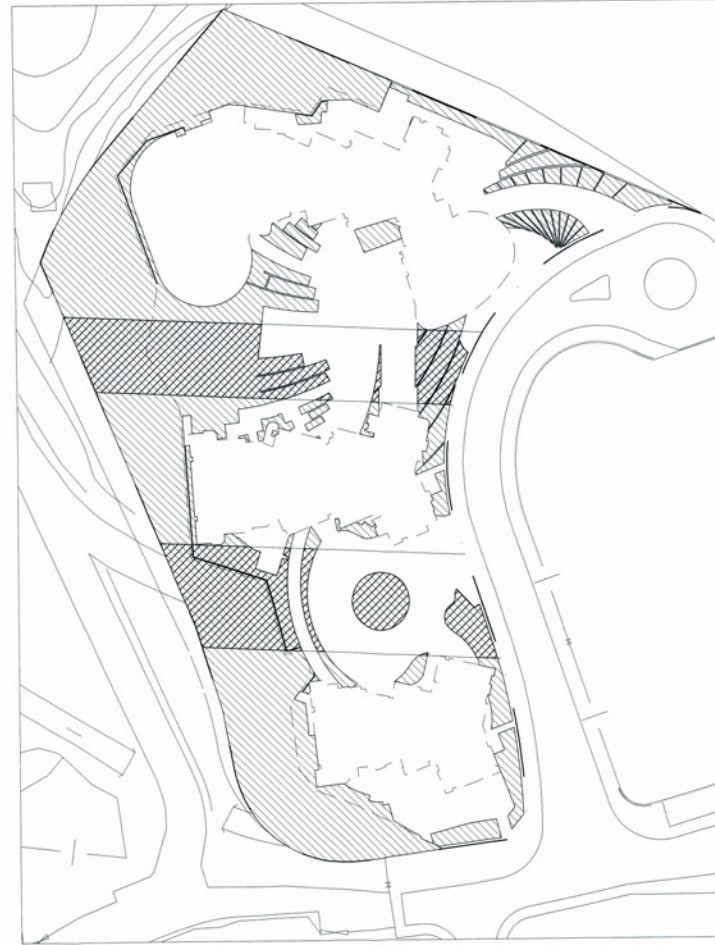

TOWER 3A EAST ELEVATION 1

STATEMENT II : THE WORKS SHOWN ON THESE PLANS ARE TYPE II WORKS IN RESPECT OF WHICH THE BUILDING AUTHORITY'S CONSENT IS APPLIED FOR.

RECEIVED BY  
2013.07.25 A 11:32  
A+T DESIGN