

**SITE COVERAGE OF GREENERY**  
(PNAP APP-152 & SPECIAL CONDITIONS S.C. 8 UNDER LEASE REFERRED)  
(JANUARY 2011)

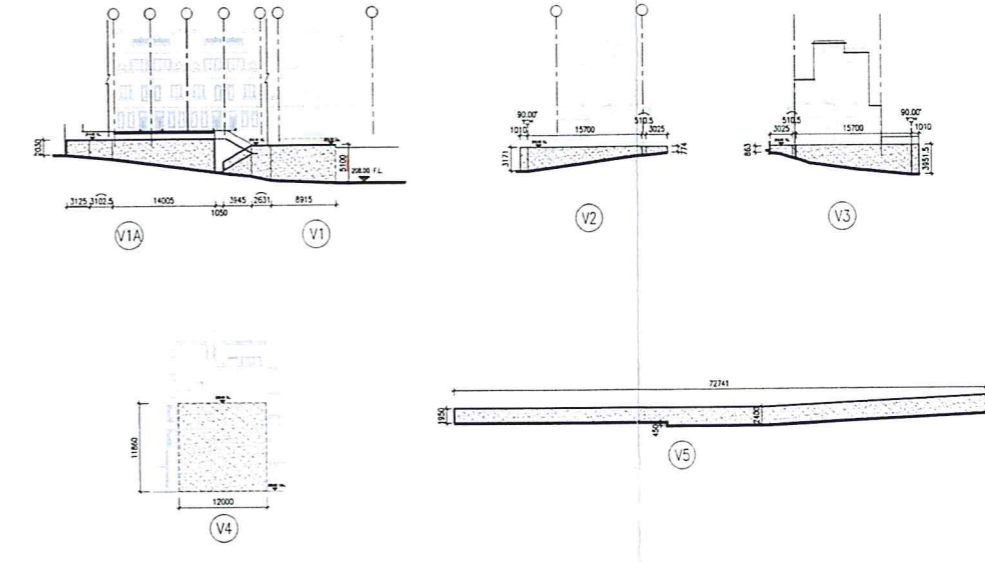
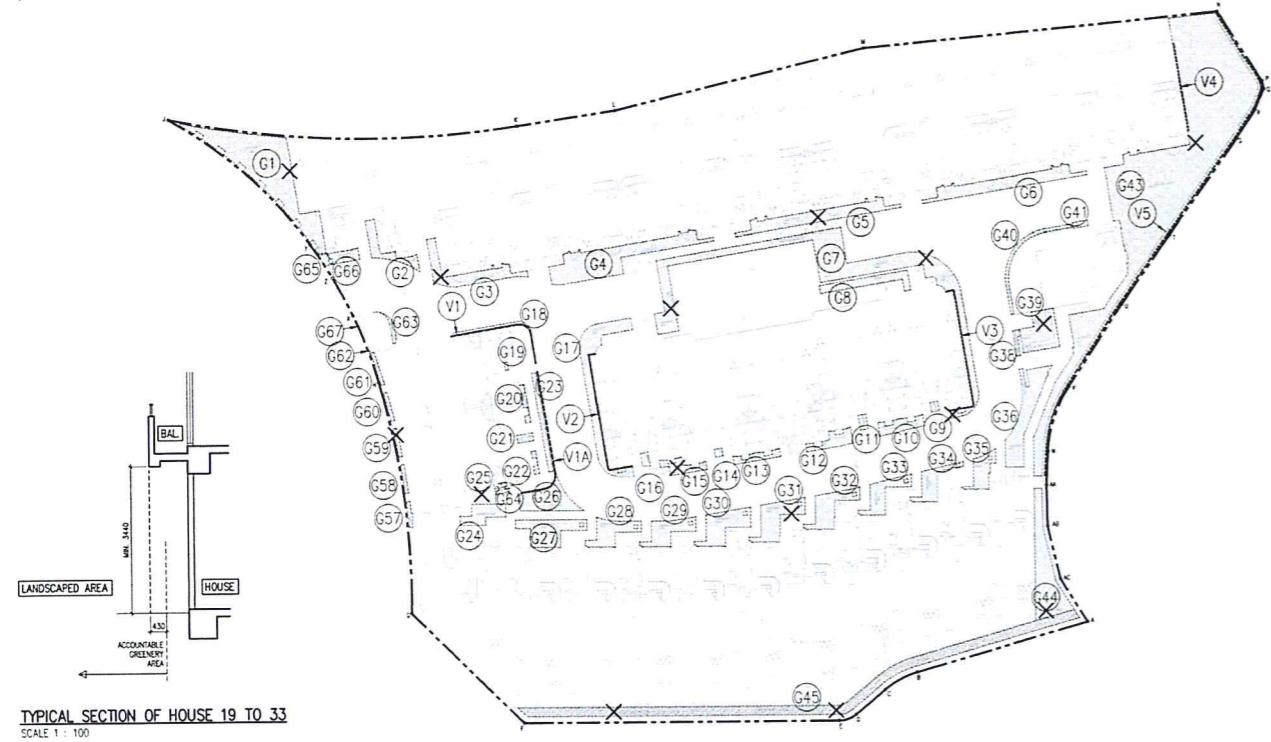

**SITE PLAN SHOWING SITE COVERAGE OF GREENERY**  
1:500

**LEGEND**  
[Symbol] SITE COVERAGE OF GREENERY AT PEDESTRIAN ZONE  
[Symbol] SITE COVERAGE OF GREENERY AT OTHER LOCATIONS  
[X] IRRIGATION POINT AND DRAINAGE POINT  
[Symbol] VERTICAL GREENERING

**CALCULATION FOR SITE COVERAGE OF GREENERY**

TOTAL SITE AREA (UNDER LEASE) = 8590.000 M<sup>2</sup>  
REQUIRED TOTAL GREENERY AREAS UNDER SBD GUIDELINE = 8590.000 M<sup>2</sup> x 20% = 1718.000 M<sup>2</sup>  
REQUIRED TOTAL GREENERY AREAS AT PEDESTRIAN ZONE = 8590.000 M<sup>2</sup> x 10% = 859.000 M<sup>2</sup>  
MAX. ACCOUNTABLE VERTICAL GREENERING = 1718.000 M<sup>2</sup> x 30% = 515.400 M<sup>2</sup>

**VERTICAL GREENERING**

V1	= 66.294 M <sup>2</sup>
V1A	= 64.024 M <sup>2</sup>
V2	= 40.011 M <sup>2</sup>
V3	= 56.412 M <sup>2</sup>
V4	= 142.320 M <sup>2</sup>
V5	= 161.430 M <sup>2</sup>
<b>TOTAL</b>	<b>= 530.491 M<sup>2</sup></b>

**PROVIDED GREENERY AREA AT PEDESTRIAN ZONE**

G1 = 82.816 M <sup>2</sup>	G11 = 2.198 M <sup>2</sup>	G21 = 2.393 M <sup>2</sup>	G31 = 21.453 M <sup>2</sup>	G41 = 1.636 M <sup>2</sup>	G62 = 0.030 M <sup>2</sup>
G2 = 12.045 M <sup>2</sup>	G12 = 9.038 M <sup>2</sup>	G22 = 1.515 M <sup>2</sup>	G32 = 18.159 M <sup>2</sup>	G42 = 72.960 M <sup>2</sup>	G63 = 2.136 M <sup>2</sup>
G3 = 24.089 M <sup>2</sup>	G13 = 5.457 M <sup>2</sup>	G23 = 8.133 M <sup>2</sup>	G33 = 14.938 M <sup>2</sup>	G43 = 336.314 M <sup>2</sup>	G64 = 9.895 M <sup>2</sup>
G4 = 53.414 M <sup>2</sup>	G14 = 1.183 M <sup>2</sup>	G24 = 12.496 M <sup>2</sup>	G34 = 12.252 M <sup>2</sup>	G44 = 40.035 M <sup>2</sup>	G65 = 1.622 M <sup>2</sup>
G5 = 31.361 M <sup>2</sup>	G15 = 7.402 M <sup>2</sup>	G25 = 1.542 M <sup>2</sup>	G35 = 11.571 M <sup>2</sup>	G45 = 100.469 M <sup>2</sup>	G66 = 5.778 M <sup>2</sup>
G6 = 31.916 M <sup>2</sup>	G16 = 1.988 M <sup>2</sup>	G26 = 21.071 M <sup>2</sup>	G36 = 33.016 M <sup>2</sup>	G57 = 1.947 M <sup>2</sup>	G67 = 0.030 M <sup>2</sup>
G7 = 115.319 M <sup>2</sup>	G17 = 35.631 M <sup>2</sup>	G27 = 22.799 M <sup>2</sup>	G37 = 10.850 M <sup>2</sup>	G58 = 1.981 M <sup>2</sup>	
G8 = 14.768 M <sup>2</sup>	G18 = 3.796 M <sup>2</sup>	G28 = 15.828 M <sup>2</sup>	G38 = 2.430 M <sup>2</sup>	G59 = 1.963 M <sup>2</sup>	
G9 = 1.439 M <sup>2</sup>	G19 = 0.476 M <sup>2</sup>	G29 = 15.954 M <sup>2</sup>	G39 = 22.260 M <sup>2</sup>	G60 = 1.968 M <sup>2</sup>	
G10 = 8.956 M <sup>2</sup>	G20 = 2.251 M <sup>2</sup>	G30 = 21.085 M <sup>2</sup>	G40 = 7.936 M <sup>2</sup>	G61 = 2.320 M <sup>2</sup>	

TOTAL = 1211.498 M<sup>2</sup> > 859.000 M<sup>2</sup> (i.e. COMPLIED)  
TOTAL GREENERY AREAS PROVIDED = 1211.498 + 515.400 M<sup>2</sup> = 1726.898 M<sup>2</sup> > 1718.000 M<sup>2</sup> (i.e. COMPLIED)

E	01/2017	GENERAL REVISION
D	10/2016	GENERAL REVISION
C	01/2016	GENERAL REVISION
B	05/2015	GENERAL REVISION
A	09/2014	GENERAL REVISION
NO.	DATE	AMENDMENT

**P&T Architects and Engineers Ltd**

HONG KONG: P&T ARCHITECTS AND ENGINEERS LTD / PALMER & TURNER INTERNATIONAL INC. 33/7, 633 KING'S ROAD, NORTH POINT, HONG KONG. TEL: 852-2775 6270 FAX: 852-2551 3534  
SINGAPORE: P&T CONSULTANTS PTE LTD. 2300 CLIFFORD CENTRE, 24 RAFFLES PLACE, SINGAPORE 04021. TEL: 65-6333 2011 FAX: 65-6333 1263  
THAILAND: PALMER & TURNER (THAILAND) LTD. BANGKOK CABLE BUILDING 4, 2/F, 231-18, 501 SARAJIN, RAJABURJ ROAD, BANGKOK 10330, THAILAND. TEL: 66-2-621 8180 FAX: 66-2-621 8170  
SHANGHAI: PALMER & TURNER CONSULTANTS (SHANGHAI) LTD. 1508, TOWER II, CITY CENTRE OF SHANGHAI, 1610 20th FLOOR, 100021 SHANGHAI, CHINA POST CODE 200021. TEL: 8621-63372908 FAX: 8621-63372202  
BEIJING: PALMER & TURNER CONSULTANTS (SHANGHAI) LTD. BEIJING BRANCH. TOWER #2/2000 GREENLAND PLAZA, 1611 EAST CHANG AN AVE., DONG CHENG DISTRICT, BEIJING, CHINA POST CODE 100738. TEL: 8610-85181616 FAX: 8610-85181625  
MACAU: P&T ARCHITECTS & ENGINEERS LTD. MACAU BRANCH. RUA DA PRAIA GRANDE CENTRO COMMERCIAL DA PRAIA GRANDE 20 ANDAR/MACAU. TEL: 853-550241 FAX: 853-514214  
MALAYSIA: P&T ARCHITECTS & ENGINEERS LTD. MALAYSIA BRANCH. 63 JOMER SQUARE FLOOR CHONGAI BUKIT BIRANG, 30000 KUALA LUMPUR, MALAYSIA. TEL: 60-3-2142 6253 FAX: 60-3-2142 2198  
INDONESIA: P&T ARCHITECTS & ENGINEERS LTD. P.O. BOX 2129/MT, JAKARTA, INDONESIA. TEL: 62-21-8712 8809 FAX: 62-21-8712 3405  
TANJANG: P&T ARCHITECTS & ENGINEERS LTD. 9TH FLOOR, 170 SUN HWA NORTH ROAD, TANJANG, INDONESIA. TEL: 62-21-8712 8809 FAX: 62-21-8712 3405

Note: This plan has been processed on a building permit under the consultant's professional seal as promulgated in Form A. Although the design of the building permit is not a registered structural engineer and/or registered architectural engineer, the provision of such a permit is not a condition of the building permit.

Plan Approved  
LAW Pui-sze, Amy  
Senior Building Surveyor  
for BUILDING AUTHORITY  
16 FEB 2017

For Ming Yee, Jennifer  
Registered Architect  
B.A. (Hons) Dip. Arch. HKIA  
Authorized Person

THE WORKS SHOWN ON THESE PLANS ARE TYPE II WORKS GENERAL BUILDING WORKS IN RESPECT OF WHICH CONSENT IS APPLIED FOR THE PURPOSE OF FAST TRACK CONSENT APPLICATION UNDER REGULATION 33 OF THE BUILDING (ADMINISTRATION) REGULATIONS.

**AMENDED PLAN**

PROJECT	PROPOSED RESIDENTIAL DEVELOPMENT AT STTL NO 565, AREA 56A, KAU TO, SHA TIN, NT				
DRAWING	DIAGRAM OF COMPLIANCE TO S.B.D. GUIDELINES				
SCALE	1:500	NUMBER	4833		
DATE	04/2014		C-05		
DRAWN			A	B	C
CHECKED					
					APPROVED

• ALL DIMENSIONS ARE IN MILLIMETER EXCEPT OTHERWISE NOTED  
• DO NOT SCALE DRAWING  
• ALL MEASUREMENTS SHOULD BE VERIFIED ON SITE  
THE OWNERSHIP OF THE COPYRIGHT IN THIS DRAWING IS RETAINED BY P&T ARCHITECTS AND ENGINEERS LTD. NO PART OF THIS DRAWING IS TO BE REPRODUCED OR TRANSMITTED IN ANY FORM OR BY ANY MEANS, ELECTRONIC OR MECHANICAL, WITHOUT THE WRITTEN PERMISSION OF P&T ARCHITECTS AND ENGINEERS LTD.