

RECEIVED BY
 27th JULY 2014 08
 R.A.D. Section
 Building Department

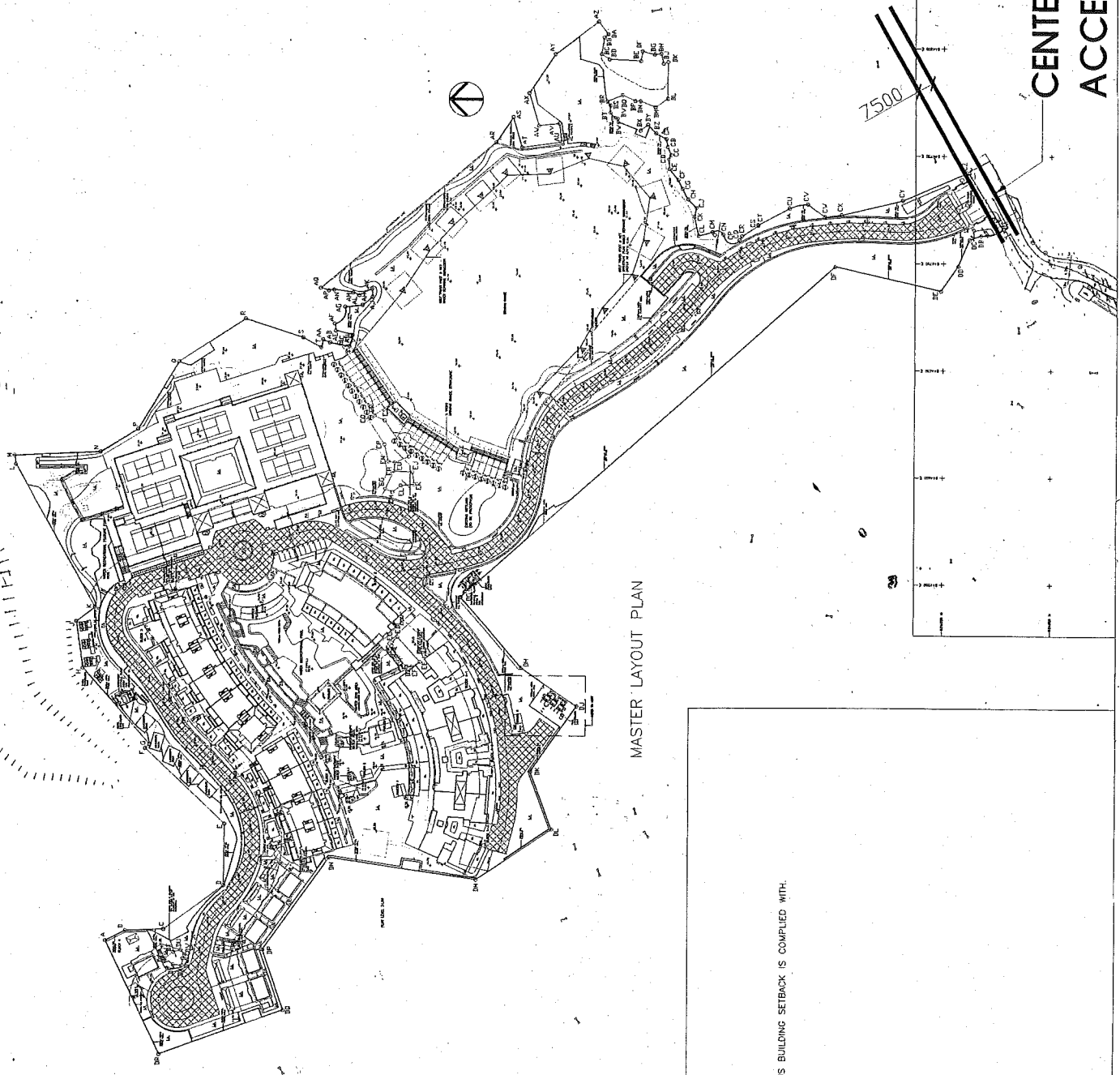

BUILDING SETBACK (PNAP 152)

NO BUILDING WOULD BE BUILT WITHIN 7.5m FROM THE CENTER LINE OF THE ACCESS ROAD, THUS BUILDING SETBACK IS COMPLIED WITH.

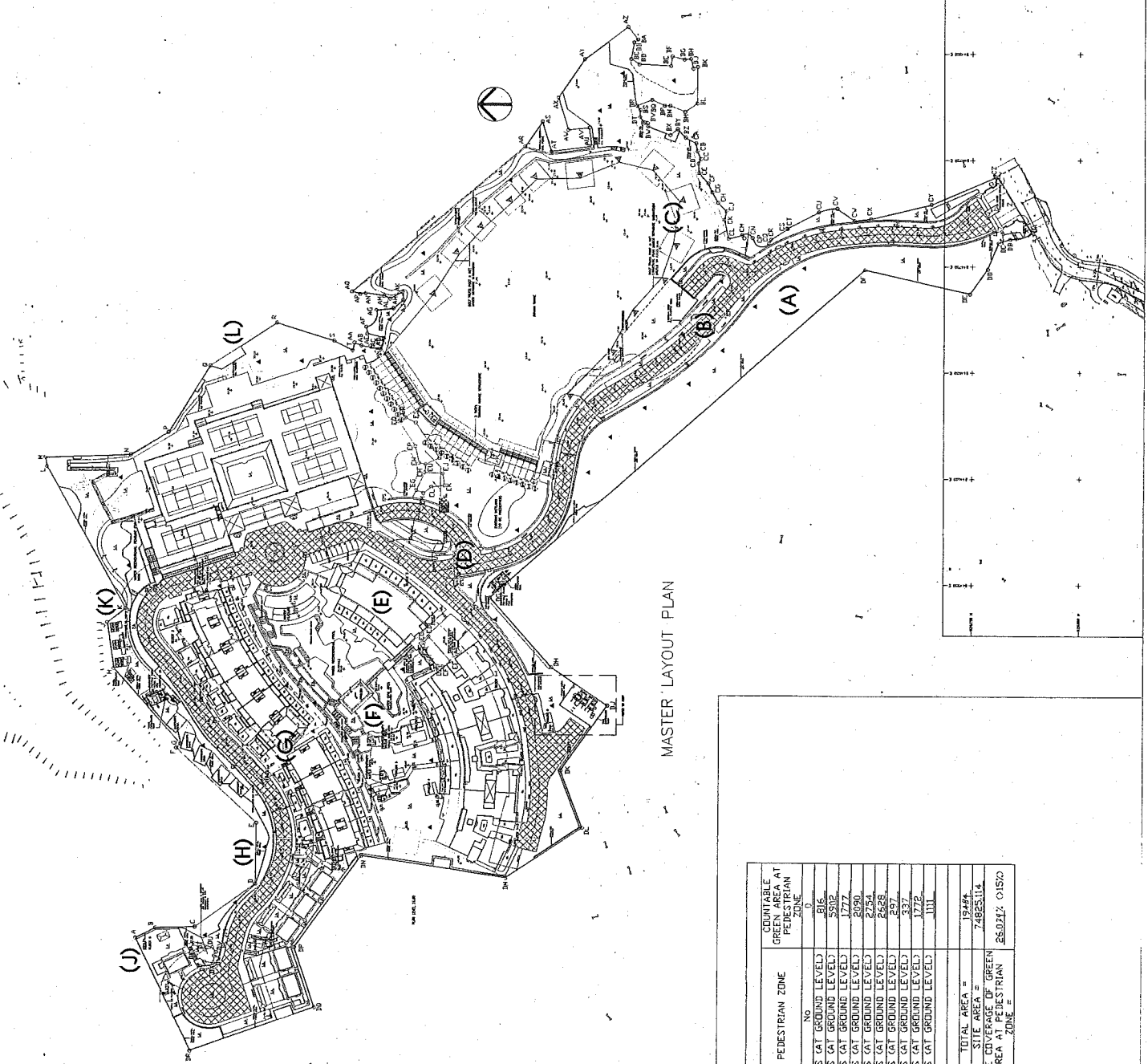

LEGEND:
 GRASS
 IRRIGATION POINT

SUMMARY OF GREENERY

GREENERY	AREA	NATURE*	REDUCTION FACTOR	COUNTABLE AREA	PEDESTRIAN ZONE	COUNTABLE AT PEDESTRIAN ZONE
A	5264	0	N/A	5264	NO	0
B	4502	1	N/A	4502	YES (AT GROUND LEVEL)	4502
C	1717	2	N/A	1717	YES (AT GROUND LEVEL)	3502
D	2090	1	N/A	2090	YES (AT GROUND LEVEL)	2090
E	2754	2	N/A	2754	YES (AT GROUND LEVEL)	2754
F	2628	1	N/A	2628	YES (AT GROUND LEVEL)	2628
G	297	2	N/A	297	YES (AT GROUND LEVEL)	297
H	337	1	N/A	337	YES (AT GROUND LEVEL)	337
J	1772	2	N/A	1772	YES (AT GROUND LEVEL)	1772
L	1011	2	N/A	1011	YES (AT GROUND LEVEL)	1011
				TOTAL AREA = 25748	TOTAL AREA = 19474	19474
				SITE AREA = 7482314	SITE COVERAGE OF GREEN AREA AT PEDESTRIAN ZONE = 0.302	7482314
				SITE COVERAGE OF GREEN AREA AT PEDESTRIAN ZONE = 0.261		0.261

*NATURE OF GREENERY
 1. Horizontal Greenery
 2. Vertical Greenery
 3. Water feature
 4. Grass cover
 5. Landscaping
 6. Landscape Support retaining wall with gradient steeper than 45°

STATEMENT II: The works shown on these plans are Type II works in respect of which the Building Authority's consent is applied for.

RECORD PLAN

BD 2/9041/08
 P.A.D. REFERENCE: FP 8/28857 (1*)
 W.C.O. REFERENCE:
 C.A.D. REFERENCE:

NOTES:

ID	REVISIONS	DATE	BY
(A)	GENERAL REVISION	2011/08	
(B)	GENERAL REVISION	2011/12	LAU
(C)	GENERAL REVISION	2012/04	SZ
(D)	GENERAL REVISION	2012/09	RY
(E)	GENERAL REVISION	2012/12	RY
(F)	GENERAL REVISION	2013/03	RY
(G)	GENERAL REVISION	2013/08	SZ
(H)	GENERAL REVISION	2014/02	HK
(J)	GENERAL REVISION	2014/07	SZ
(L)	GENERAL REVISION	2014/11	HK



- Donnie Lau Wing-shing 劉景生 JP
- Alvin Wong Wing-shing 王冠生
- Henry Lau King-oh 劉景浩
- Chang Kwong-keung 張國強
- Alvin Au Kwong-keung 區國強
- David Chan Chik-ung 陳錫榮
- Joseph Tang Chun-king 鄧振榮
- Phyllis Au Young Ming-see 歐陽明翠
- Caroline Fung Siu-yan 馮秀恩
- Michelle Fung Wing-ling 馮雁翎
- David Chan Yung-ying 陳永英

Plan Approved
 4 JUL 2014

PROPOSED GOLF AND TENNIS ACADEMY WITH ANCILLARY OVERNIGHT ACCOMMODATION AT LOT. NO. 1199, PAK KONG, SAI KUNG

SCALE: 1:1000 (A0)
 DATE: 2011-07

DRAWN BY: SZ
 CHECKED BY: AA

SCALE: 1:1000 (A0)
 DATE: 2011-07

JOB NO.: N1308
 DRAWING NO.: A221

FOR BD APPROVAL