

G/F AREA DIAGRAM
SCALE 1:250

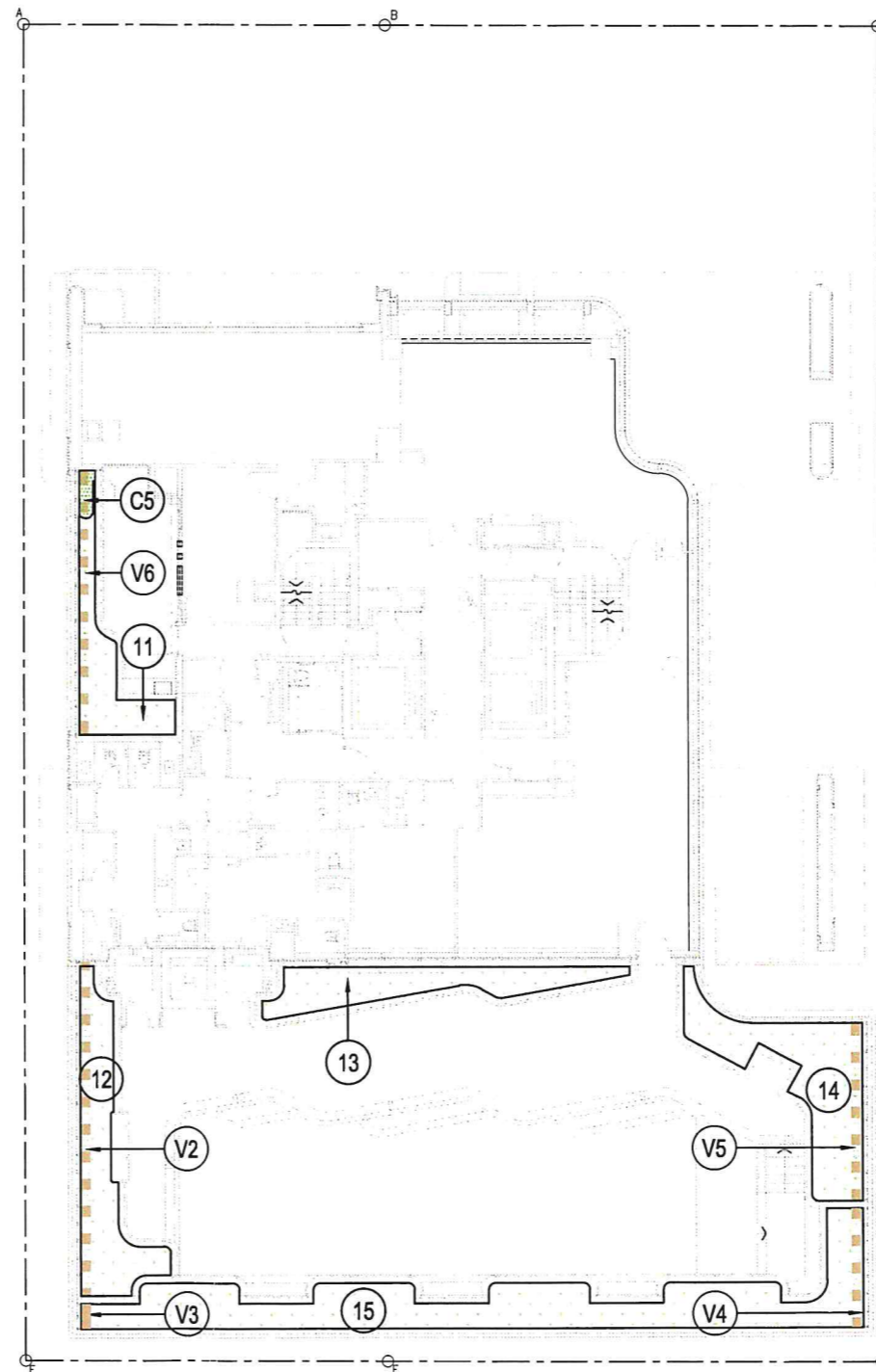

1/F AREA DIAGRAM
SCALE 1:250

- This drawing and the contents herein are the copyright of LWK & Partners (HK) Ltd.
- No part of the drawing and the design contained herein may be reproduced without the prior written consent of a director of LWK & Partners (HK) Ltd.
- Do not take measurements directly from this drawing.
- Check and verify all dimensions on site.
- Read this drawing in conjunction with the specifications and all other related drawings.
- Notify the Architect immediately of any discrepancy found herein.

Client
NOBLE POWER ENTERPRISES LTD.

Project
**PROPOSED RESIDENTIAL DEVELOPMENT
AT K.I.L. 11230,
NO. 233 PRINCE EDWARD ROAD WEST,
KOWLOON**

Drawing Title
**SUSTAINABLE BUILDING DESIGN SCHEDULE
OF GREENERY AREA CALCULATION**

Job No.	Drawing No.	Revision No.
3891	SK-01	-
Scale	Date	CAD Ref.
A.S. (A3)	2019 SEPT	
Drawn	Checked	Approved
JL	AC	PN

**LWK
+ PARTNERS**

15/F, North Tower, World Finance Centre, Harbour City, Tsim Sha Tsui, Kowloon.
T: 852-2574 1633 F: 852-2572 4908 E: lwk@lwkp.com
梁黃顯建築師(香港)事務所有限公司
九龍尖沙咀海港城環球金融中心北座15樓

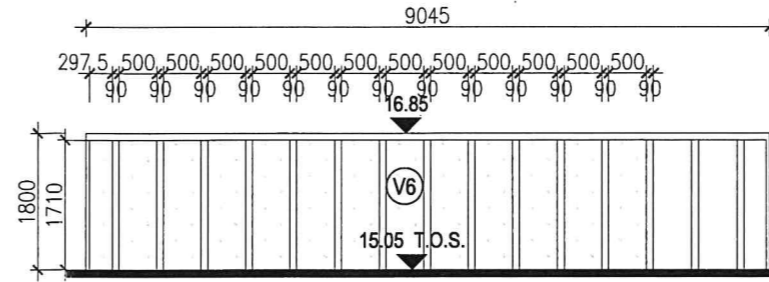
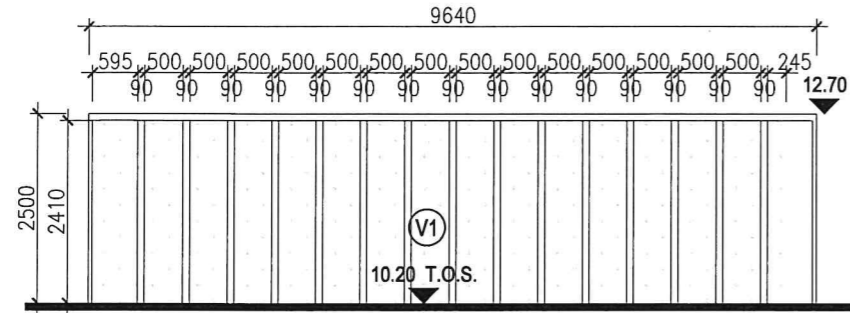

DIAGRAMMATIC ELEVATION FOR VERTICAL GREENING AREA (WIRED TYPE)

SCALE 1:100

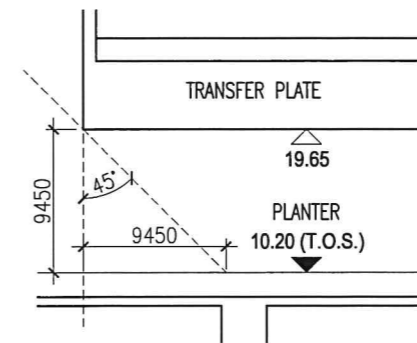
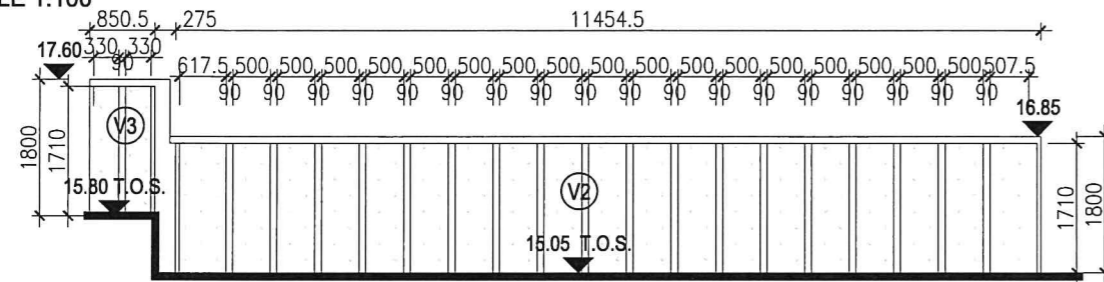

TYPICAL SECTION FOR COVERED GREENERY AREA

SCALE 1:50

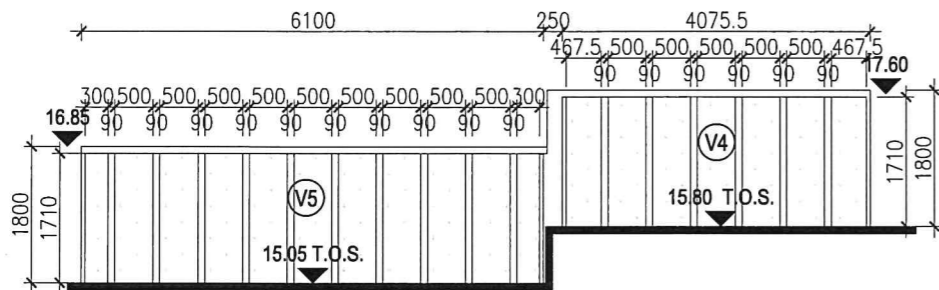

DIAGRAMMATIC ELEVATION FOR VERTICAL GREENING AREA (WIRED TYPE)

SCALE 1:100

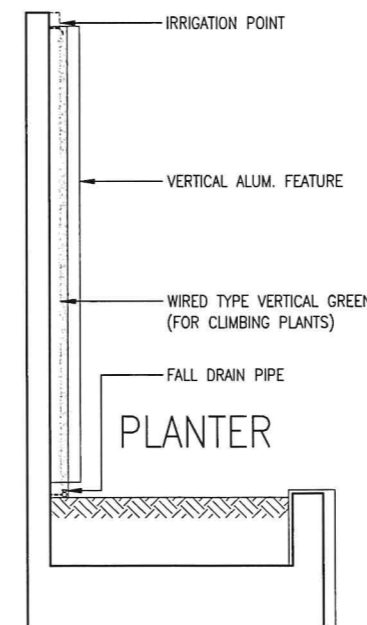

TYPICAL SECTION FOR WIRED TYPE VERTICAL GREEN (FOR CLIMBING PLANTS)

SCALE 1:50

- This drawing and the contents herein are the copyright of LWK & Partners (HK) Ltd.
- No part of the drawing and the design contained herein may be reproduced without the prior written consent of a director of LWK & Partners (HK) Ltd.
- Do not take measurements directly from this drawing.
- Check and verify all dimensions on site.
- Read this drawing in conjunction with the specifications and all other related drawings.
- Notify the Architect immediately of any discrepancy found herein.

Client
NOBLE POWER ENTERPRISES LTD.

Project
PROPOSED RESIDENTIAL DEVELOPMENT AT K.I.L. 11230, NO. 233 PRINCE EDWARD ROAD WEST, KOWLOON

Drawing Title
SUSTAINABLE BUILDING DESIGN SCHEDULE OF GREENERY AREA CALCULATION

Job No.	Drawing No.	Revision No.
3891	SK-02	-
Scale	Date	CAD Ref.
A.S. (A3)	2019 SEPT	
Drawn	Checked	Approved
JL	AC	PN

LWK + PARTNERS

15/F, North Tower, World Finance Centre, Harbour City, Tsim Sha Tsui, Kowloon.
T: 852-2574 1633 F: 852-2572 4908 E: lwk@lwkp.com
梁黃顯建築師(香港)事務所有限公司
九龍尖沙咀海港城環球金融中心北座15樓

PLANTING AREA AT PRIMARY ZONE:

1 =	1.729 s.m.
2 =	1.063 s.m.
3 =	7.673 s.m.
4 =	14.344 s.m.
5 =	21.728 s.m.
5A =	4.703 s.m.
6 =	8.915 s.m.
7 =	2.020 s.m.
8 =	7.935 s.m.
9 =	12.723 s.m.
9A =	0.279 s.m.
10 =	6.189 s.m.
11 =	9.030 s.m.
12 =	14.811 s.m.
13 =	11.656 s.m.
14 =	17.350 s.m.
15 =	36.829 s.m.
16 =	10.792 s.m.

TOTAL = 189.769 s.m.

COVERED PLANTING AREA AT PRIMARY ZONE:

C1 =	7.76 s.m.
C2 =	13.505 s.m.
C3 =	2.944 s.m.
C4 =	3.851 s.m.
C5 =	0.804 s.m.
C6 =	5.341 s.m.

SUB TOTAL = 34.205 s.m.

REDUCTION FACTOR : 50%

TOTAL = 17.103 s.m.

VERTICAL GREENERY AREA AT PRIMARY ZONE:

V1 =	0.595(W.) x 2.410(H.) x 1 + 0.500(W.) x 2.410(H.) x 14	
	+ 0.245(W.) x 2.410(H.) x 1	= 18.894 s.m.
V2 =	0.618(W.) x 1.710(H.) x 1 + 0.500(W.) x 1.710(H.) x 17	
	+ 0.508(W.) x 1.710(H.) x 1	= 16.460 s.m.
V3 =	0.330(W.) x 1.710(H.) x 2	= 1.129 s.m.
V4 =	0.468(W.) x 1.710(H.) x 2 + 0.500(W.) x 1.710(H.) x 5	= 5.876 s.m.
V5 =	0.300(W.) x 1.710(H.) x 2 + 0.500(W.) x 1.710(H.) x 9	= 8.721 s.m.
V6 =	0.298(W.) x 1.710(H.) x 1 + 0.500(W.) x 1.710(H.) x 12	= 10.770 s.m.

SUB TOTAL = 61.850 s.m.

SITE COVERAGE OF GREENERY CALCULATION:

GREENERY AREA CALCULATION

SITE AREA	=	1340.100 s.m.	<	20000 s.m.
MINIMUM OVERALL SITE COVERAGE OF GREENERY	=	20% (1340.100 x 20% = 268.020)		
MINIMUM GREENERY AREA AT PRIMARY ZONE	=	10% (1340.100 x 10% = 134.001)		
MAXIMUM GREENING FEATURES AREA	=	30% OF TOTAL REQUIRED GREENERY AREA (268.020 x 30% = 80.406)		

GREENING FEATURES :

ACTUAL SITE COVERAGE OF GREENING FEATURES	=	$\frac{17.103 + 61.850}{\text{TOTAL REQUIRED GREENERY AREA}}$	x 100%
	=	$\frac{78.952}{268.020}$	x 100%
	=	29.458 %	< 30% MAX. OF THE TOTAL REQUIRED GREENERY AREA

COVERAGE OF GREENERY ON PRIMARY ZONE:

ACTUAL SITE COVERAGE OF GREENERY	=	$\frac{189.769 + 78.952}{\text{SITE AREA}}$	x 100%
	=	$\frac{268.721}{1340.100}$	x 100%
	=	20.052 %	> 10% (REQUIRED COVERAGE ON PRIMARY ZONE)

SITE COVERAGE OF GREENERY :

ACTUAL SITE COVERAGE OF GREENERY	=	$\frac{189.769 + 78.952}{\text{SITE AREA}}$	x 100%
	=	$\frac{268.721}{1340.100}$	x 100%
	=	20.052 %	> 20% (REQUIRED TOTAL SITE COVERAGE OF GREENERY)

- This drawing and the contents herein are the copyright of LWK & Partners (HK) Ltd.
 - No part of the drawing and the design contained herein may be reproduced without the prior written consent of a director of LWK & Partners (HK) Ltd.
 - Do not take measurements directly from this drawing.
 - Check and verify all dimensions on site.
 - Read this drawing in conjunction with the specifications and all other related drawings.
 - Notify the Architect immediately of any discrepancy found herein.

Client
NOBLE POWER ENTERPRISES LTD.

Project
PROPOSED RESIDENTIAL DEVELOPMENT AT K.I.L. 11230, NO. 233 PRINCE EDWARD ROAD WEST, KOWLOON

Drawing Title
SUSTAINABLE BUILDING DESIGN SCHEDULE OF GREENERY AREA CALCULATION

Job No.	Drawing No.	Revision No.
3891	SK-03	-
Scale	Date	CAD Ref.
A.S. (A3)	2019 SEPT	
Drawn	Checked	Approved
JL	AC	PN

LWK + PARTNERS

15/F, North Tower, World Finance Centre, Harbour City, Tsim Sha Tsui, Kowloon.
 T: 852-2574 1633 F: 852-2572 4908 E: lwk@lwkp.com
 梁黃顛建築師(香港)事務所有限公司
 九龍尖沙咀海港城環球金融中心北座15樓