

NO.	REVISIONS	DATE	BY
A	GENERAL REVISION	11/2017	
B	GENERAL REVISION	05/2018	
C	GENERAL REVISION	09/2018	
D	GENERAL REVISION	05/2019	
E	GENERAL REVISION	04/2020	
F	GENERAL REVISION	04/2021	
H	GENERAL REVISION	09/2021	

NO.	REVISIONS	DATE	BY
A	GENERAL REVISION	11/2017	
B	GENERAL REVISION	05/2018	
C	GENERAL REVISION	09/2018	
D	GENERAL REVISION	05/2019	
E	GENERAL REVISION	04/2020	
F	GENERAL REVISION	04/2021	
H	GENERAL REVISION	09/2021	



I hereby certify this drawing is a true copy of its original.  
 Lau King Chu Henry  
 Authorized Person  
 Reg. No. AN(A) 85/91

**RECORD PLAN**

DLN Architects Limited  
 LAU KING CHU HENRY  
 Reg. No. AN(A) 85/91

ALL MEASUREMENTS TO BE CHECKED AT THE WORK BY THE CONTRACTOR.  
 PROPOSED RESIDENTIAL AND NON-INDUSTRIAL DEVELOPMENT AT 7 MUK TAI STREET, NKL 6565

PROJECT: GREENERY DIAGRAMS  
 SCALE: 1:200(AD)  
 DATE: 15 AUGUST 2017  
 DRAWN BY: SZ  
 CHECKED BY: H.L.  
 JOB NO.: N2335-H  
 DRAWING NO.: 2-42E

FOR OFFICIAL USE  
 Note: This plan has been prepared on a certified check basis under the controlled processing system as provided in the ADAM-19. The duties of the authorized person, registered structural engineer and/or registered architectural engineer concerned are specified under section 4(3)(b) and the provision of section 14(2)(c) of the Building Ordinance are of particular relevance in this regard.  
 Plan Approved  
 Senior Building Supervisor  
 for BUILDING AUTHORITY  
 22 OCT 2021

STATEMENT II: This work shall be done in accordance with the provisions of the Building Ordinance and the Building (Administration) Regulation.  
 AMENDED  
 29 SEPT 2021

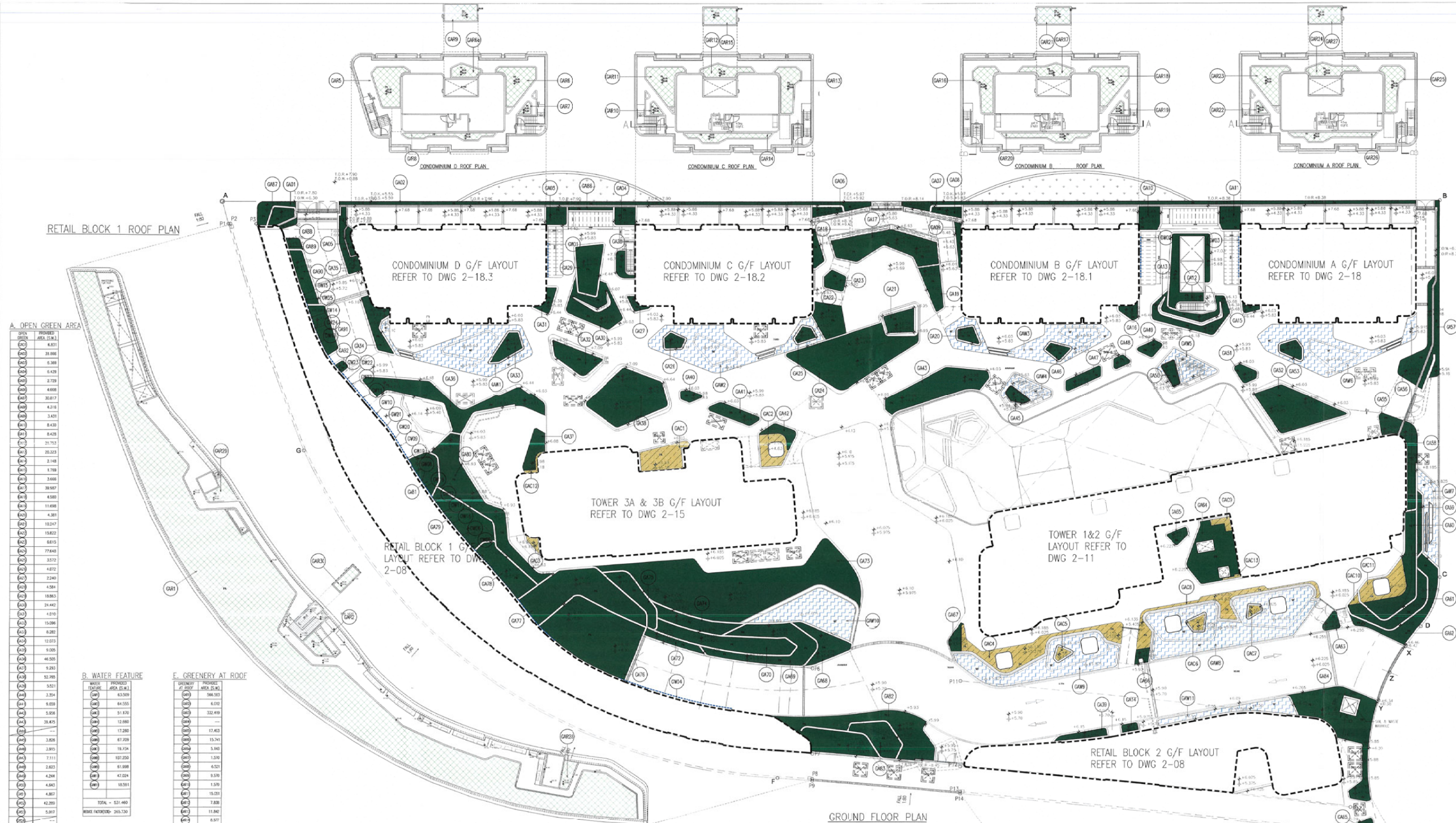

A. OPEN GREEN AREA

NO.	AREA (S.M.)
1	4.831
2	28.886
3	6.389
4	6.429
5	2.729
6	30.817
7	31.713
8	4.218
9	3.431
10	8.430
11	9.409
12	31.123
13	20.313
14	2.148
15	1.788
16	3.668
17	38.987
18	4.880
19	11.688
20	4.381
21	19.217
22	15.822
23	8.615
24	77.848
25	35.712
26	4.872
27	2.240
28	4.284
29	18.863
30	21.442
31	4.010
32	15.086
33	8.282
34	12.013
35	9.106
36	46.505
37	9.293
38	52.795
39	5.511
40	2.374
41	8.833
42	5.208
43	38.475
44	3.828
45	3.828
46	7.111
47	2.823
48	4.284
49	47.024
50	4.643
51	4.867
52	42.289
53	5.917
54	6.381
55	16.546
56	10.338
57	15.014
58	4.414
59	27.434
60	18.248
61	23.821
62	3.811
63	2.138
64	3.263
65	1.763
66	21.741
67	5.383
68	9.578
69	34.871
70	1.887
71	39.889
72	1.481
73	0.743
74	371.623
75	15.782
76	14.617
77	88.852
78	43.327
79	22.322
80	21.948
81	38.804
82	13.822
83	73.563
84	18.280
85	38.386
86	4.462
87	2.294
88	3.888
89	1.220
90	3.267
91	11.472
92	13.143
93	1.463
94	13.739
95	1816.584

B. WATER FEATURE

NO.	AREA (S.M.)
1	63.509
2	6.018
3	31.176
4	13.880
5	17.463
6	15.741
7	5.143
8	1.516
9	6.521
10	5.516
11	1.516
12	15.023
13	7.838
14	11.842
15	6.317
16	5.310
17	7.838
18	8.571
19	5.310
20	21.741
21	7.779
22	4.287
23	1.481
24	7.838
25	0.743
26	371.623
27	112.494
28	16.947

C. COVERED GREENERY

NO.	AREA (S.M.)
1	1.531
2	11.842
3	8.571
4	15.010
5	7.838
6	5.310
7	11.842
8	8.571
9	21.741
10	5.383
11	9.578
12	34.871
13	1.887
14	39.889
15	1.481
16	0.743
17	371.623
18	112.494
19	16.947

D. VERTICAL GREEN

NO.	AREA (S.M.)
1	12.172
2	8.691
3	19.776
4	4.119
5	6.371
6	12.071
7	6.190
8	19.110
9	6.371
10	381.716

ELEVATION GW5 - 25

NO.	AREA (S.M.)
1	1.531
2	11.842
3	8.571
4	15.010
5	7.838
6	5.310
7	11.842
8	8.571
9	21.741
10	5.383
11	9.578
12	34.871
13	1.887
14	39.889
15	1.481
16	0.743
17	371.623
18	112.494
19	16.947

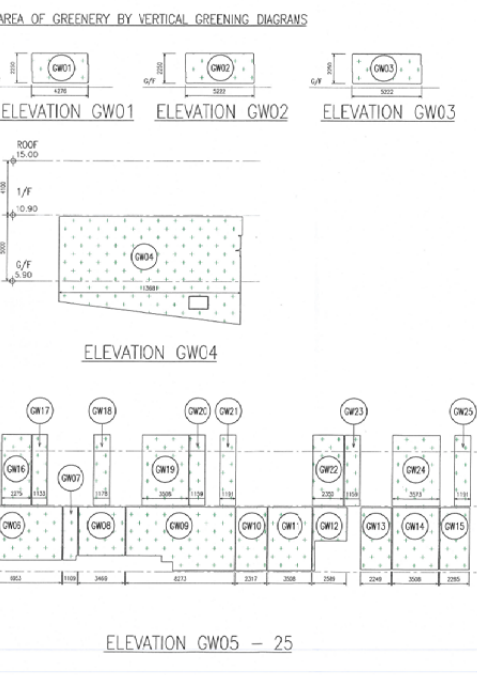

FOR B.D. SUBMISSION  
 REFER TO PNAP APP 152 PARA 18.  
 AREA OF SITE = 11262 m<sup>2</sup> < 20000 m<sup>2</sup>  
 THE MINIMUM SITE COVERAGE GREENERY FOR PRIMARY ZONE  
 REQUIRED = 11262 x 10% = 1126.200 m<sup>2</sup>  
 THE MINIMUM SITE COVERAGE GREENERY FOR OVERALL  
 REQUIRED = 11262 x 20% = 2252.400 m<sup>2</sup>  
 GREENING FEATURE PROVISION - MAXIMUM 30% OF REQUIRED GREENERY AREA  
 (11262 X 20%) X 33% = 675.720 m<sup>2</sup>  
 GREENING FEATURE PROVISION  
 (B + C + D)  
 = (285.730 + 56.247 + 391.759) = 713.736 m<sup>2</sup>  
 713.736 < 675.720. THUS, ONLY 675.720 m<sup>2</sup> WILL BE COUNTED  
 AS GREENING FEATURE PROVISION (G.F.P.)  
 TOTAL GREENERY PROVIDED AT PRIMARY ZONE  
 (A + G.F.P.)  
 = (1616.504 + 675.720) = 2292.224 m<sup>2</sup>  
 % OF GREENERY SITE COVERAGE AT PRIMARY ZONE  
 2292.224 m<sup>2</sup> / 11262 m<sup>2</sup> x 100%  
 20.354% > 10%  
 THUS, REQUIREMENT FULFILLED.  
 OVERALL TOTAL GREENERY PROVIDED  
 (A + G.F.P. + E)  
 = (1616.504 + 675.720 + 1149.954) = 3442.178 m<sup>2</sup>  
 % OF GREENERY SITE COVERAGE FOR OVERALL  
 3442.178 m<sup>2</sup> / 11262 m<sup>2</sup> x 100%  
 30.583% > 20%  
 THUS, REQUIREMENT FULFILLED.

FOR LEASE REQUIREMENT  
 S.C. (11)(b)(i) NOT LESS THAN 30% OF THE AREA OF THE LOT SHALL BE PLANTED WITH PLANTS  
 = 11262 x 30% = 3378.600 m<sup>2</sup>  
 OVERALL GREENERY AREA PROVIDED  
 (A + B + C + D + E)  
 = (1616.504 + 265.730 + 56.247 + 391.759 + 1149.954) = 3480.194 m<sup>2</sup>  
 % OF GREENERY SITE COVERAGE FOR OVERALL  
 3480.194 m<sup>2</sup> / 11262 m<sup>2</sup> x 100%  
 30.922% (> 30% OF TOTAL AREA OF THE LOT)  
 THUS, REQUIREMENT FULFILLED.  
 (11)(b)(ii) NOT LESS THAN 66% OF THE 30% SHALL BE VISIBLE TO PEDESTRIANS  
 = 3480.194 x 66% = 2296.928 m<sup>2</sup>  
 TOTAL GREENERY PROVIDED AT PRIMARY ZONE  
 (A + B + C + D)  
 = (1616.504 + 265.730 + 56.247 + 391.759) = 2330.240 m<sup>2</sup>  
 % OF GREENERY SITE COVERAGE AT PRIMARY ZONE  
 2330.240 m<sup>2</sup> / 3480.194 m<sup>2</sup> x 100%  
 66.957% > 66%  
 THUS, REQUIREMENT FULFILLED.  
 S.C. (11)(b)(iii) NOT LESS THAN 20% OF THE ROOF AREA OF ANY BUILDING OR BUILDINGS SHALL FORM PART OF 30% (MENTIONED ABOVE)  
 TOTAL ROOF AREA = 4516.182 m<sup>2</sup> (REFER TO DWG 2-19)  
 REQUIRED GREENERY ON ROOF:  
 4516.182 x 20% = 903.236 m<sup>2</sup>  
 OVERALL GREENERY AREA PROVIDED AT ROOF (E)  
 = 1149.954 m<sup>2</sup> / 4516.182 m<sup>2</sup> x 100%  
 = 25.463% (> 20% OF TOTAL ROOF AREA)  
 THUS, REQUIREMENT FULFILLED.

