

BASEMENT FLOOR PLAN

SCALE 1 : 200

REVISIONS :			PROJECT :		ARCHI+
NO.	DESCRIPTION	DATE	PROPOSED REDEVELOPMENT AT 23 PO SHAN ROAD, HONG KONG I.L. 6435 & EXTENSION		
			DRAWING TITLE :		ARCHIPLUS INTERNATIONAL (HK) LIMITED
THE COPYRIGHT IN THIS DRAWING IS RETAINED BY ARCHI+ WHOSE CONSENT MUST BE OBTAINED BEFORE ANY USE OR REPRODUCTION IN WHOLE OR IN PART CAN BE MADE. DO NOT SCALE DRAWING. ALL DIMENSIONS ARE IN MILLIMETER EXCEPT OTHERWISE NOTED.			BASEMENT FLOOR PLAN (SITE COVERAGE OF GREENERY)		
			DATE : Aug 2022	SCALE : A.S.	PROJECT NO. : 910
			DRAWN : AIL	PAPER SIZE : A3	DWG. NO. : SCG-01 -

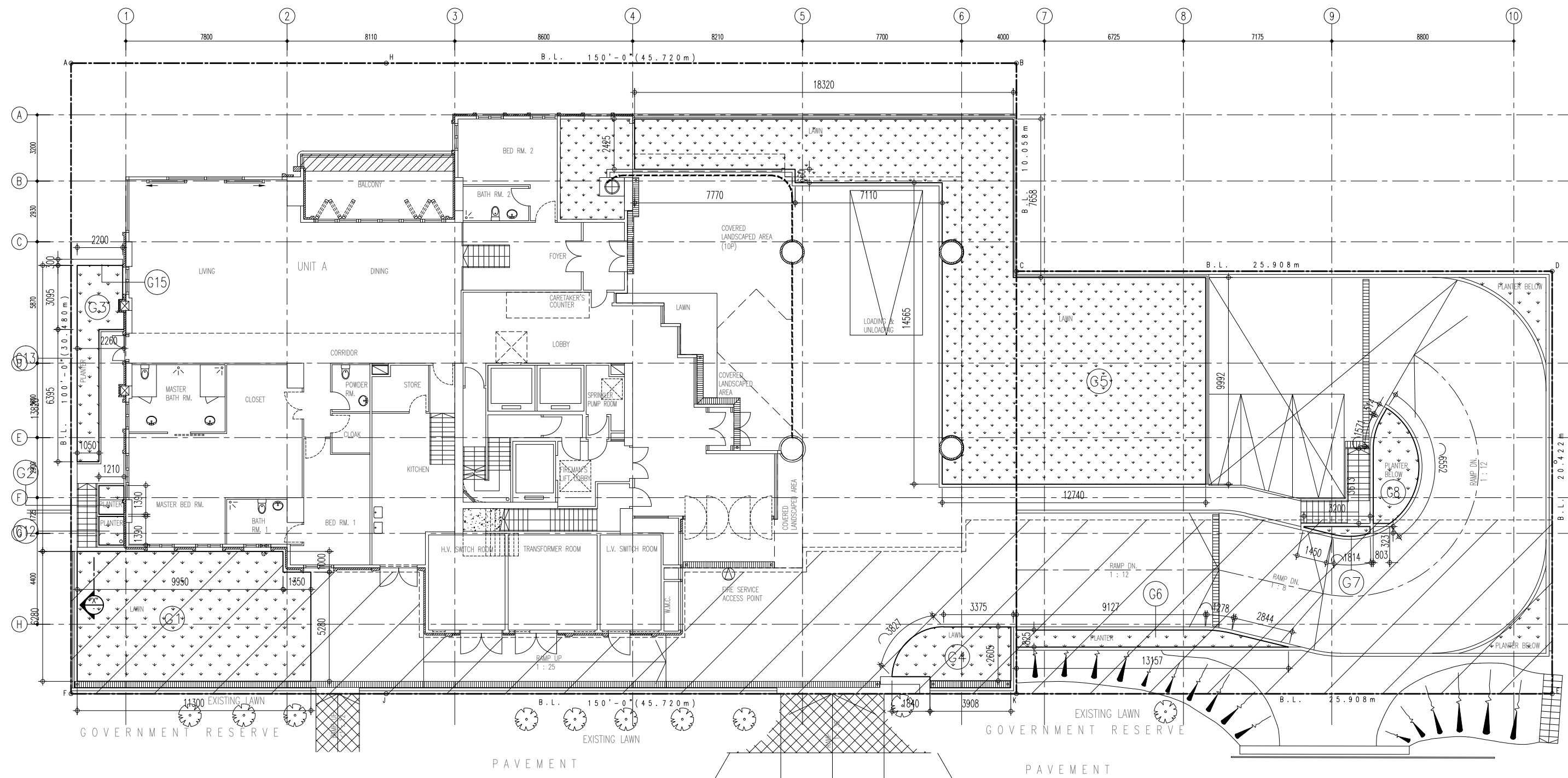

GROUND FLOOR PLAN

SCALE 1 : 200

P O S H A N R O A D

REVISIONS :			PROJECT :		ARCHI+
NO.	DESCRIPTION	DATE	PROPOSED REDEVELOPMENT AT 23 PO SHAN ROAD, HONG KONG I.L. 6435 & EXTENSION		
			DRAWING TITLE :		ARCHIPLUS INTERNATIONAL (HK) LIMITED
THE COPYRIGHT IN THIS DRAWING IS RETAINED BY ARCHI+ WHOSE CONSENT MUST BE OBTAINED BEFORE ANY USE OR REPRODUCTION IN WHOLE OR IN PART CAN BE MADE. DO NOT SCALE DRAWING. ALL DIMENSIONS ARE IN MILLIMETER EXCEPT OTHERWISE NOTED.			GROUND FLOOR PLAN (SITE COVERAGE OF GREENERY)		
			DATE : Aug 2022	SCALE : A.S.	PROJECT NO. : 910
			DRAWN : AIL	PAPER SIZE : A3	DWG. NO. : SCG-02 -

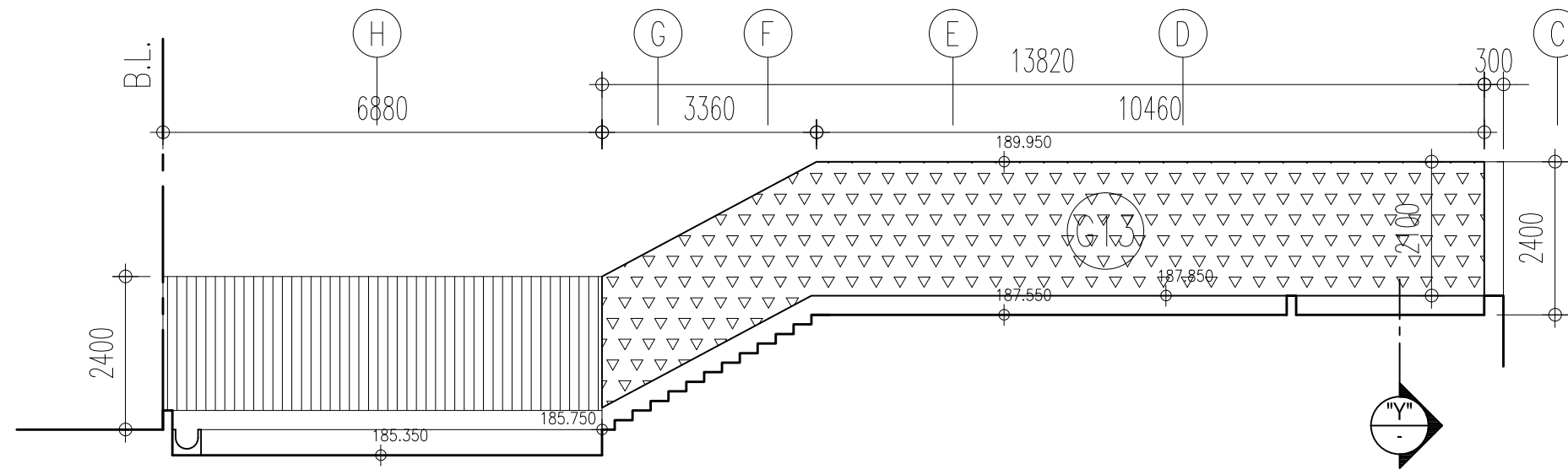

ELEVATION "X"
FOR VERTICAL GREEN AT G/F

SCALE 1 : 100

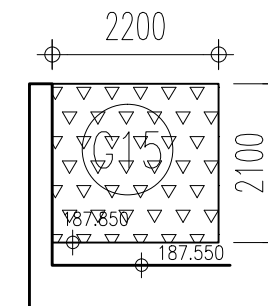

ELEVATION "Y"
FOR VERTICAL GREEN AT G/F

SCALE 1 : 100

SITE COVERAGE OF GREENERY CALCULATION
(IN ACCORDANCE WITH PNAP APP-152, APPENDIX G)

SITE AREA = 1922.629m² > 1,000m²

MINIMUM SITE COVERAGE OF GREENERY AT PEDESTRIAN ZONE
= 10% OF SITE AREA
= 1922.629m² x 10%
= 192.263m²

MINIMUM TOTAL SITE COVERAGE OF GREENERY
= 20% OF SITE AREA
= 1922.629m² x 20%
= 384.526m²

MINIMUM GREENING AREA REQUIRED OTHER THAN GREENING FEATURES
= 384.526m² x 70%
= 269.168m²

AREA FOR GREENING FEATURES
= 384.526m² x 30%
= 115.358m²

GREENING FEATURE PROVIDED :

G13 = 28.880 m²
G15 = 4.620 m²

TOTAL = 33.500 m² < 115.358m²

SITE COVERAGE OF GREENERY AT PEDESTRIAN ZONE PROVIDED

G1 = 69.614 m²
G2 = 1.673 m²
G3 = 13.455 m²
G4 = 13.260 m²
G5 = 192.393 m²
G6 = 9.440 m²
G12 = 1.682 m²

SUB-TOTAL = 301.517 m² > 192.263m²

G7 = 1.069 m²
G8 = 9.401 m²
G9 = 5.437 m²
G10 = 5.437 m²
G11 = 28.611 m²
G13 = 28.880 m²
G15 = 4.620 m²

SUB-TOTAL = 384.972 m² > 384.526m²

REVISIONS :			PROJECT :		ARCHI+
NO.	DESCRIPTION	DATE	PROPOSED REDEVELOPMENT AT 23 PO SHAN ROAD, HONG KONG I.L. 6435 & EXTENSION		
					ARCHIPLUS INTERNATIONAL (HK) LIMITED
THE COPYRIGHT IN THIS DRAWING IS RETAINED BY ARCHI+ WHOSE CONSENT MUST BE OBTAINED BEFORE ANY USE OR REPRODUCTION IN WHOLE OR IN PART CAN BE MADE. DO NOT SCALE DRAWING. ALL DIMENSIONS ARE IN MILLIMETER EXCEPT OTHERWISE NOTED.			DRAWING TITLE : ELEVATION (SITE COVERAGE OF GREENERY)		PROJECT NO. : 910
			DATE : Aug 2022	SCALE : A.S.	
			DRAWN : AIL	PAPER SIZE : A3	DWG. NO. : SCG-03 -