

GREENERY AREA CALCULATION

PEDESTRIAN ZONE GREENERY CALCULATION

LG1 PLANTER AREA

- ① = 171.030 m²
- ② = 67.430 m²
- TOTAL = 238.460 m²

LG2 PLANTER AREA

- ④ = 65.860 m²
- TOTAL = 65.860 m²

UPPER LEVEL OF LG2 PLANTER AREA

- ⑤ = 4.560 m²
- ⑥ = 92.360 m²
- TOTAL = 96.920 m²

LG3 PLANTER AREA

- ⑦ = 35.470 m²

G/F PLANTER AREA

- ⑧ = 75.610 m²
- ⑨ = 19.920 m²
- ⑩ = 82.610 m²
- ⑪ = 27.120 m²
- TOTAL = 205.260 m²

⑳ G/F VERTICAL GREENING
CLIMBING PLANTS ON FENCE WALL = 3 m²

TOTAL PEDESTRIAN ZONE GREENERY CALCULATION:
238.46 + 65.86 + 96.92 + 35.47 + 205.26 + 3.00
= 644.97
PERCENTAGE = 644.97/6440=10.02%

COMMUNAL GREENERY AREA CALCULATION

PLANTER AREA

- ⑫ = 161.020 m²
- ⑬ = 34.350 m²
- ⑭ = 13.800 m²
- ⑮ = 26.150 m²
- ⑯ + ⑰ = 131.300 m²
- ⑱ = 125.160 m²
- ⑲ + ⑳ = 181.290 m²

VERTICAL GREENING ON FENCE WALL

- ㉑ = 31.130 m²
- ㉒ = 68.360 m²

TOTAL = 647.400 m²
PERCENTAGE = 647.400/6440=10.05%

SITE AREA	SITE COVERAGE OF GREENERY		
	PEDESTRIAN ZONE	OTHER LOCATIONS	TOTAL GREENERY AREAS
1,000<6440<20,000m ²	10.02>10%	10.05%	20.07>20%

COMMUNAL GREENERY AREA 1:400

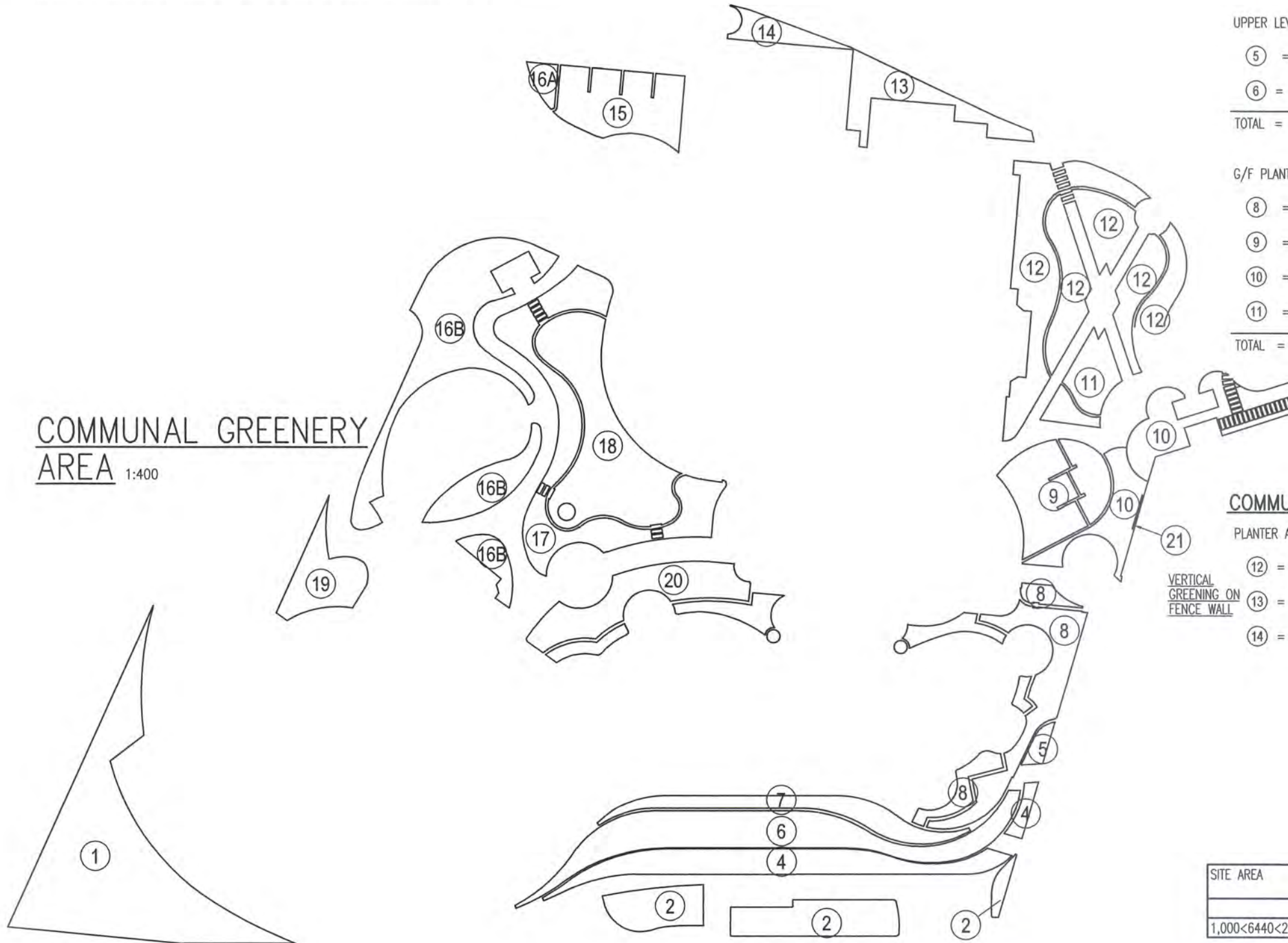

PEDESTRIAN ZONE GREENERY AREA 1:400

The works shown on these plans are Type II works (General Building Works) in respect of which consent is applied for the purpose of Fast Track consent application under regulation 33 of the Building (Administration) Regulations.

14 JAN 2019

TO BD

AMENDMENT