

THE WORKS SHOWN ON THESE PLANS ARE TYPE II WORKS BUILDING IN RESPECT OF WHICH CONSENT IS APPLIED FOR THE PURPOSE OF FAST TRACK CONSENT APPLICATION UNDER REGULATION 33 OF THE BUILDING (ADMINISTRATIVE) REGULATIONS.

RECORD PLAN

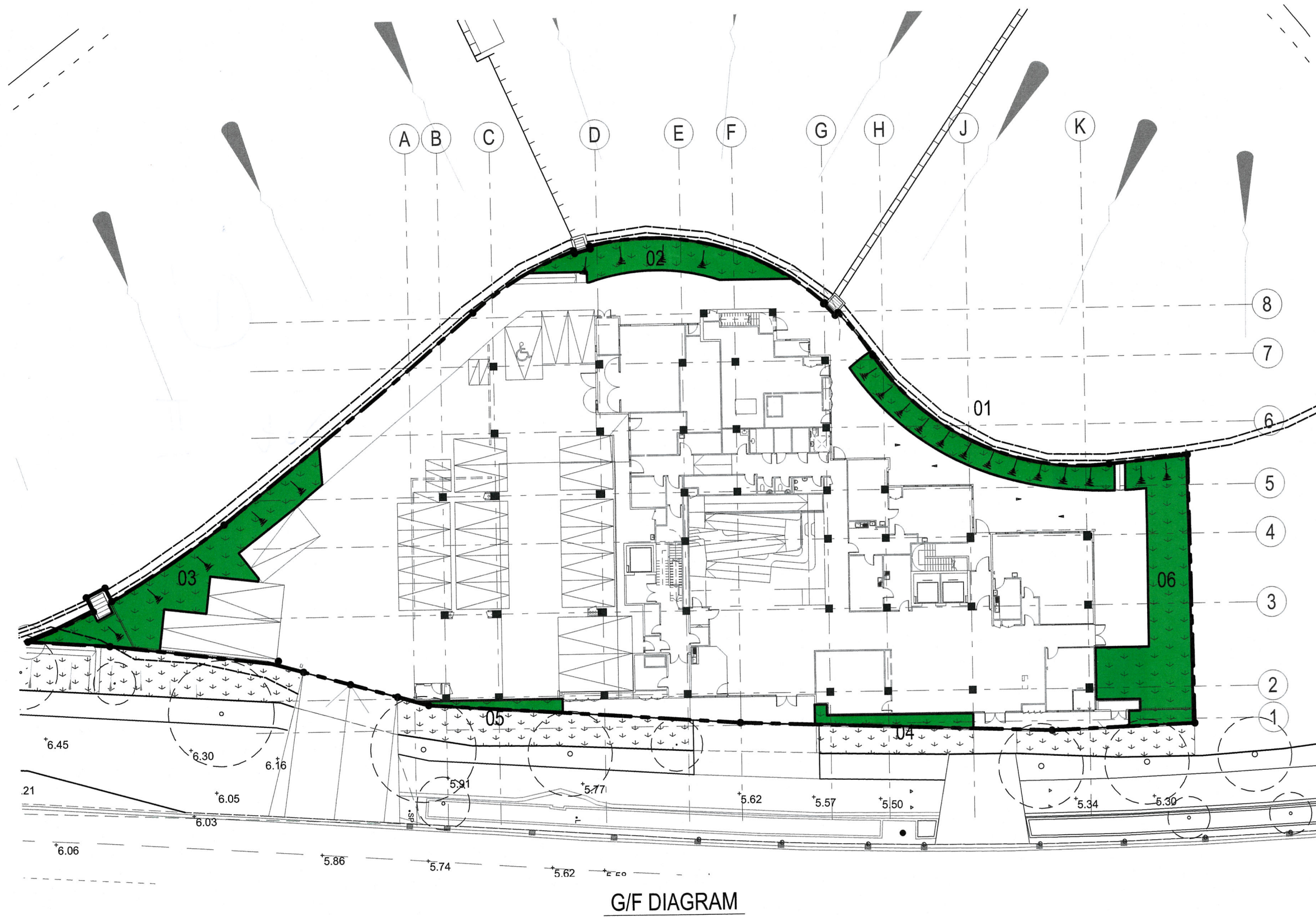

G/F GREENERY CALCULATION

PLANTER AREAS :

01	=	64 m ²
02	=	59 m ²
03	=	113 m ²
04	=	17 m ²
05	=	11 m ²
06	=	133 m ²
TOTAL		397 m²

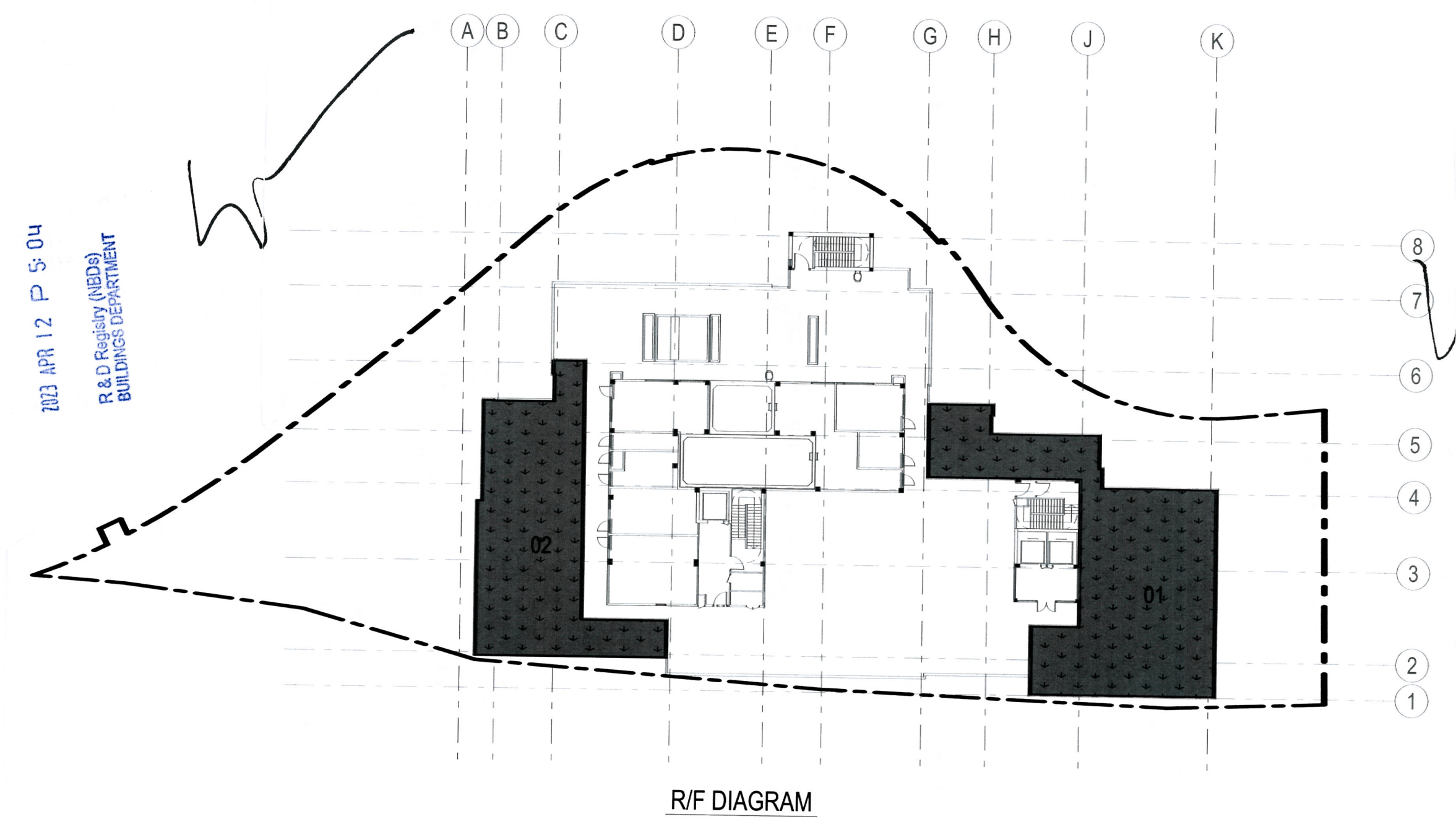

R/F GREENERY CALCULATION

PLANTER AREAS :

01	=	297 m ²
02	=	225 m ²
TOTAL		522 m²

SITE COVERAGE OF GREENERY

1. AREA OF THE SITE = 3087 m²
2. TOTAL GREENERY AREA REQUIRED = 3087 m² X 20% = 617.4 m²

PROPOSED GREENERY AREA FOR THE WHOLE SITE

G/F GREENERY AREA	=	397 m ²
R/F GREENERY AREA	=	522 m ²
TOTAL	=	919 m²

TOTAL GREENERY SITE COVERAGE FOR THE WHOLE SITE = $919 \text{ m}^2 / 3087 \text{ m}^2 \times 100\% = 29.802\% > 20\%$

3. TOTAL GREENERY AREA AT PRIMARY ZONE = 3087 m² X 10% = 308.7 m²

PROPOSED GREENERY AREA AT PRIMARY ZONE

G/F GREENERY AREA	=	397 m ²
-------------------	---	--------------------

TOTAL SITE COVERAGE OF GREENERY AT PRIMARY ZONE = $397 \text{ m}^2 / 3087 \text{ m}^2 \times 100\% = 12.893\% > 10\%$

RECEIVED BY
2023 APR 12 P 5:04
R & D Facility (NEDs)
BUILDINGS DEPARTMENT

F	04-2023	GBP AMENDMENT
E	06-2022	GBP AMENDMENT
D	08-2021	GBP AMENDMENT
C	01-2021	GBP RE-SUBMISSION
B	08-2020	GBP RE-SUBMISSION
A	06-2020	GBP SUBMISSION
REV	DATE	AMENDMENT

PROJECT
SOCIETY FOR THE PREVENTION OF
CRUELTY TO ANIMALS - ANIMAL WELFARE
AND EDUCATION CENTRE IN TSING YI

DRAWING TITLE
SUSTAINABLE BUILDING DESIGN AREA
CALCULATIONS

SCALE 1:400@A1

DRAWING NO. C013
REV. NO. F

SOURCE -

P&T Architects Limited
巴馬丹拿建築師有限公司
www.p-t-group.com T: 852-2575 6575

AP's SIGNATURE & STAMP CHOP

AMENDED PLAN
12-04-2023

B.D. COPY

(Signature)
CHAN CHO SING JOEL
Authorized Person (Architect)

BD's OFFICIAL USE

Note: This plan has been processed on a curtailed check basis under the centralized processing system as promulgated in PNAP ADM-19. The duties of the authorized person, registered structural engineer and/or registered geotechnical engineer concerned as specified under section 4(3)(b) and the provision of section 14(2)(c) of the Buildings Ordinance are of particular relevance in this regard.

Plan Approved

(Signature)
WONG Wing-chi, Vickie
Senior Building Surveyor
for BUILDING AUTHORITY
10 MAY 2023