

GREENERY AREA CALCULATION & DIAGRAM

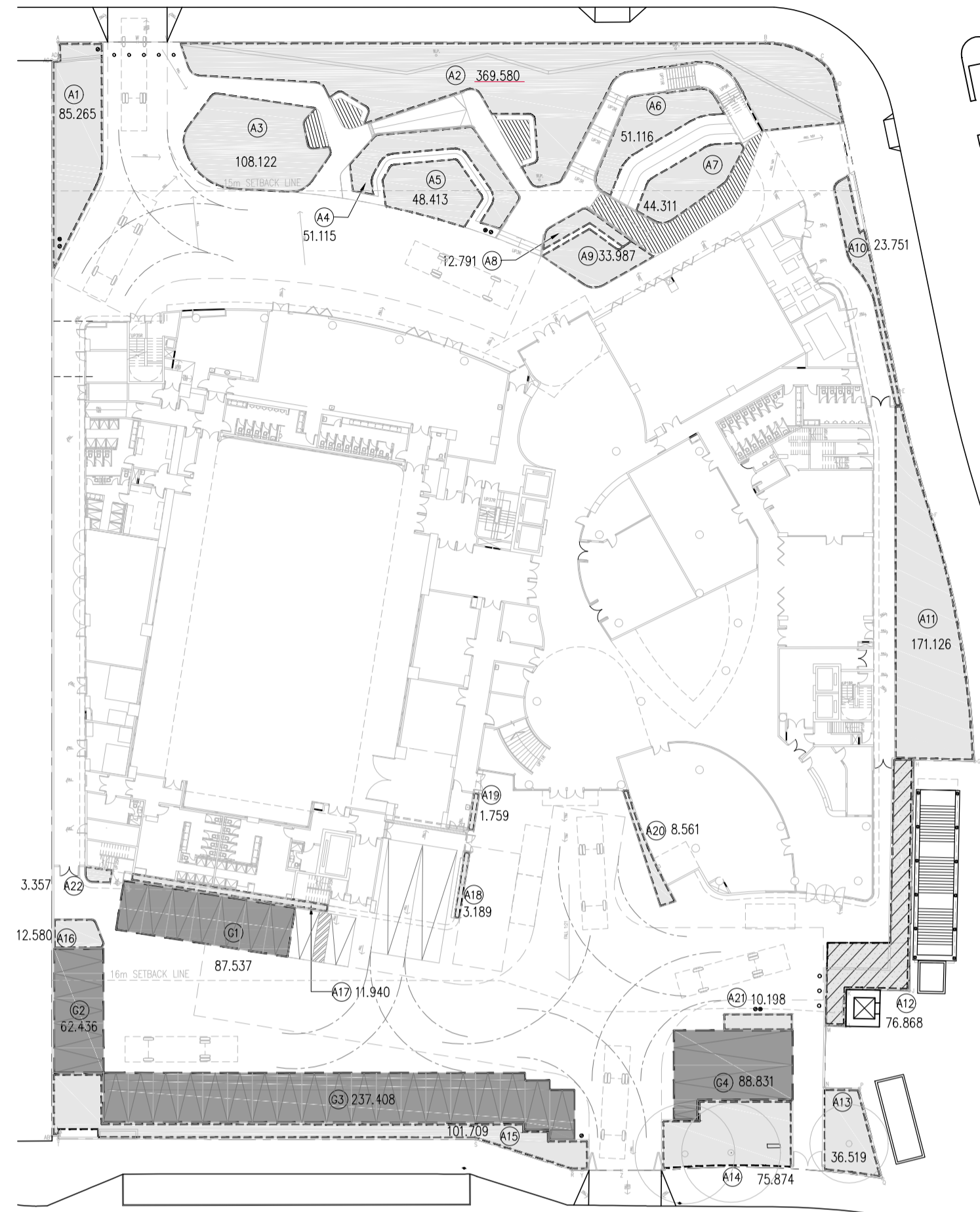

G/F GREENERY DIAGRAM



2/F GREENERY DIAGRAM

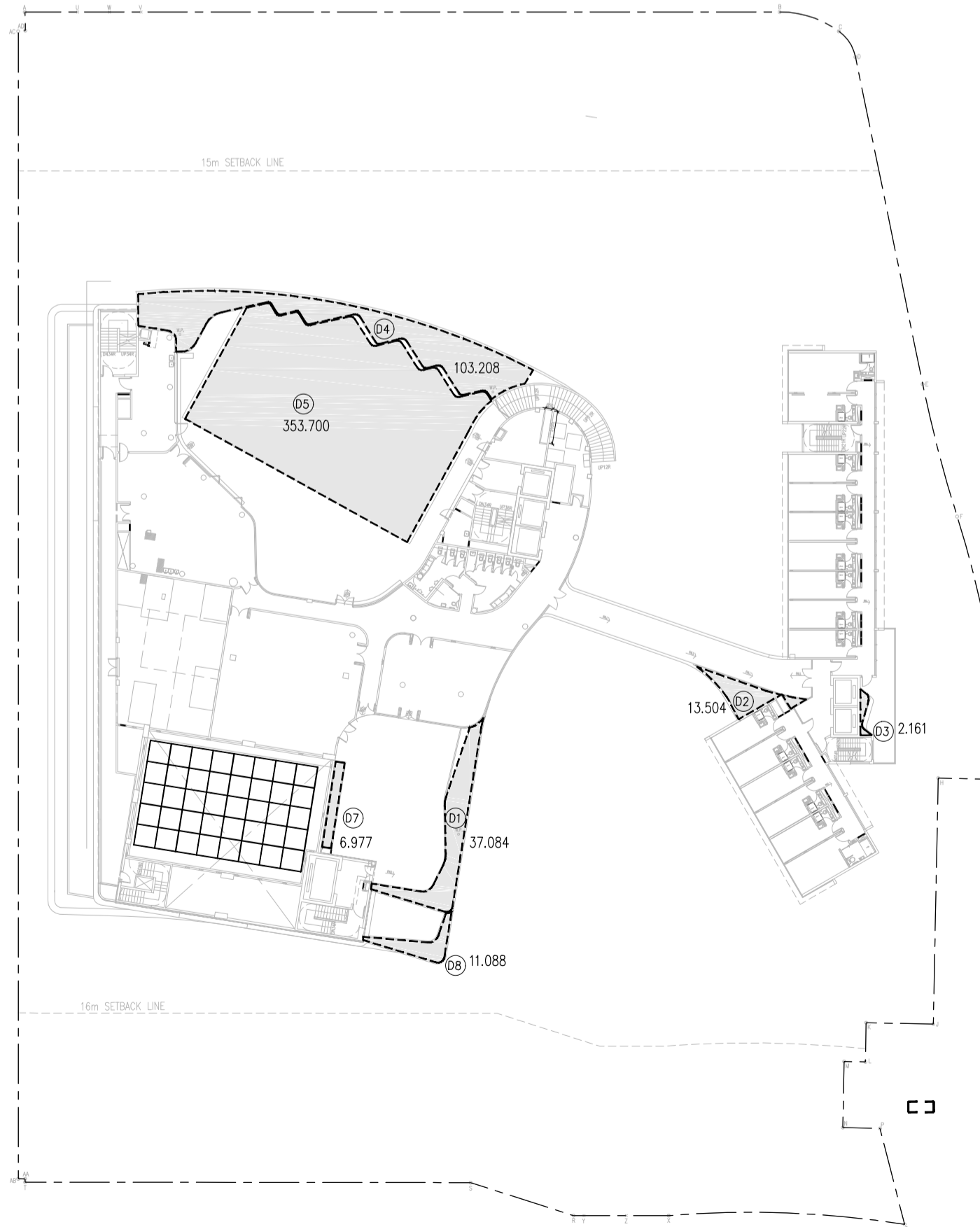

3/F GREENERY DIAGRAM

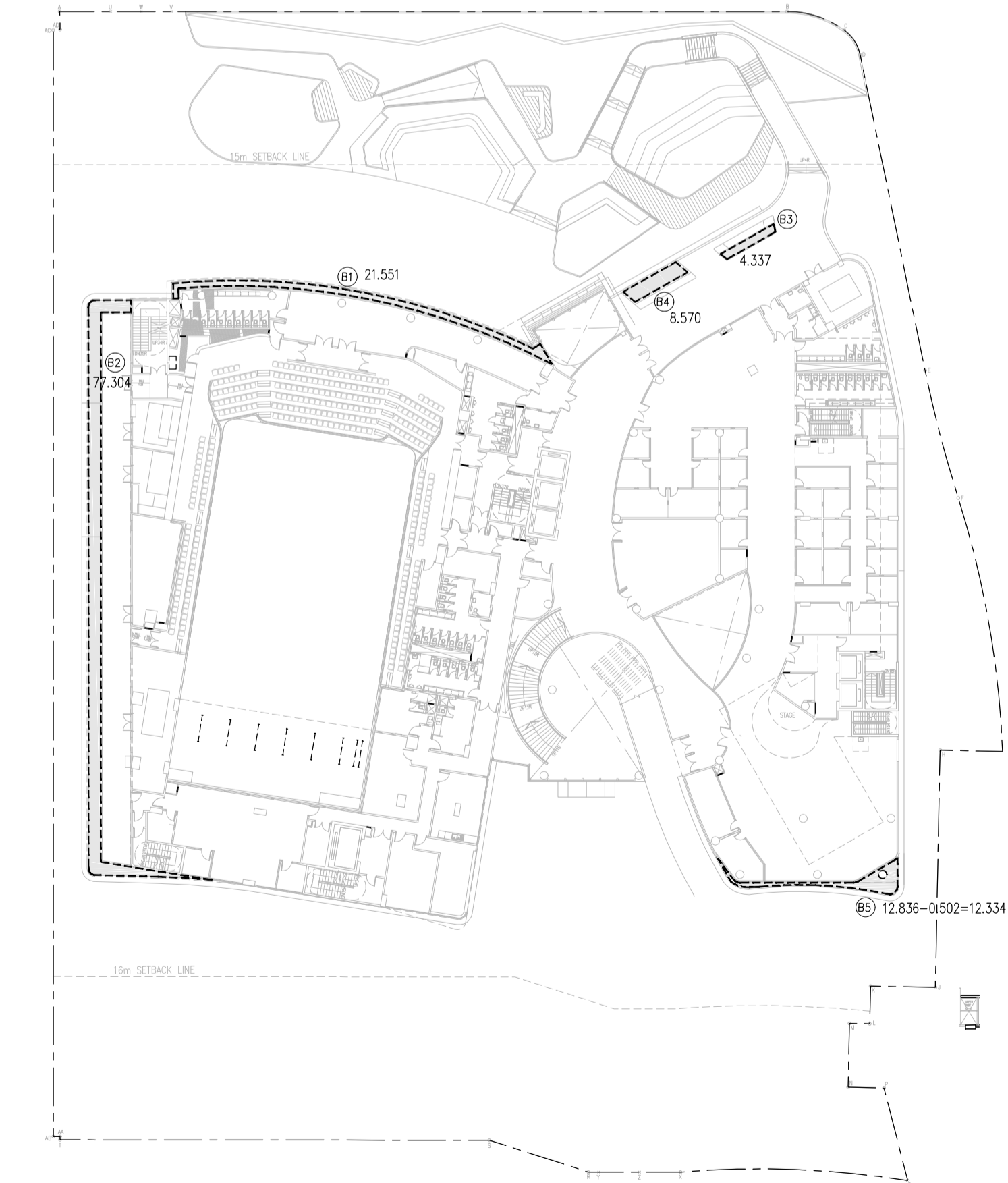

1/F GREENERY DIAGRAM

G/F GREENERY CALCULATION (PEDESTRIAN ZONE)

(A1) PLANTER	=	85.265 m ²
(A2) PLANTER	=	369.580 m ²
(A3) PLANTER	=	108.122 m ²
(A4) PLANTER	=	51.115 m ²
(A5) PLANTER	=	48.413 m ²
(A6) PLANTER	=	51.116 m ²
(A7) PLANTER	=	44.528 m ²
(A8) PLANTER	=	12.791 m ²
(A9) PLANTER	=	33.987 m ²
(A10) PLANTER	=	23.751 m ²
(A11) PLANTER	=	172.954 m ²
(A12) PLANTER	=	76.868 m ²
(A13) PLANTER	=	36.519 m ²
(A14) PLANTER	=	75.874 m ²
(A15) PLANTER	=	101.708 m ²
(A16) PLANTER	=	12.580 m ²
(A17) PLANTER	=	11.940 m ²
(A18) PLANTER	=	3.189 m ²
(A19) PLANTER	=	1.759 m ²
(A20) PLANTER	=	8.561 m ²
(A21) PLANTER	=	10.198 m ²
(A22) PLANTER	=	3.357 m ²
TOTAL	=	1344.176 m²

1/F GREENERY CALCULATION

(B1) PLANTER	=	21.551 m ²
(B2) PLANTER	=	77.304 m ²
(B3) PLANTER	=	4.337 m ²
(B4) PLANTER	=	8.570 m ²
(B5) PLANTER	=	12.334 m ²
TOTAL	=	124.096 m²

2/F GREENERY CALCULATION

(C1) PLANTER	=	34.865 m ²
(C2) PLANTER	=	30.102 m ²
(C3) PLANTER	=	103.284 m ²
(C4) PLANTER	=	94.642 m ²
(C5) PLANTER	=	6.401 m ²
(C6) PLANTER	=	3.982 m ²
(C7) PLANTER	=	41.570 m ²
(C8) PLANTER	=	32.079 m ²
(C9) PLANTER	=	24.302 m ²
TOTAL	=	371.227 m²

PEDESTRIAN ZONE OF GREENERY AREA CALCULATION (FOR PD)

G/F GREENERY CALCULATION (GRASSCRETE ONLY)

(G1) GRASSCRETE	=	87.531 m ²
(G2) GRASSCRETE	=	62.436 m ²
(G3) GRASSCRETE	=	237.408 m ²
(G4) GRASSCRETE	=	88.831 m ²
TOTAL	=	476.206 m²

G/F	=	1344.176 m ²	>	953.800 S.M.
G/F GRASSCRETE ONLY	=	476.206 m ²		
TOTAL	=	1820.382 m²		

TOTAL GREENERY AREA CALCULATION

G/F	=	1820.382 m ²		
1/F	=	124.096 m ²		
2/F	=	371.227 m ²		
3/F	=	518.110 m ²		
R/F	=	308.451 m ²		
TOTAL	=	3142.266 m²	>	1,907.600 S.M.

3/F GREENERY CALCULATION

(D1) PLANTER	=	37.084 m ²
(D2) PLANTER	=	13.504 m ²
(D3) PLANTER	=	2.161 m ²
(D4) PLANTER	=	103.208 m ²
(D5) PLANTER	=	353.700 m ²
(D6) PLANTER	=	8.453 m ²
(D7) PLANTER	=	6.977 m ²
TOTAL	=	518.110 m²

R/F GREENERY CALCULATION

(E1) PLANTER	=	14.947 m ²
(E2) PLANTER	=	2.749 m ²
(E3) PLANTER	=	37.396 m ²
(E4) PLANTER	=	20.001 m ²
(E5) PLANTER	=	40.341 m ²
(E6) PLANTER	=	17.931 m ²
(E7) PLANTER	=	91.166 m ²
(E8) PLANTER	=	51.512 m ²
(E9) PLANTER	=	23.424 m ²
(E10) PLANTER	=	8.984 m ²
TOTAL	=	308.451 m²

GREENERY AREA CALCULATION (G/F TO R/F)

GREENERY AREA REQ. = 9,538.000 S.M.
 SITE AREA = 1,907.600 S.M.
 20% OF SITE AREA = 381.520 S.M.

PEDESTRIAN ZONE OF GREENERY AREA CALCULATION
 MIN. 10% OF SITE AREA = 190.760 S.M.

PEDESTRIAN ZONE OF GREENERY AREA CALCULATION (FOR BD)
 G/F = 1,344.176 m² > 953.800 S.M.

TOTAL GREENERY AREA CALCULATION (FOR BD)
 G/F = 1,344.176 m²
 1/F = 124.096 m²
 2/F = 371.227 m²
 3/F = 518.110 m²
 R/F = 308.451 m²
TOTAL = 2,666.060 m² > 1,907.600 S.M.

BD REF. NO. : BD 2/4059/17
 FSD REF. NO. : FP 8/31040

REV. i	2022.09.15	BD 7TH AMENDMENT SUBMISSION
REV. h	2022.06.02	BD 6TH AMENDMENT SUBMISSION
REV. g	2022.03.08	BD 5TH AMENDMENT SUBMISSION
REV. f	2021.06.21	BD 4TH AMENDMENT SUBMISSION
REV. e	2020.09.08	BD 3RD AMENDMENT SUBMISSION
REV. d	2020.03.30	BD 2ND AMENDMENT SUBMISSION
REV. c	2019.09.23	BD 1ST AMENDMENT RE-SUBMISSION
REV. b	2019.05.24	BD 1ST AMENDMENT SUBMISSION
REV. a	2018.01.15	BD 1ST SUBMISSION

NUMBER	DATE	AMENDMENT
--------	------	-----------



PROJECT
 PROPOSED YOUTH CENTER AND HOSTEL DEVELOPMENT
 AT JUNCTION OF KING FUK STREET, KAI SUN ROAD
 AND TSAT PO STREET, SAN PO KONG
 KOWLOON

DRAWING
 CALCULATION '8'
 GREENERY CALCULATION

SCALE	JOB NUMBER	
1:500 @A1	5644	
DATE	DRAWING NUMBER	
2021.06	218	
- a b c d e f g h i		
DESIGNED	CHECKED	APPROVED

• ALL DIMENSIONS ARE IN MILLIMETRES UNLESS OTHERWISE NOTED
 • DO NOT SCALE DRAWING
 • ALL MEASUREMENTS SHOULD BE VERIFIED ON SITE
 THE OWNERSHIP OF THE COPYRIGHT OF THIS DRAWING IS RETAINED BY P&T ARCHITECTS AND ENGINEERS LTD. WRITING CONSENT MUST BE OBTAINED BEFORE ANY USE OR REPRODUCTION OF THE DRAWING OR ANY PART THEREOF CAN BE MADE.

BD'S OFFICIAL USE

THE WORKS SHOWN ON THESE PLANS ARE TYPE II WORKS (BUILDING) IN RESPECT OF WHICH CONSENT IS APPLIED FOR THE PURPOSE OF FAST TRACK CONSENT APPLICATION UNDER REGULATION 33 OF THE BUILDING (ADMINISTRATIVE) REGULATIONS.

CHOW YUEN SAI Esther
 Authorized Person (Architect)
 AP (A) 99/00

BD COPY

AMENDED PLAN
 DATE : 2022.09.15