

LEGEND.

IHP INSPECTION HATCH PANEL
AT CEILING LEVEL

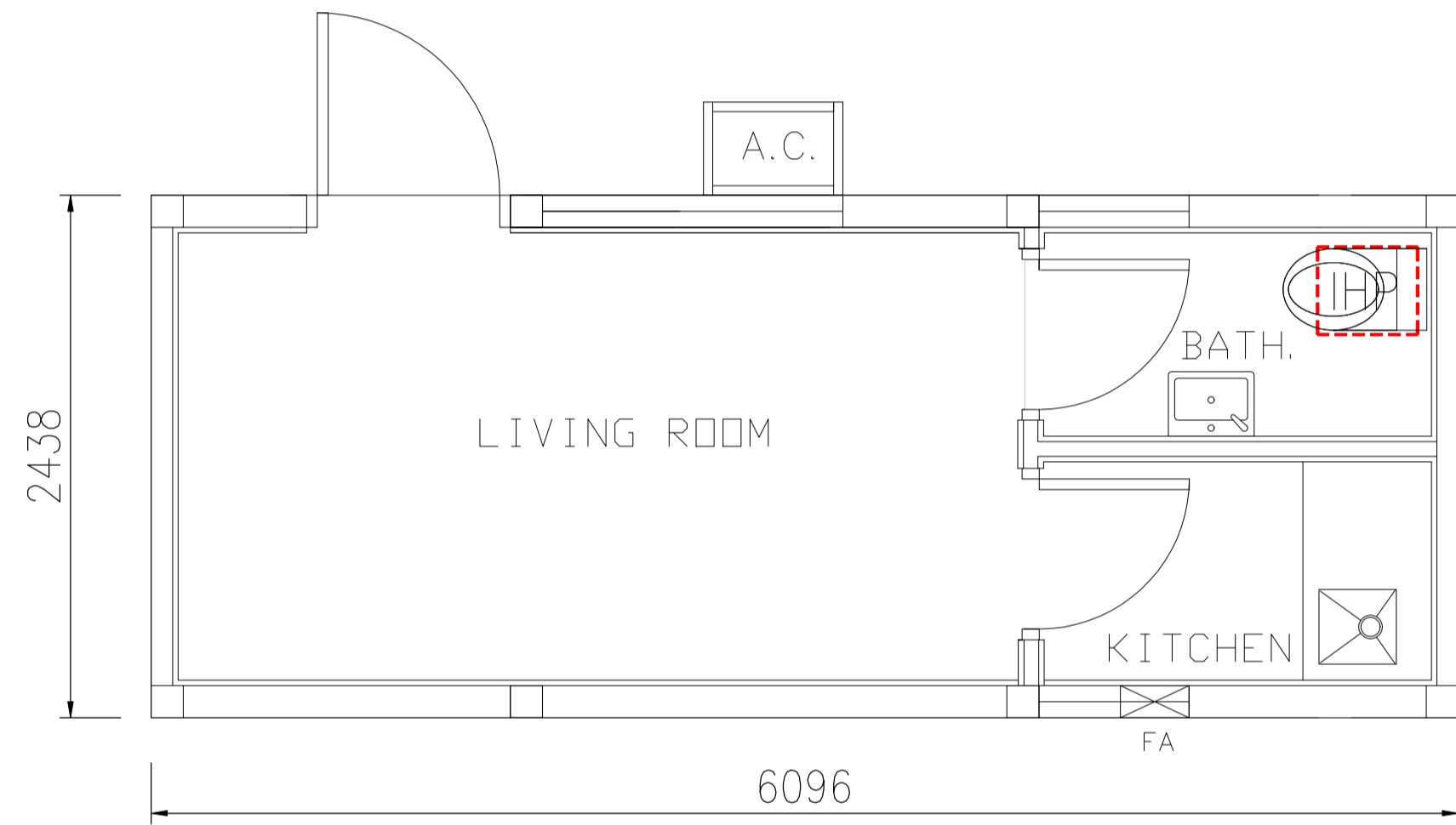

MODULE NO.: TYPE I

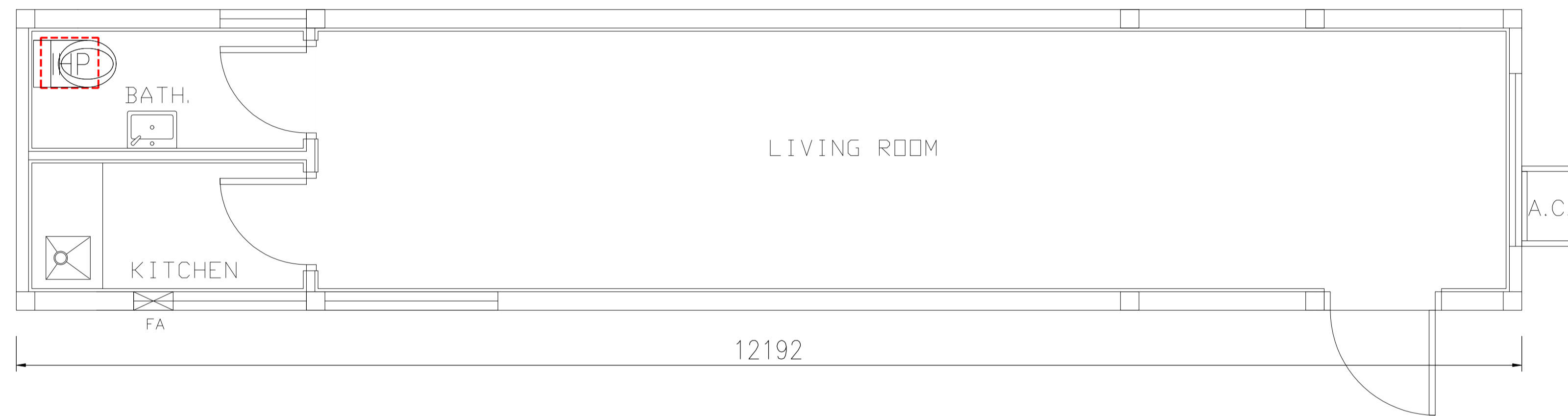

MODULE NO.: TYPE II

B.D. REF.

F.S.D. REF.

- NOTES:
- DO NOT SCALE THIS DRAWING.
 - FIGURED DIMENSIONS ARE TO BE FOLLOWED.
 - READ THIS DRAWING IN CONJUNCTION WITH THE ARCHITECTS SPECIFICATION & CONDITION OF CONTRACT.
 - THIS DRAWING SHALL NOT BE USED FOR CONSTRUCTION PURPOSES UNLESS OTHERWISE CERTIFIED.
 - THIS DRAWING AND DESIGN ARE COPYRIGHT AND NO PORTION MAY BE REPRODUCED WITHOUT THE WRITTEN PERMISSION OF THE ARCHITECTS.

REV.	DATE	DESCRIPTION

MAIN CONTRACTOR

Techoy
德材
BUILD FOR MORE

2/F, CENTRE 600, 82 KING LAM STREET, LAI CHI KOK, KOWLOON.
HONG KONG TEL: 2529 9333 FAX: 2529 9898

MIC SUPPLIER

NOVA TECHOY
德材路華
組裝合成建築有限公司
Modular Construction Co., Ltd.

2/F, CENTRE 600, 82 KING LAM STREET, LAI CHI KOK, KOWLOON.
HONG KONG TEL: 2529 9333 FAX: 2529 9898

AUTHORIZED PERSON

OIYN LTD
建築顧問、設計

3/F, BLOCK A, CHEONG FAT FACTORY BUILDING, NO.268-271 UN CHAU STREET, KLN
TEL: 3489-1990 FAX: 3020-9409

REGISTERED STRUCTURAL ENGINEER

WILSON & ASSOCIATES LIMITED

ROOM 1805, NEW TECH PLAZA, 34 TAI YAU STREET TEL: 3619-0932 FAX: 3619-0931

BUILDING SERVICES ENGINEER

MECS
CONSULTING ENGINEERS

2/F, NORTH GATE COMMERCIAL BUILDING,
281-283 HING HOI NORTH POKE, HONG KONG
TEL: 3879 8888 FAX: 3886 5188
E-MAIL: MEC@MECS.COM.HK

PROJECT:

**MODULAR INTEGRATED CONSTRUCTION (MIC)
STEEL MIC FOR LOW RISE BUILDING
(MODEL NO.: NTMCCLHK12A19)**

DRAWING TITLE:

**TYPICAL MODULE PLAN AND ELEVATION
TYPE I & TYPE II**

DRAWN BY KA PO	SCALE 1:30 (A1)
CHECKED BY BF	DATE 2020.07.09
JOB No. A-1914	DWG. NO. NTMCCLHK12A19
	REVISION -

BD'S OFFICAL USE