

1 TYPE A / A-a (LAYOUT PLAN)

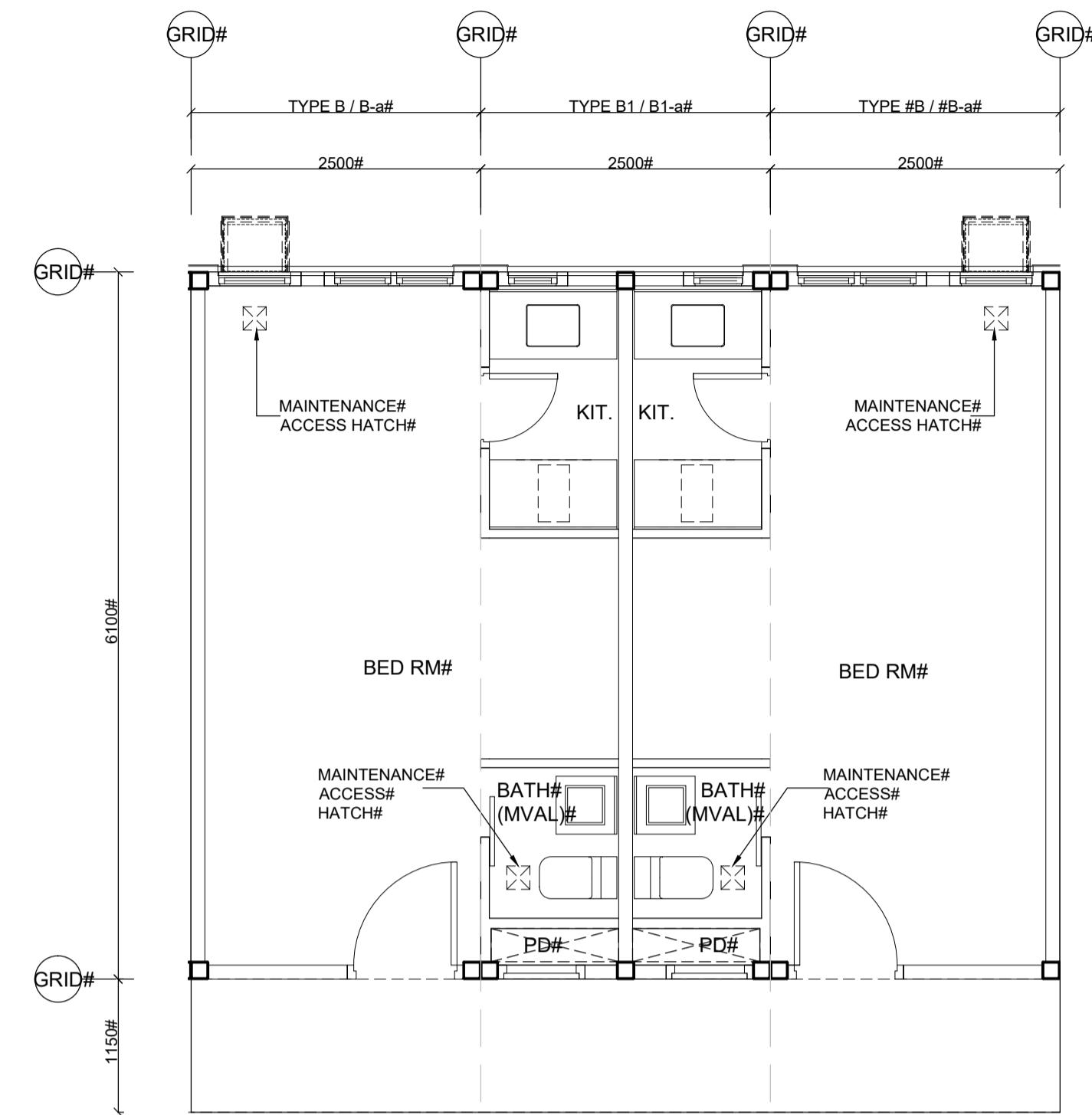

2 TYPE B / B-a, B1 / B1-a, #B / #B-a (LAYOUT PLAN)

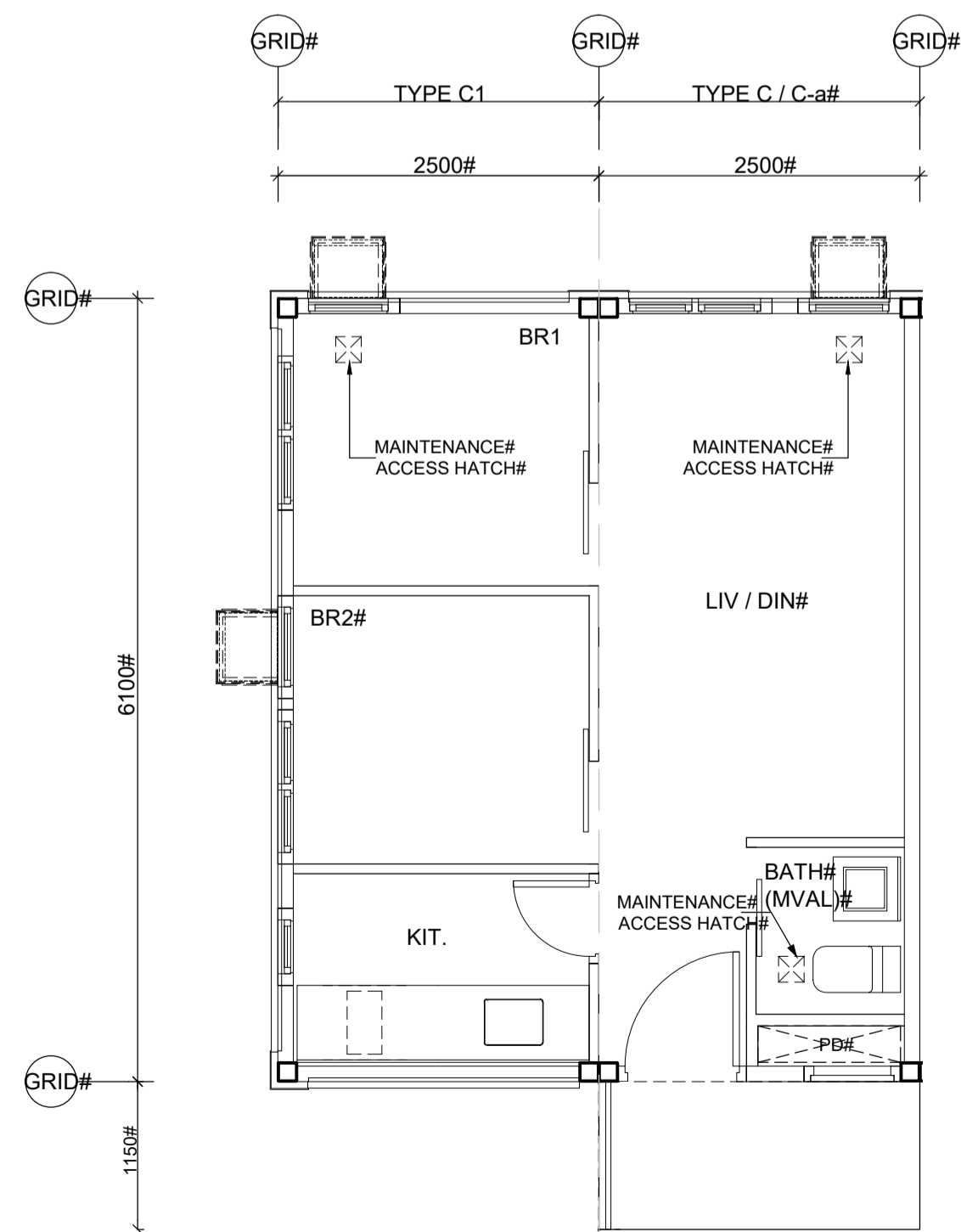

3 TYPE C1, C / C-a (LAYOUT PLAN)

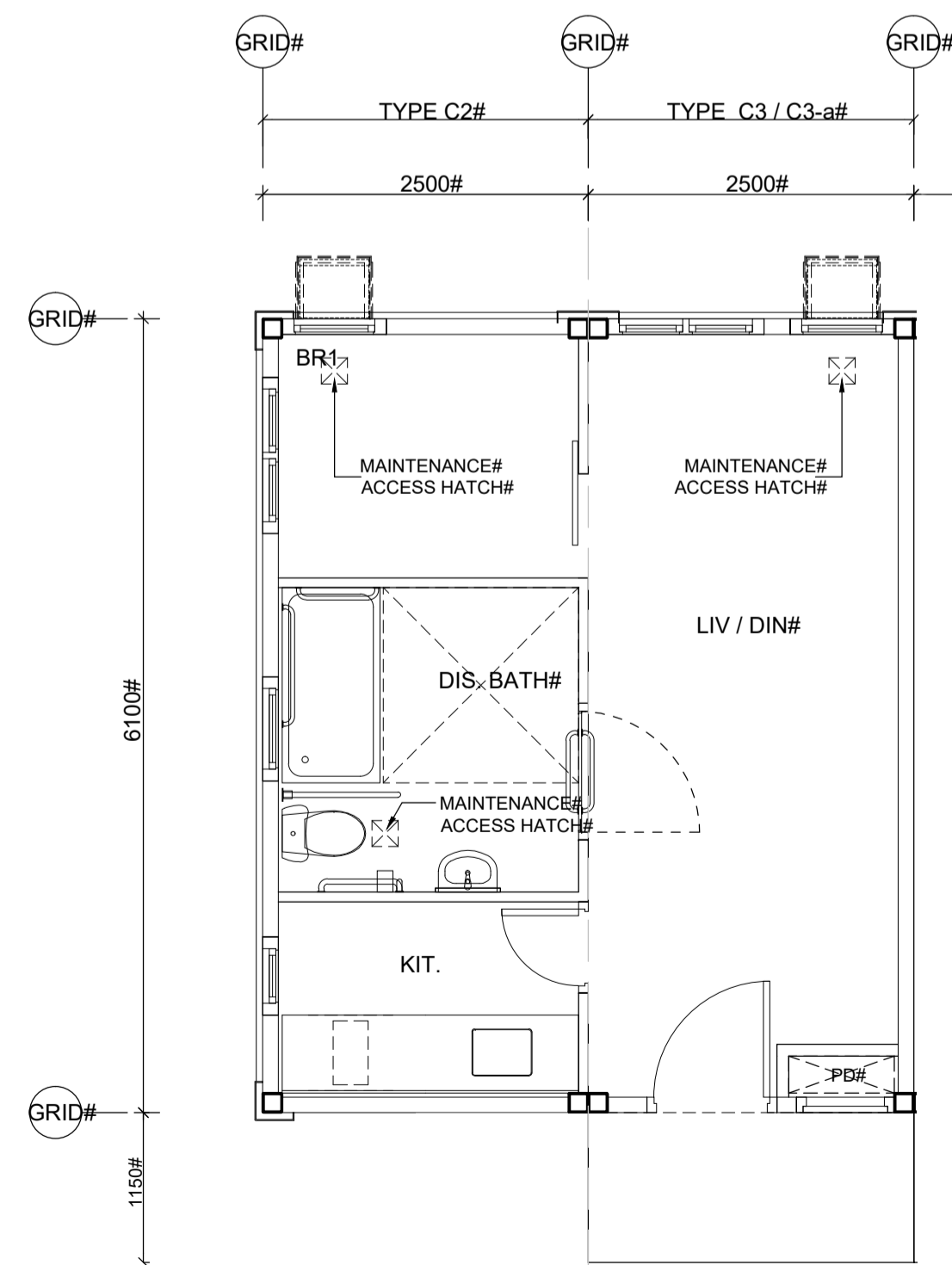

4 TYPE C2, C3 / C3-a (LAYOUT PLAN)

SYSTEM OWNER



11/F, Paul Y. Centre, 51 Hung To Road, Kwun Tong, Kowloon, H.K.
Tel: 2831-8184; Fax: 2372-0114; Email: info@py-imax.com

Structural Engineer#



PROJECT NO. # PY-IMAX-PISCBH001

- This drawing and the contents herein are the copyright of LWK & Partners (HK) Ltd.
- No part of the drawing and the design contained herein may be reproduced without the prior written consent of a director of LWK & Partners (HK) Ltd.
- Do not take measurements directly from this drawing.
- Check and verify all dimensions on site.
- Read this drawing in conjunction with the specifications and all other related drawings.
- Notify the Architect immediately of any discrepancy found herein.

MIC SYSTEM#
PRE-ACCEPTANCE FOR PAULY-IMAX
STEEL COLUMN / BEAM HOSTEL
MODULAR INTEGRATED
CONSTRUCTION (MIC) SYSTEM
(MODEL NO. PISCBH001)

DRAWING TITLE#
TYPICAL MOUDLES PLAN

SCALE# 1:50 (A1)#

DRAWING NO. AM - 01
REV. NO. -

SOURCE#



15/F, North Tower, World Finance Centre, Harbour City, Tsim Sha Tsui, Kowloon.
T: 852-2514 1833 F: 852-2572 6808 E: info@lwk.com
梁黃顯建築師(香港)事務所有限公司
九龍尖沙咀海港城環球金融中心北座15樓

FOR OFFICIAL USE#