

NV_{TC} Compliance Check

NV _c	11%
NV _c (at re-entrant)	37%
NV _{ss}	34%
Overall NV _{TC}	82%

LEGEND :

- ⋯ EXP : External Plane
- ⋯ SWP : Secondary Window Plane
- ⋯ NP : Notional Plane
- Cross Ventilation Path
- Area of habitable spaces with Cross Ventilation outside re-entrant (NV_c)
- Area of habitable spaces with Cross Ventilation at re-entrant (NV_c (at re-entrant))
- Area of habitable spaces with single-sided ventilation (NV_{ss})
- Area of habitable spaces that do not satisfy any requirements of the above
- Area of cross ventilation path across a corridor and/or area of other room(s) (e.g. bathroom / toilet, store) with secondary ventilation opening(s)

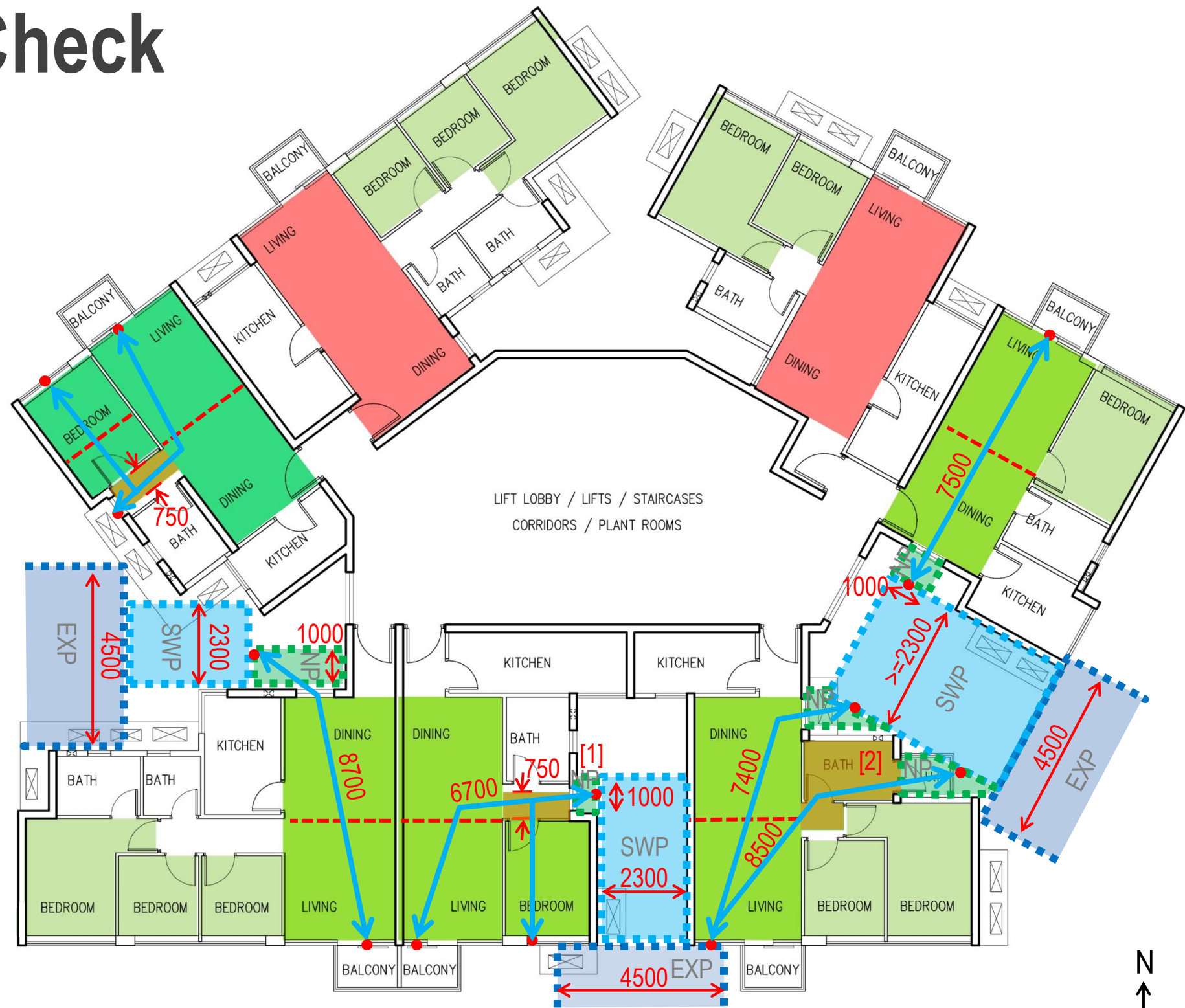

Typical Floor Plan

[1] : The aggregate area of secondary ventilation opening(s) shall meet the sum of the areas required for secondary ventilation opening(s) of the Living & Dining and the adjacent Bedroom.

[2] : Area of cross ventilation path across a corridor and/or area of other room(s) (e.g. bathroom / toilet, store) with secondary ventilation opening(s) shall be taken into account for the calculation of openable window area but shall be excluded from the total area of habitable spaces for NV_{TC} compliance check.

Note 1 : NV_{TC} compliant habitable spaces shall not be affected by heat emission from air-conditioning units of other accommodation laid down in Section 3.4.

Note 2 : The percentage (%) of NV_{TC} compliance is the percentage (%) of area of habitable spaces of NV_c ■, NV_c (at re-entrant) ■ and NV_{ss} ■ over the total area of habitable spaces (■ + ■ + ■ + ■).

SHEET NO. _____
 BD REF. NO. _____
 BUILDING ADDRESS : _____