

MATCH LINE
FOR CONTINUATION.
SEE DRG. No. MTR/RP/805
N 838700

- LEGEND:**
- RAILWAY PROTECTION BOUNDARY (BOUNDARY OF AREA NUMBER 3 OF THE SCHEDULED AREAS)
 - MTR STATION ABOVE GROUND ENTRANCES
 - MTR UNDERGROUND STRUCTURES/TUNNELS
 - MTR VENTILATION SHAFTS
 - MTR ABOVE GROUND STRUCTURES/VIADUCTS
 - LINE DRAINAGE SUMP
 - ABANDONED ACCESS ADIT & SHAFT
 - STRUCTURES LESS THAN 1m BELOW GROUND
 - STRUCTURES 1m TO 3m BELOW GROUND
 - MTR COOLING WATER MAINS
 - DRAINAGE
 - WATER PIPE
 - RAILWAY FENCE
 - TRACK CENTRE LINE

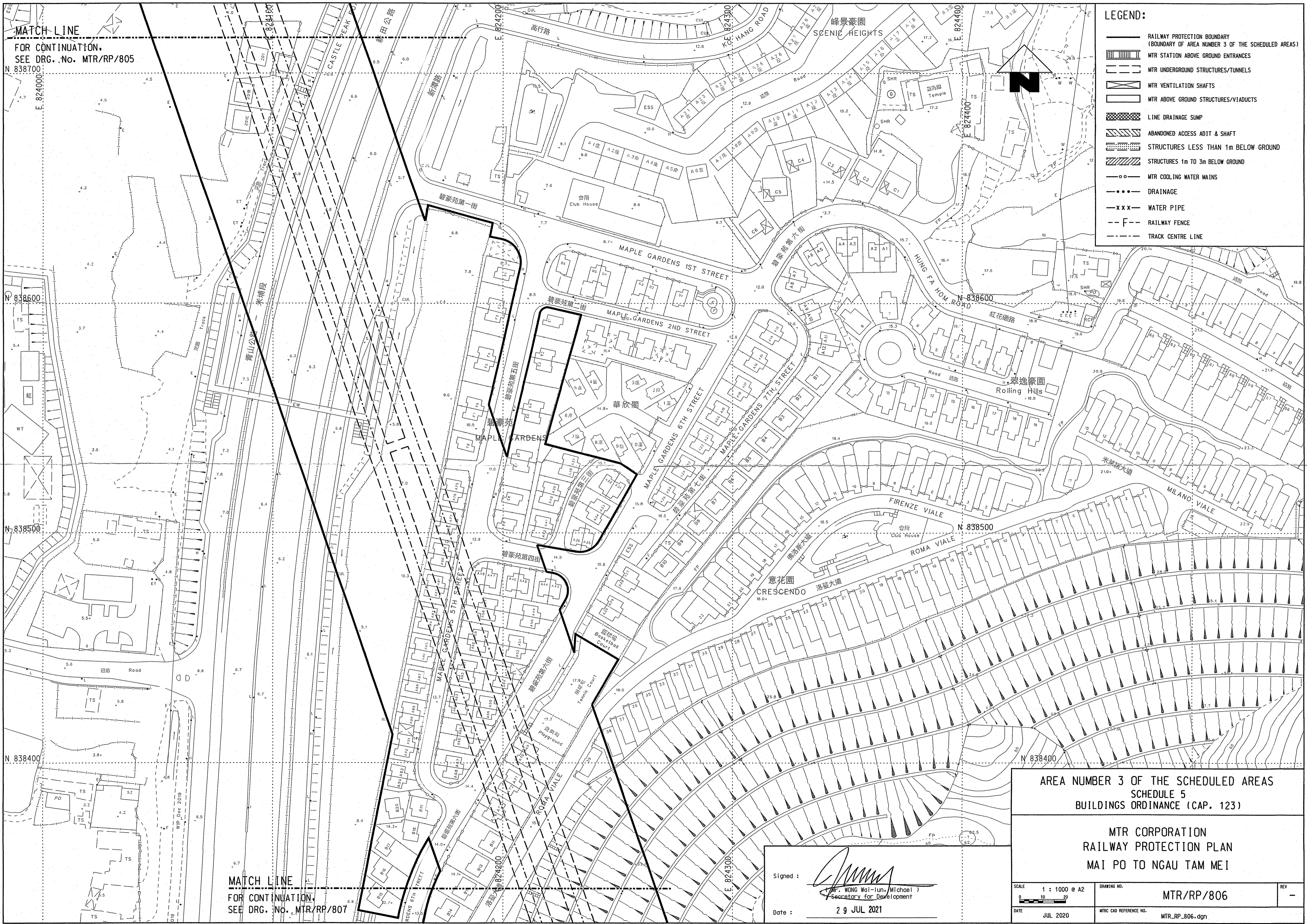

MATCH LINE
FOR CONTINUATION.
SEE DRG. No. MTR/RP/807

Signed:
(Mr. WONG Wai-lun, Michael)
Secretary for Development
Date: 29 JUL 2021

<p>AREA NUMBER 3 OF THE SCHEDULED AREAS SCHEDULE 5 BUILDINGS ORDINANCE (CAP. 123)</p>		
<p>MTR CORPORATION RAILWAY PROTECTION PLAN MAI PO TO NGAU TAM MEI</p>		
<p>SCALE 1 : 1000 @ A2 </p>	<p>DRAWING NO. MTR/RP/806</p>	<p>REV -</p>
<p>DATE JUL 2020</p>	<p>MTR CAD REFERENCE NO. MTR_RP_806.dgn</p>	