

UserWorkspace at:\cadd_apps\mstru\Workspace\Users\example\lctf\UserRef at:\cadd_apps\mstru\Workspace\Projects\pof
 PRINTED BY: A50188 02/06/03 04:21:36 PM
 FILENAME: h:\cadd\w_r_dwg\PRJ-WIDE\Railway Protection\Government\WRRP128.dgn

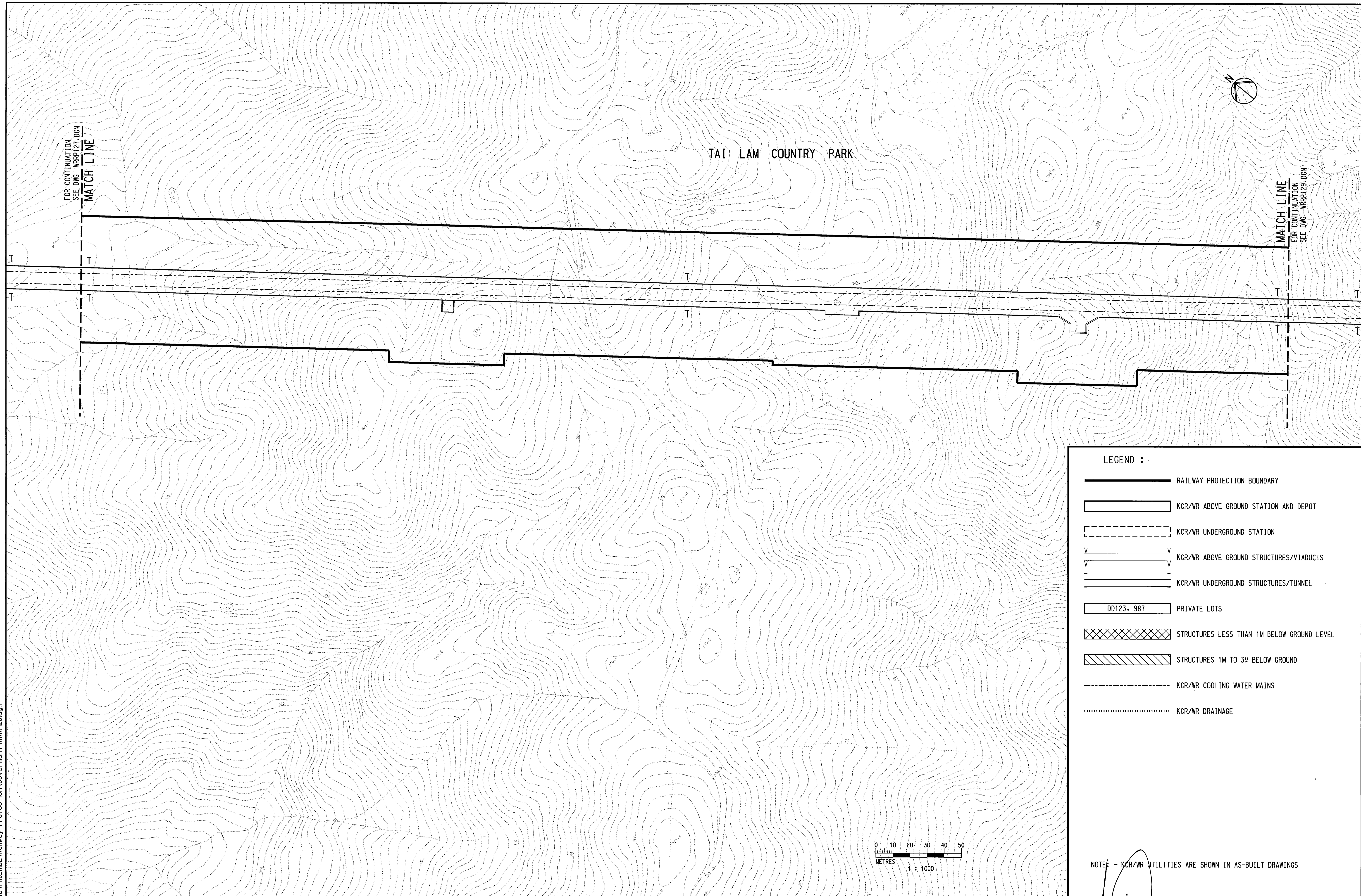

LEGEND :

	RAILWAY PROTECTION BOUNDARY
	KCR/WR ABOVE GROUND STATION AND DEPOT
	KCR/WR UNDERGROUND STATION
	KCR/WR ABOVE GROUND STRUCTURES/VIADUCTS
	KCR/WR UNDERGROUND STRUCTURES/TUNNEL
	PRIVATE LOTS
	STRUCTURES LESS THAN 1M BELOW GROUND LEVEL
	STRUCTURES 1M TO 3M BELOW GROUND
	KCR/WR COOLING WATER MAINS
	KCR/WR DRAINAGE

NOTE: - KCR/WR UTILITIES ARE SHOWN IN AS-BUILT DRAWINGS

REV	DATE	BY	SUB	APP	DESCRIPTION
△	02JUN2003	SN	ADM	LSC	SECOND ISSUE
△	08NOV2002	SN	ADM	LSC	FIRST ISSUE

DESIGNED BY	SN
DRAWN BY	M. K. CHUNG
CHECKED BY	ADM
IN CHARGE	LSC
DATE	



AREA NUMBER 3 OF THE SCHEDULED AREAS
 FIFTH SCHEDULE
 BUILDINGS ORDINANCE (CAP. 123)
 RAILWAY LINES OF THE
 KOWLOON - CANTON RAILWAY CORPORATION
 - WEST RAIL (PHASE 1)
 RAILWAY PROTECTION PLAN

Signed:
 (Michael M Y SUEN)
 Secretary for Housing, Planning and Lands
 Date: 6 JUN 2003



CADD FILE NO	WRRP128-DGN	CADD DATE	29JUL2002
SCALE	1:1000 @ A1		
DRAWING NUMBER	KCR/WR/RP/128		
SHEET NO	28	STAGE CODE	REV 1