

LEGEND :

- RAILWAY PROTECTION BOUNDARY
- KCR/WR ABOVE GROUND STATION AND DEPOT
- KCR/WR UNDERGROUND STATION
- KCR/WR ABOVE GROUND STRUCTURES/VIADUCTS
- KCR/WR UNDERGROUND STRUCTURES/TUNNEL
- DD123, 987 PRIVATE LOTS
- STRUCTURES LESS THAN 1M BELOW GROUND LEVEL
- STRUCTURES 1M TO 3M BELOW GROUND
- KCR/WR COOLING WATER MAINS
- KCR/WR DRAINAGE

NOTE: - KCR/WR UTILITIES ARE SHOWN IN AS-BUILT DRAWINGS

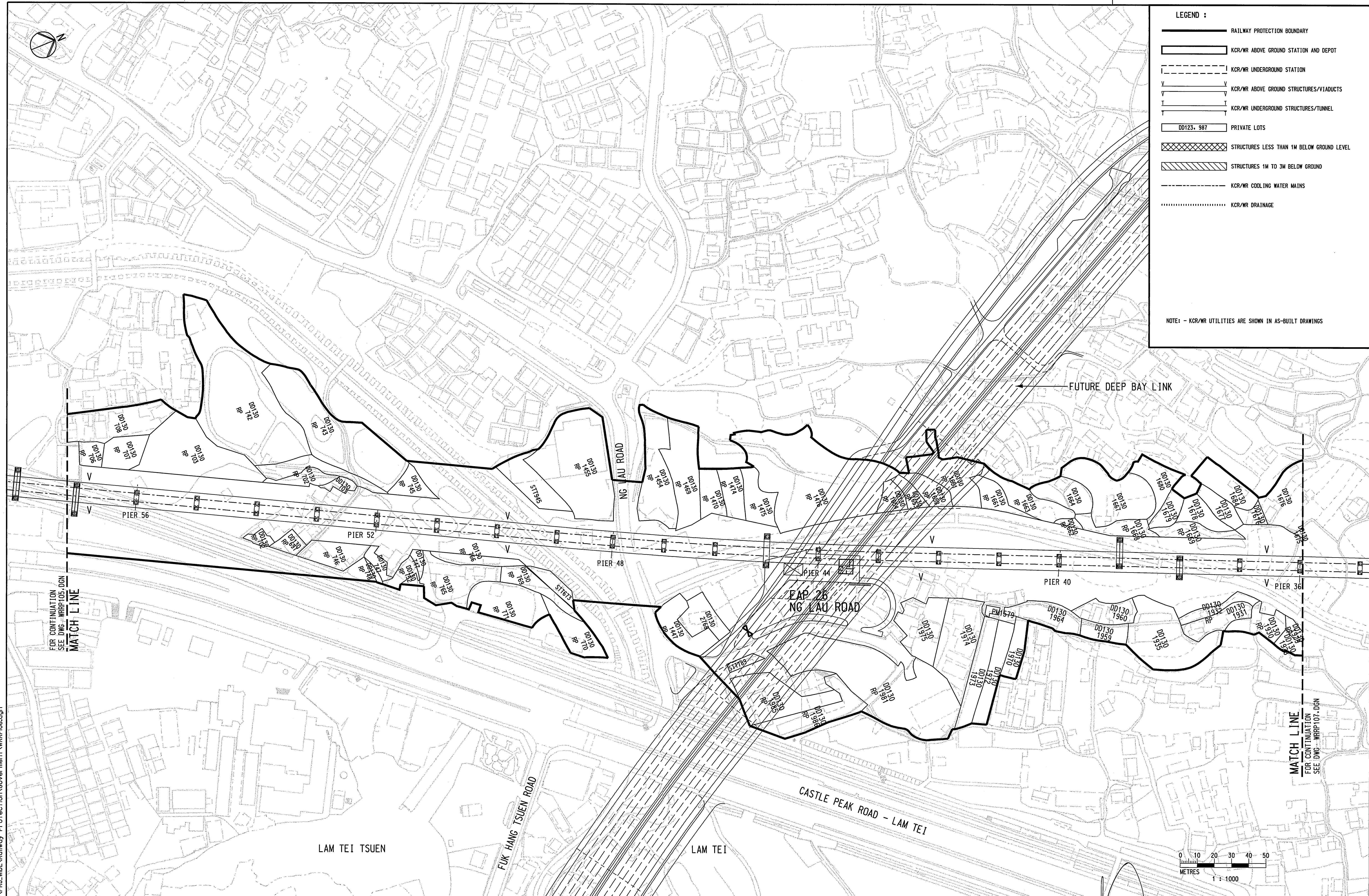

UserWorkspace at \\cadd_apps\mstrnu\workspace\users\example\lucf, UserRef at \\cadd_apps\mstrnu\workspace\projects\p06
 PRINTED BY: A45098 02/06/03 02:04:41PM
 FILENAME: I:\cadd\w_r_dwg\p_rj_wide\Railway Protection\WRRP106.dgn

FOR CONTINUATION
 SEE DWG - WRRP105.DGN
MATCH LINE

MATCH LINE
 FOR CONTINUATION
 SEE DWG - WRRP107.DGN

REV	DATE	BY	SUB	APP	DESCRIPTION
02	JUN 2003	SN	ADM	LSC	SECOND ISSUE
08	NOV 2002	SN	ADM	LSC	FIRST ISSUE

DESIGNED BY
 SN
 DRAWN BY
 M. K. CHUNG
 CHECKED BY
 ADM
 IN CHARGE
 LSC
 DATE

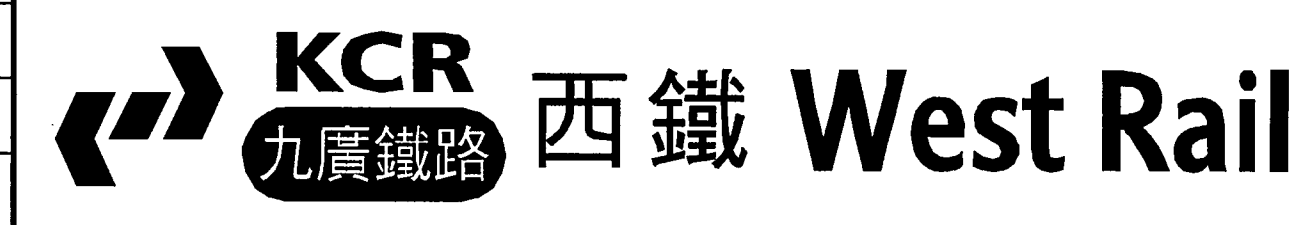

**AREA NUMBER 3 OF THE SCHEDULED AREAS
 FIFTH SCHEDULE
 BUILDINGS ORDINANCE (CAP.123)**
**RAILWAY LINES OF THE
 KOWLOON - CANTON RAILWAY CORPORATION
 - WEST RAIL (PHASE 1)
 RAILWAY PROTECTION PLAN**

Signed:
 (Michael M Y Suen)
 Secretary for Housing, Planning and Lands
 Date: 6 JUN 2003



CADD FILE NO WRRP106.DGN	CADD DATE 29JUL2002
SCALE 1:1000 @ A1	DRAWING NUMBER KCR/WR/RP/106
SHEET NO 6	STAGE CODE REV 1