

RECEIVED BY OFFICE
 REV. NO. 2/4026/74

M 1093445

九龍公園徑

北京道 PEKING ROAD

ASHLEY ROAD (40'-0" WIDE) 亞士厘道

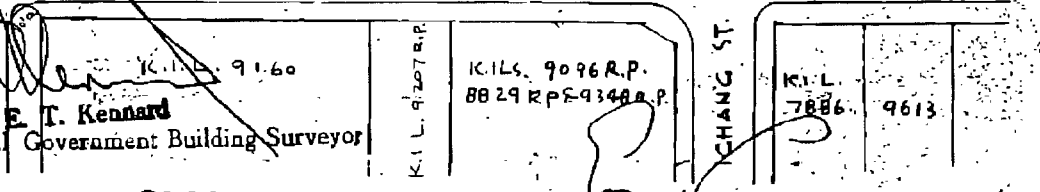
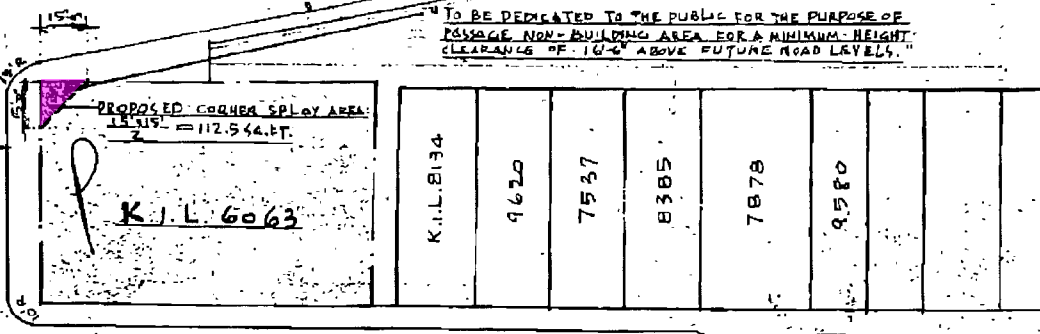

RECEIVED BY
 Acting
 JUN 4 11 38 74

E. T. Kennard
 Principal Government Building Surveyor

BLOCK PLAN

SCALE: 50'-0" = 1'-0"

ERIC CUMINE ASSOCIATES
 ARCHITECTS, ENGINEERS & SURVEYORS

JUN 10 1974

M. 1093445

Yue Hwa International Building,
 1 Kowloon Park Drive, Kowloon
 裕華國際大廈, 九龍公園徑1號