

529-543 Hennessy Road &  
524-540 Lockhart Road

軒尼詩道529 - 543號 及 駱克道524-540號

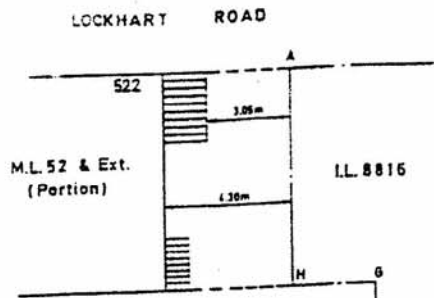

sd.  
(Darwin CHEN)  
Director of Buildings  
and Lands

Diagram 'A' (NOT TO SCALE)

SIDE	DISTANCE IN METRES	BEARING	Pt.	CORNER MARKED BY
A B	41.62	87 43 10		
B C	19.66	177 44 10		
C D	0.66	87 39 00		
D E	16.78	177 35 30		
E F	39.62	287 38 10		
F G	19.82	357 35 30		
G H	2.65	287 39 00		
H A	16.67	357 44 10		

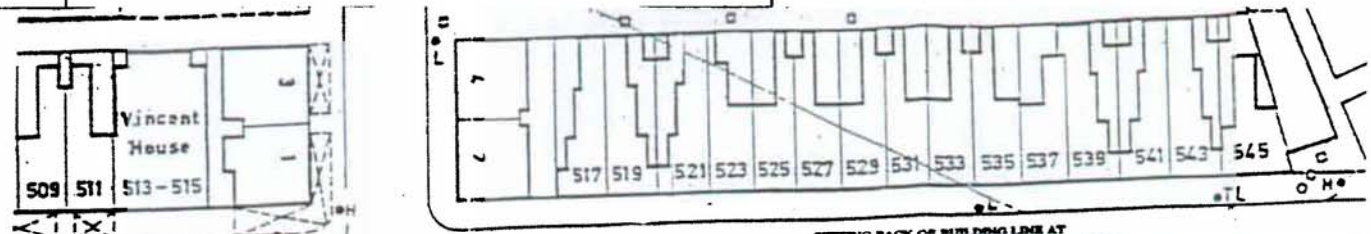

Lockhart Road  
駱克道

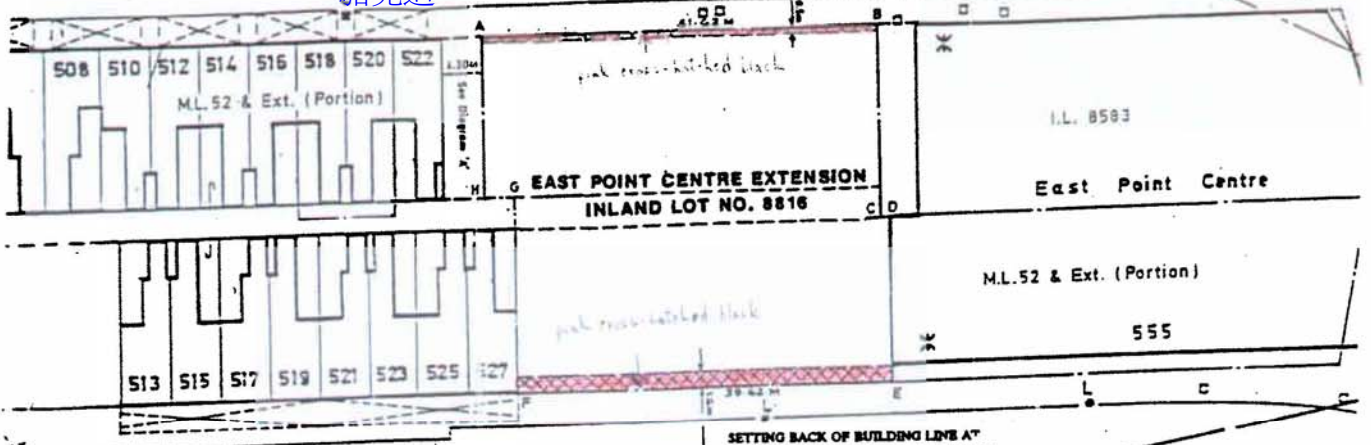

Hennessy Road  
軒尼詩道

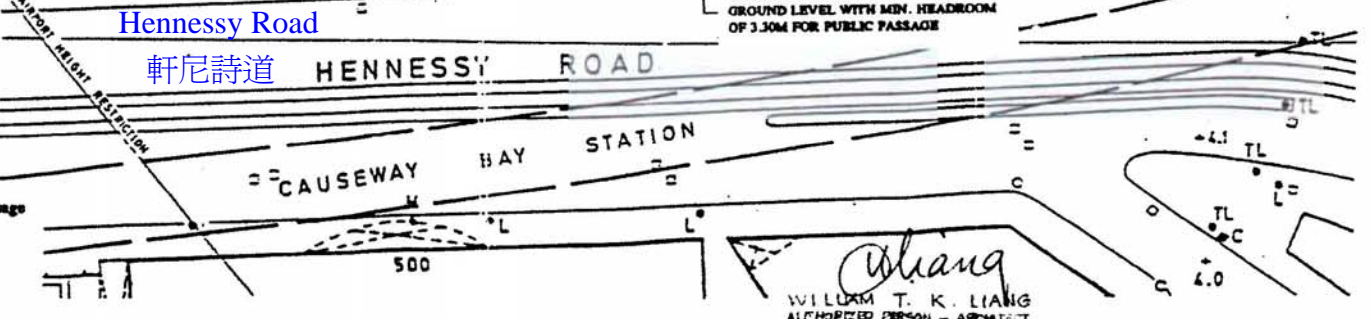

Area at Ground Floor dedicated to the public for the purpose of passage  
(shown coloured pink cross-hatched black)

A. Hennessy Road 1.60m x 39.62m ..... = 63.392m<sup>2</sup>

B. Lockhart Road 0.5m x 41.62m ..... = 20.810m<sup>2</sup>

Total Dedicated Area ..... = 84.202m<sup>2</sup>

Annexure to Memorial No. 5590950

WILLIAM T. K. LIANG  
AUTHORIZED PERSON - ARCHITECT  
for and on behalf of  
LIANG PEDDLE THORP  
Architects & Planners Ltd.

**PLAN FOR DEED OF DEDICATION FOR PUBLIC PASSAGE  
UNDER BUILDING (PLANNING) REGULATION 22 (1)  
EAST POINT CENTRE EXTENSION  
INLAND LOT NO. 8816**

SIGNED and SEALED for and on  
behalf of Eastlord Development  
Limited

**LIANG PEDDLE THORP** 梁柏濤  
Architects and Planners Ltd  
21st Floor Beverly House 93-107 Lockhart Road Wanchai Hong Kong  
Fax 529 6419 Telephone 861 1728



UBM5590950 (1/1)