

2-22 East Point Road and 1-5 Great George Street, Hong Kong
 香港東角道 2-22 號及記利佐治街 1-5 號

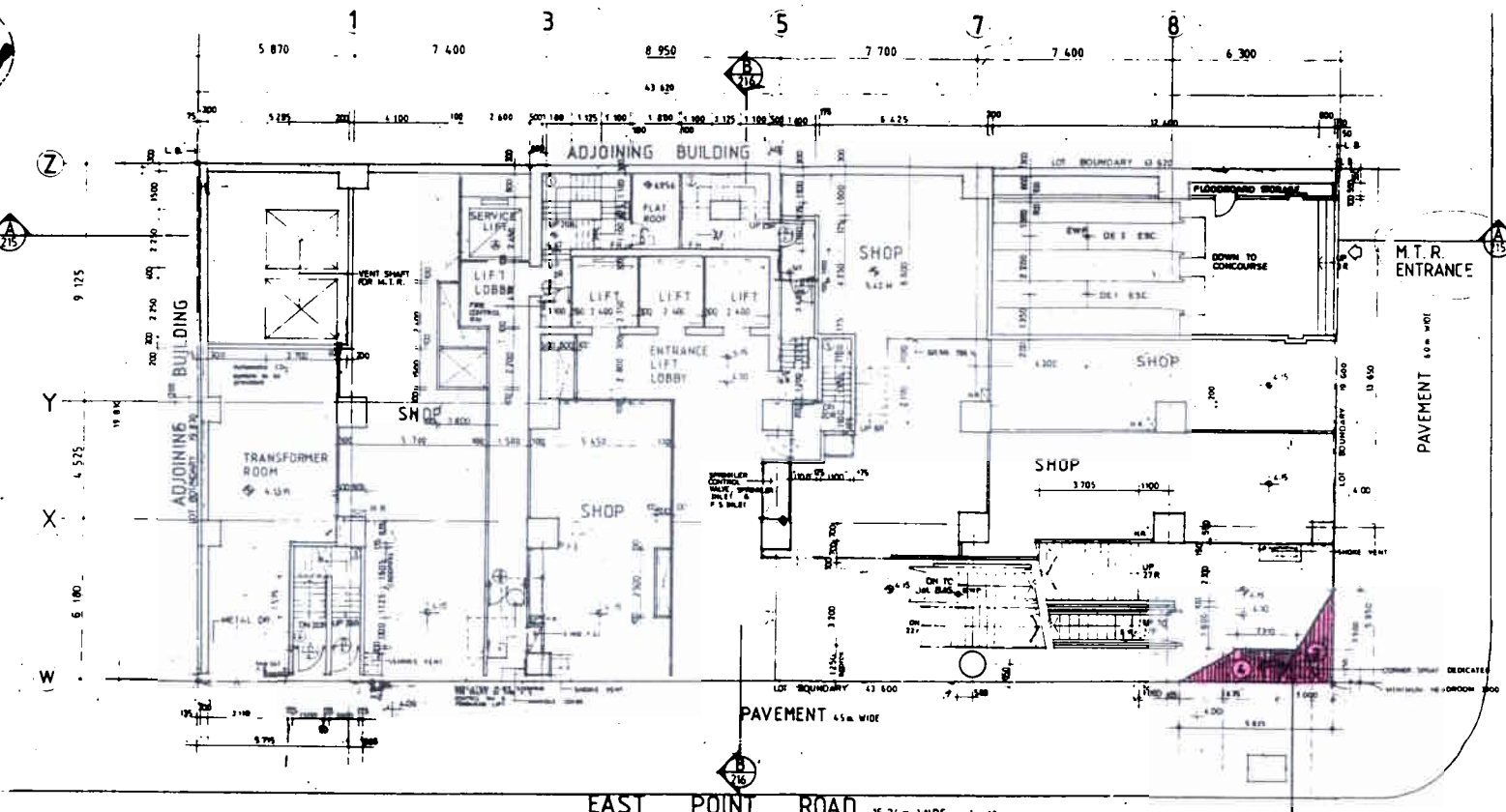

East Point Road 東角道

GROUND FLOOR PLAN

AUTOMATIC SPRINKLER SYSTEM TO BE PROVIDED
 U.P.A. 31.65.5M

- ① 2M X 2.5M X 0.5 = 2.5M²
- ② (2.21M + 3.875M) X 1.25M X 0.5 = 3.84M²
- 7.34 M²**

NOTE: THE SHADED AREA TO BE DEDICATED FOR M.T.R. USE

THE SHADED AREAS ARE AREAS TO BE DEDICATED FOR M.T.R. PURPOSES, WHICH ARE NOT TO BE CONSIDERED AS PART OF THE BUILDING'S STRUCTURAL ELEMENTS. PROVISIONS OF THE BUILDING'S ORDINANCE ABOVE ARE EXEMPTED FROM THE PROVISIONS OF THE BUILDING'S ORDINANCE

RECEIVED BY
 MAY 18 11 07 '84
 R & I Section, EOO
 Building Development
 Department

For and on behalf of
 Winning Properties Ltd.

[Handwritten signature]

For and on behalf of
 Winning Lands Ltd.

[Handwritten signature]

Signed by *[Handwritten signature]*
 as Attorney and Agents for and on behalf of the Hongkong and Shanghai Banking Corporation Limited, the Proprietors of the Building and the Building under its Common Seal *dd 31/2/83*

[Handwritten signature]
 CHAU Cham-son
 Director of Building Development