

K.T.I.L. NO.653 AT  
 370 KWUN TONG ROAD  
 KOWLOON, HONG KONG

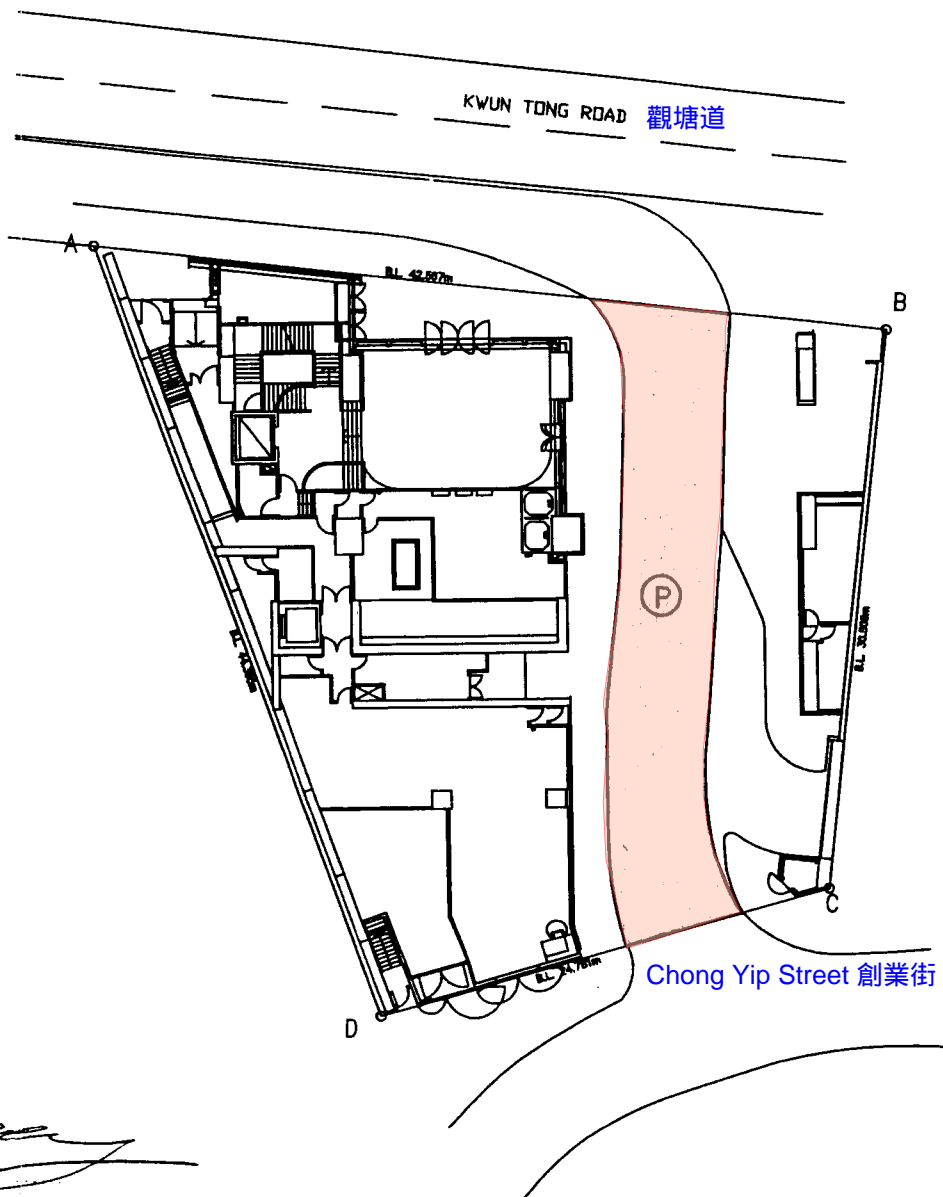

Chiang Hong Michael  
 BA (A.S.) B. Arch. R.I.B.A. R.I.E.A.  
 Authorised Person, Architect

GROUND FLOOR PLAN  
 Millennium City 3, 370 Kwun Tong Road, Kowloon  
 創紀之城3, 觀塘道370號

LEGEND:



COLOR PINK  
 (LINK ROAD)  
 DEDICATION FOR PUBLIC USE  
 AREA = 190.9435 m<sup>2</sup>  
 HEADROOM = 5.5M

BUILDINGS DEPARTMENT  
 R & D Section

<p><b>MCAL</b>  <b>Michael Chiang &amp; Associates Ltd.</b>          RM 2803, 148 ELECTRIC ROAD, NORTH POINT, HONG KONG.          TEL (852) 29601308 · FAX (852) 2590 8672</p>	<p>PROJECT: 370 KWUN TONG ROAD, KOWLOON.          K.T.I.L. 653</p>	<p>scale N.T.S.</p>	<p>drawn ws</p>	<p>JOB NO 960502</p>	<p>DWG NO DP-01</p>	
	<p>DRAWING TITLE DEDICATION PLAN</p>	<p>date 26- SEP-02</p>	<p>checked BEN</p>	<p>approved BEN</p>	<p>rev. -</p>	<p>COMPUTER REF. 00p104(k).dwg</p>