

IN I.L. 4063, 4064 & 4065  
 AT NOS. 69 - 73 HIGH STREET H.K.

①  
 SETZ

B.L.D. REF : BLD(B) 2/2051/82



Annexure to Memorial No. **3983164**

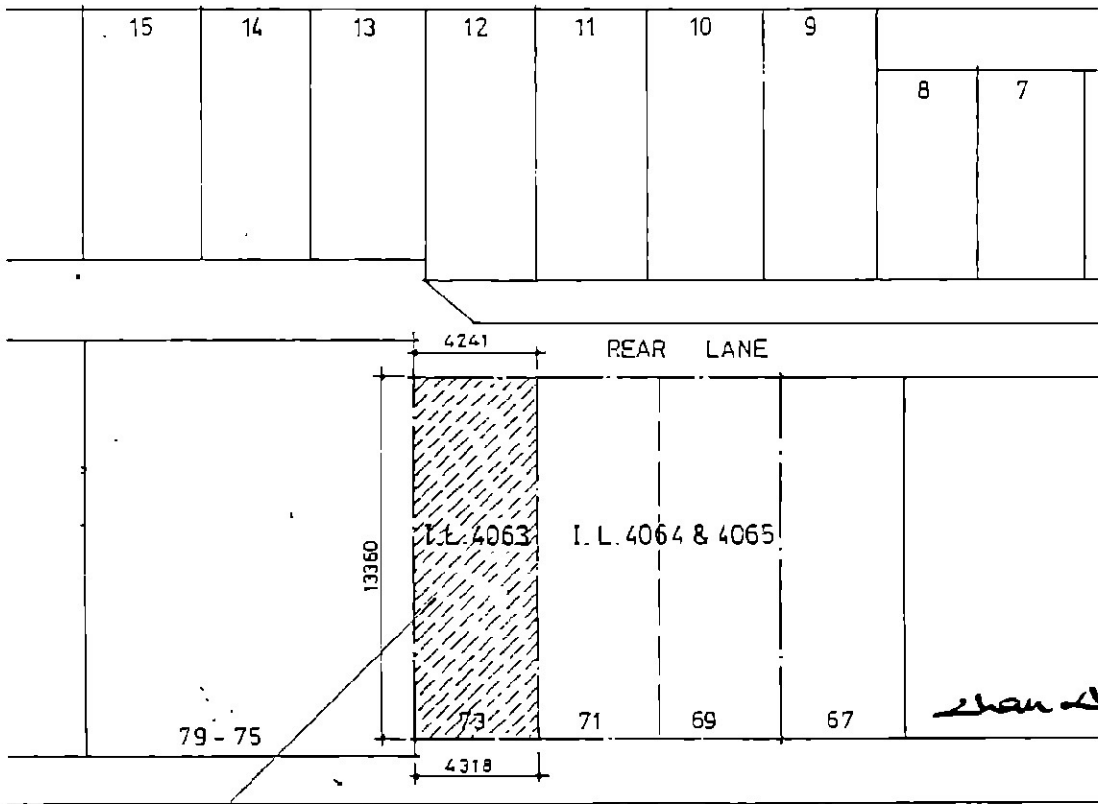

*Chan Chan Su*

高街 HIGH STREET

**BLOCK PLAN**

SCALE 1 : 250

Hatched area to be dedicated to the Government as pedestrian way and conform with Town Planning Draft Sai Ying Pun and Sheung Wan Outline Zoning Plan No. S/H 3/4 and will be paved and landscaped to the satisfaction of the Government at Owner's cost. Area to be dedicated (from Lease Inland Lot 4063 617 S.F. or 57.32 S.M.)

69 High Street  
 高街 69號