



UBM1626146 (2/1)

"B"

CHU KING DEVELOPMENT COMPANY LIMITED

*[Handwritten Signature]*  
Director

# INLAND LOT NOS 3782 & 3783

SCALE = 1:600

香港菲林明道20號及謝斐道158號-172號

20 Fleming Road & 158-172 Jaffe Road, HK

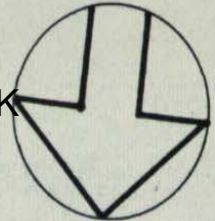

**TUNG WAH GROUP OF HOSPITALS**  
*[Signature]*  
Chairman,  
Board of Directors

*[Signature]*  
Vice Chairman  
*[Signature]*

*[Signature]*  
D.W. [Signature]

駱克道

LOCKHART

ROAD

菲林明道

ROAD

RAMP

FLEMING

FLYOVER

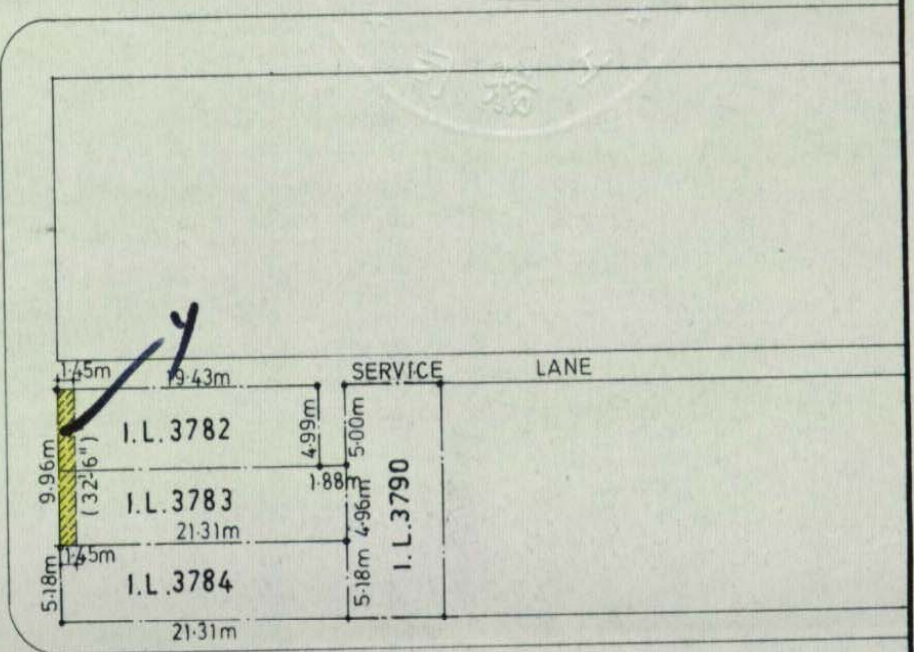

JAFFE

ROAD

謝斐道

HATCHED AREA (1.45m X 9.96m) = 14.44m<sup>2</sup>  
TO BE DEDICATED TO PUBLIC FOR THE PURPOSE OF PASSAGE

M.1626146

"A"



UBM1626146 (1/1)

CHIU KING DEVELOPMENT COMPANY LIMITED

*[Handwritten signature]*  
Director

# INLAND LOT No 3784

SCALE = 1:600

香港謝斐道158號-172號及菲林明道20號

158-172 Jaffe Road & 20 Fleming Road, HK

TUNG WAH GROUP OF HOSPITALS

*[Handwritten signature]*  
Chairman,  
Board of Directors

*[Handwritten signature]*  
Vice Chairman

*[Handwritten signature]*  
D.W. McDonald



駱克道 LOCKHART ROAD

菲林明道

ROAD

FLEMING

RAMP

FLYOVER

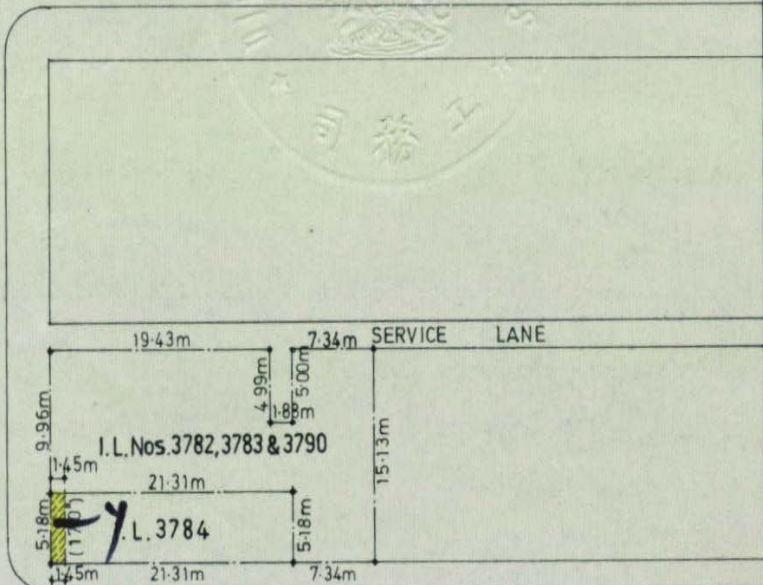

I.L. Nos. 3782, 3783 & 3790

L. 3784

SERVICE LANE

JAFFE ROAD 謝斐道

HATCHED AREA (1.45m X 5.18m) = 7.51m<sup>2</sup>  
TO BE DEDICATED TO PUBLIC FOR THE PURPOSE OF PASSAGE

M. 1626146