

PLAN SHOWING AREA TO BE DEDICATED  
FOR THE PUBLIC AT R.P.I.L. 2820  
18 FENWICK STREET SCALE 1:500

41



GLOUCESTER ROAD 告士打道

分域街

FENWICK STREET

3.6  
+

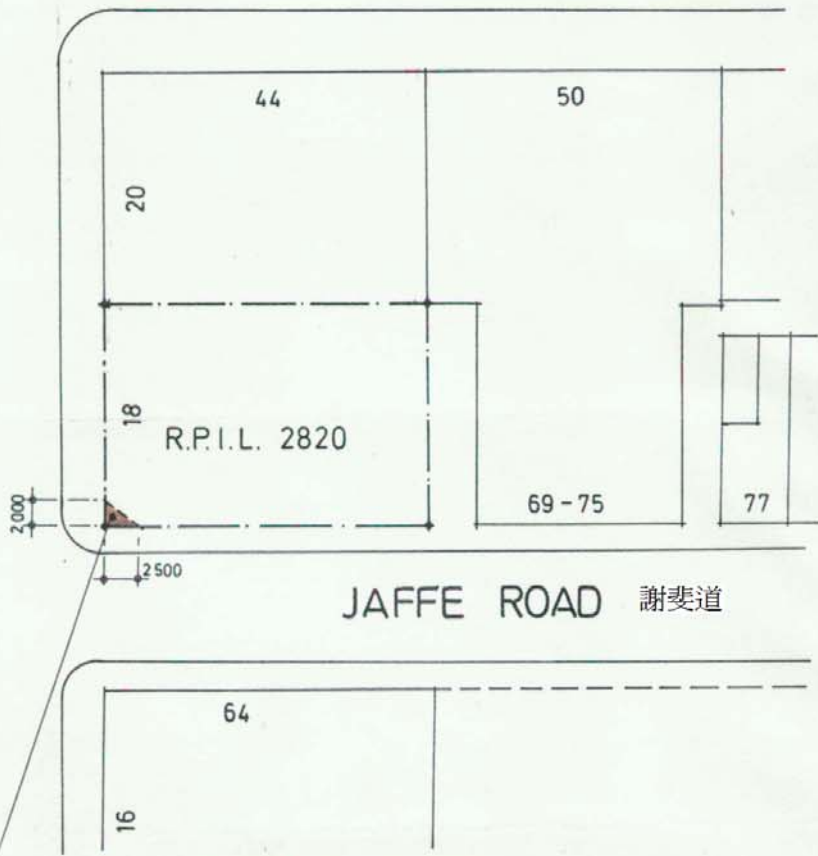

AREA TO BE DEDICATED TO THE PUBLIC  
 FOR PURPOSE OF PASSAGE  
 (MINIMUM VERTICAL HEIGHT CLEARANCE  
 TO BE OF 5.5 M)

Signed and Sealed  
 For and on behalf of  
 Trisight Ltd.

Sd. For and on behalf of  
 The Hongkong and Shanghai  
 Banking Corporation

Sd. A.W. Samson  
 p. Director of Buildings  
 and Lands

Annexure to Memorial No. 4121966

香港告士打道42-46號及分域街18號  
 42-46 Gloucester Road & 18 Fenwick Street, HK

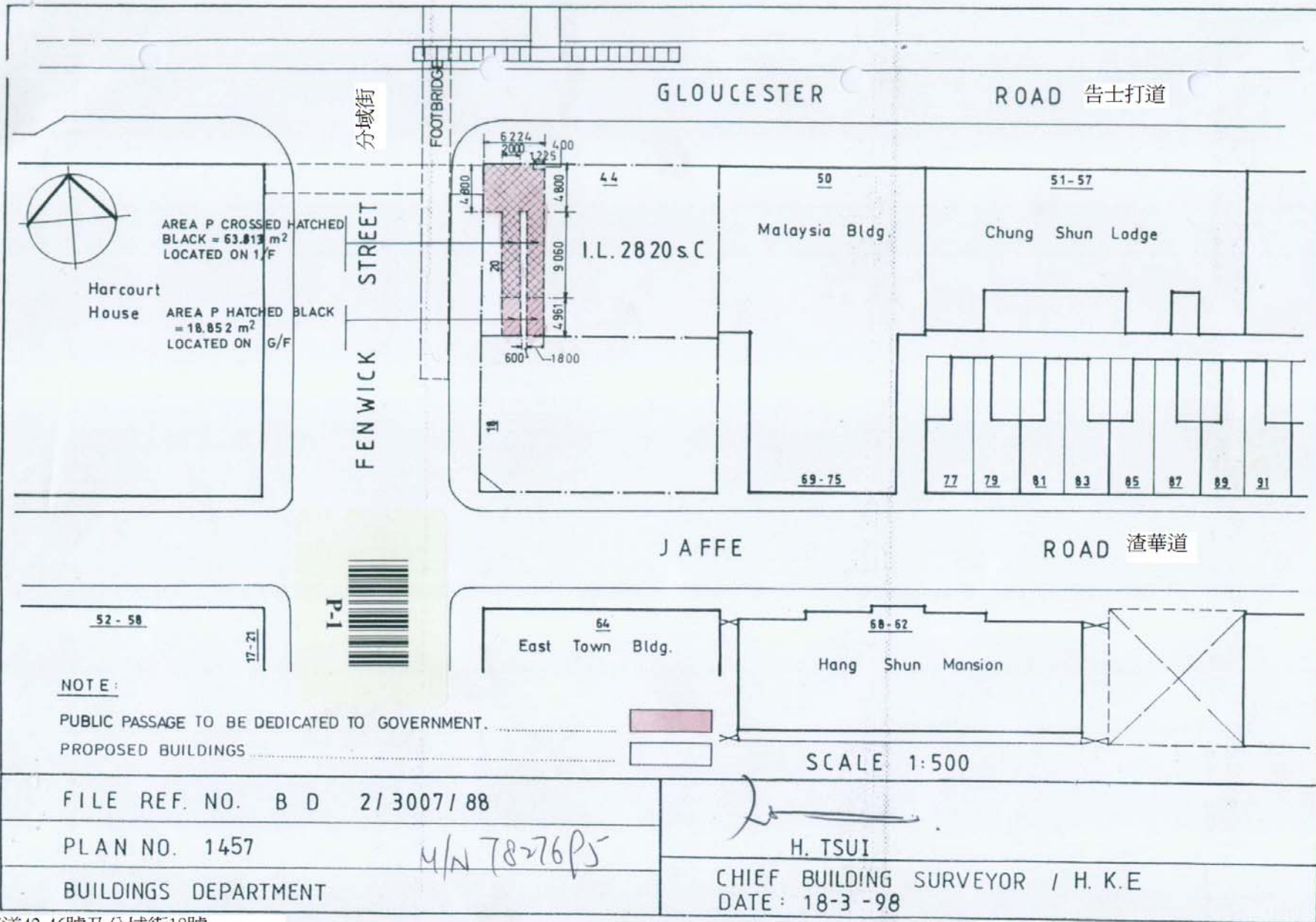

香港告士打道42-46號及分域街18號  
 42-46 Gloucester Road & 18 Fenwick Street, HK



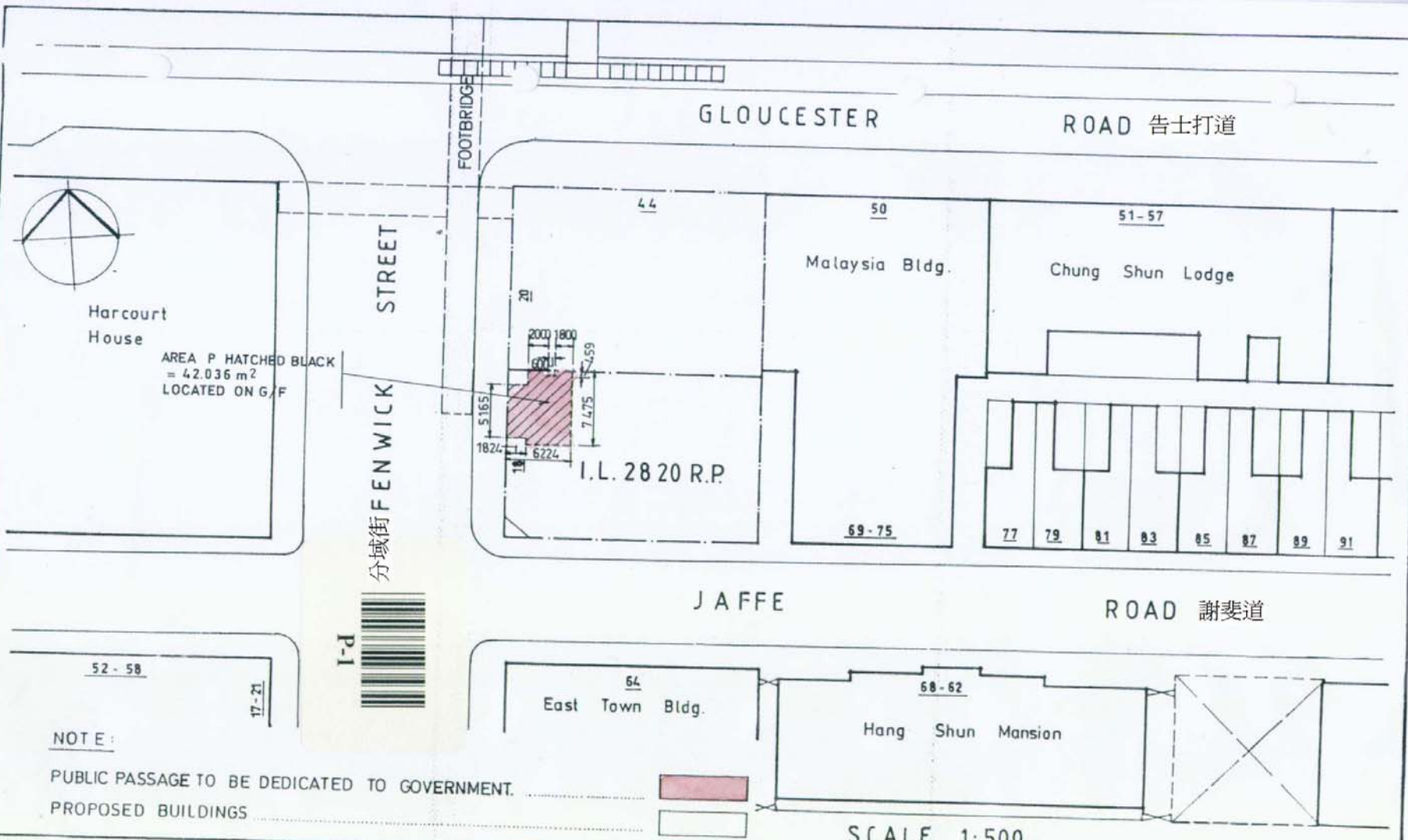

Harcourt House

AREA P HATCHED BLACK  
= 42.036 m<sup>2</sup>  
LOCATED ON G/F

STREET  
分域街 FENWICK STREET

GLOUCESTER ROAD 告士打道

JAFFE ROAD 謝斐道

44

50

51-57

Malaysia Bldg.

Chung Shun Lodge

I.L. 28 20 R.P.

69-75

77

79

81

83

85

87

89

91

52-58

17-21

54 East Town Bldg.

68-62

Hang Shun Mansion

NOTE:  
PUBLIC PASSAGE TO BE DEDICATED TO GOVERNMENT.  
PROPOSED BUILDINGS

SCALE 1:500

FILE REF. NO. B D 2/3007/188

PLAN NO. 1458

BUILDINGS DEPARTMENT

M/N 7827693

H. TSUI

CHIEF BUILDING SURVEYOR / H. K. E.  
DATE: 18-3-98

香港告士打道42-46號及分域街18號  
42-46 Gloucester Road & 18 Fenwick Street, HK

UBM7827693 (1/1)